

Memorandum



To: Alex Smith, Director, Art Commission
From: Nobuki Iijima, Project Coordinator, Capital Program Office
Date: March 4, 2025
Re: Request for Administrative Approval / Art Commission Review
Waterview Recreation Center, 5826 McMahan St., Philadelphia PA 19144

We respectfully request administrative approval for Playground improvements at Waterview Recreation Center, 5826 McMahan St., Philadelphia, PA 19144.

The brief description of the project as stated below and the enclosed drawings show the intended extent of work.

This project includes the removal of existing playground equipment and existing pavement on slope and around existing trees, and installation of new playground/fitness equipment, safety surface and benches on the same footprint of existing playground areas. Project budget is \$750,000 which is funded by the Councilwoman Cindy Bass.

Thank you for your attention. Please inform me directly if you need more information.

cc: Aparna Palantino, Deputy Commissioner, PPR
Francesco Cerrai, Project Director
Nobuki Iijima, Project Coordinator, nobuki.ijima@phila.gov or (215) 683-4486



WATERVIEW RECREATION CENTER

5826 MCMAHON STREET



**PHILADELPHIA
PARKS & RECREATION**

MARCH 2025

SITE CONTEXT

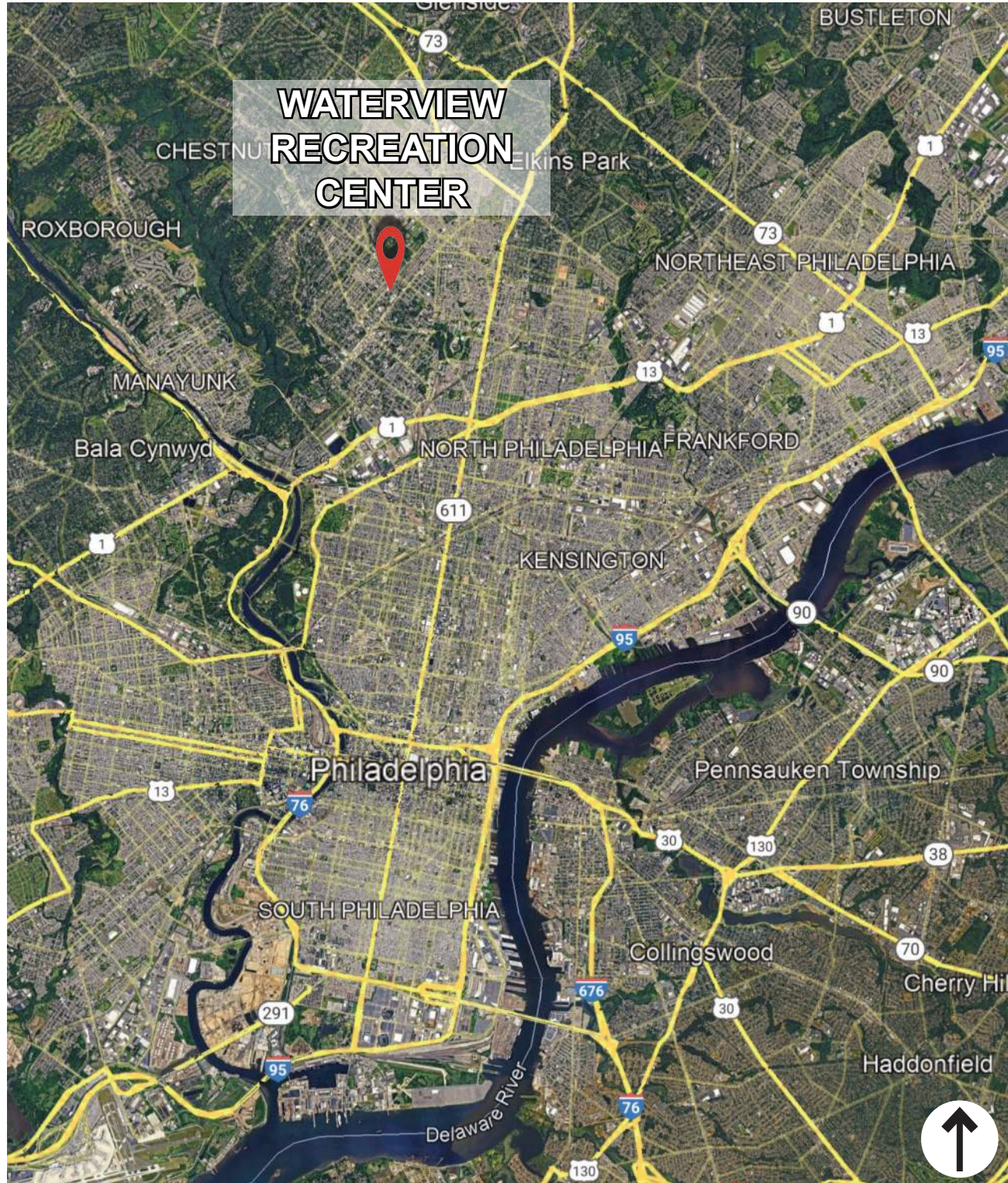

WATERVIEW WITHIN PHILADELPHIA



PLAYGROUND CONTEXT

EXISTING PLAYGROUND EQUIPMENT CONDITIONS



EXISTING CONDITIONS AND DEMOLITION PLAN



PROPOSED SITE PLAN

EXISTING ENTRANCE GATE
 PROPOSED PLANTING BED EXPANSION
 EXISTING ENTRANCE GATE

PROPOSED BACKED BENCHES, TYPICAL
 PROPOSED 2-5 STRUCTURE
 PROPOSED WHEELCHAIR-ACCESSIBLE TABLE
 PROPOSED TABLE
 PROPOSED BACKLESS BENCHES, TYPICAL
 SWINGS WITH ACCESSIBLE, BELT AND BUCKET SEATS
 REPAIRED AND PROPOSED ASPHALT
 EXISTING BASKETBALL FENCE TO REMAIN
 TREE PITS COMBINED INTO ONE PLANTING BED
 PROPOSED BACKLESS BENCHES, TYPICAL
 PROPOSED FITNESS EQUIPMENT
 EXISTING TREES, TYPICAL

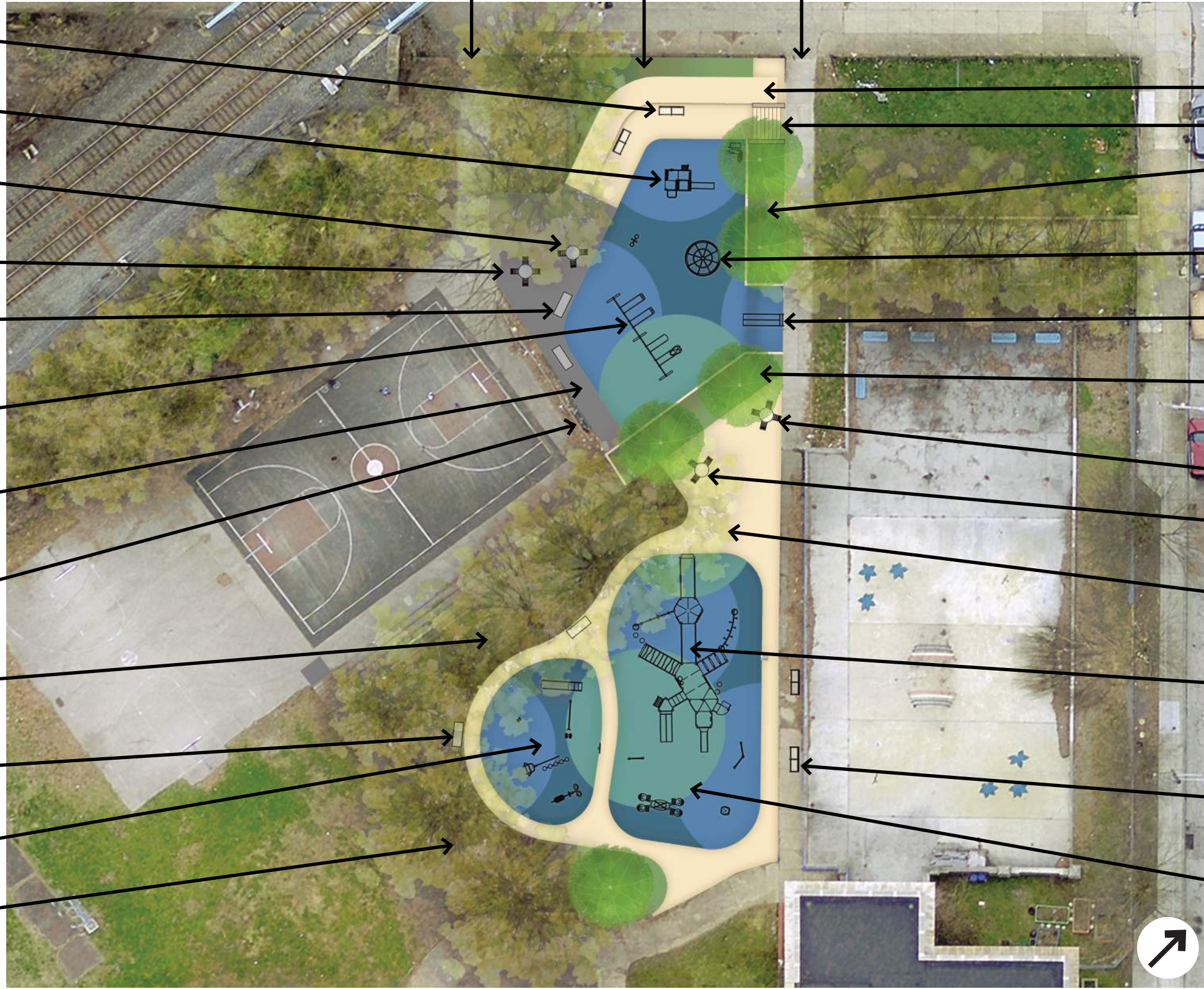

PROPOSED RAMP
 PROPOSED STAIRS
 PROPOSED PLANTING BED WITH TREES ON SLOPE, TYPICAL
 WHEELCHAIR ACCESSIBLE WE-GO-ROUND
 PROPOSED SLIDE ON SLOPE
 PROPOSED SLOPED PLANTING BED WITH TREES
 PROPOSED TABLE
 PROPOSED WHEELCHAIR ACCESSIBLE TABLE
 REPAIRED AND PROPOSED CONCRETE, TYPICAL
 PROPOSED 5-12 PLAY STRUCTURE WITH WHEELCHAIR ACCESS RAMP
 PROPOSED BACKED BENCH, TYPICAL
 PROPOSED SAFETY SURFACING, TYPICAL



PROPOSED PLAY EQUIPMENT: 2-5 AREA

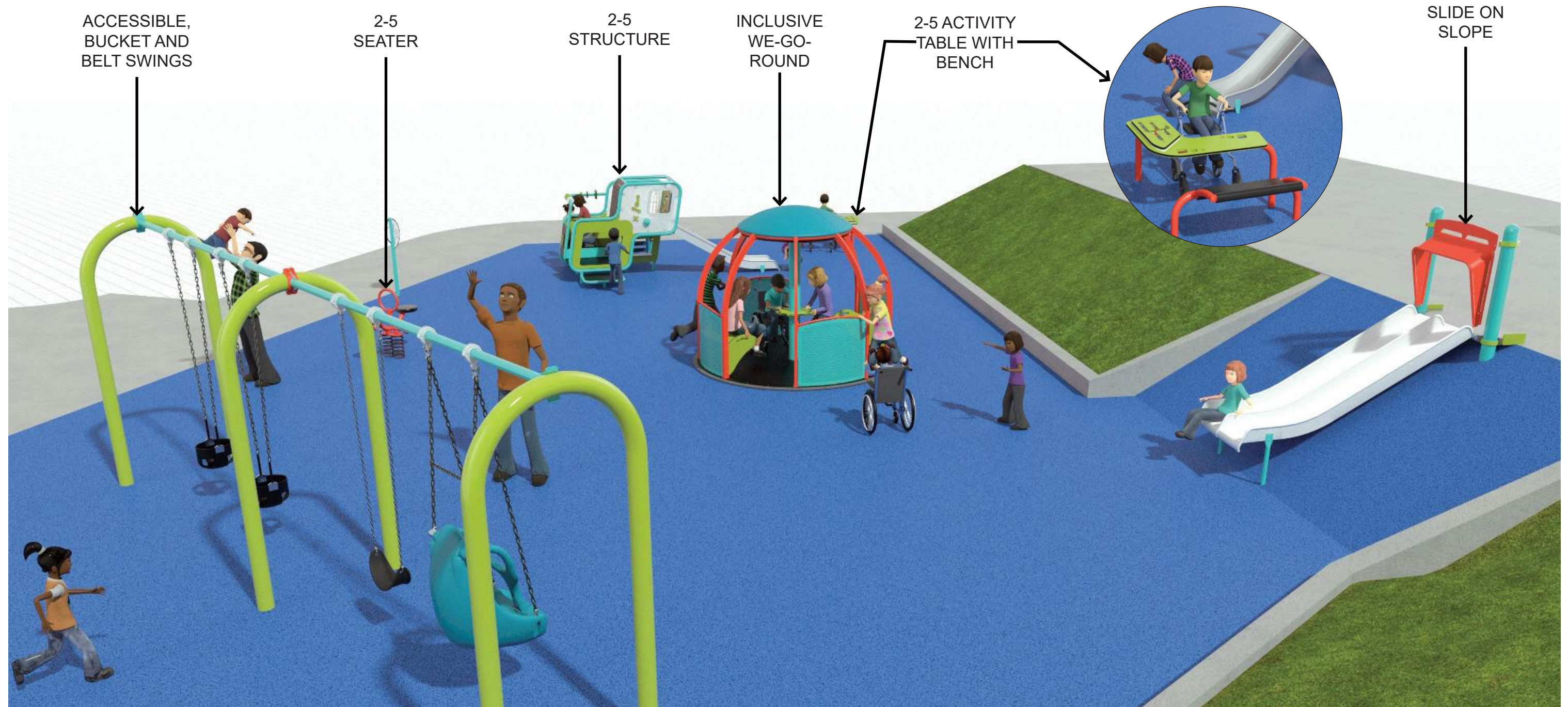

PROPOSED PLAY EQUIPMENT: 5-12 AREA



PROPOSED FURNISHINGS



TABLES: 3 AND 4 SEAT VERSIONS OF DUMOR 176 IN BLACK WITH PLASTIC LUMBER



TRASH RECEPTACLES: DUMOR 157 IN BLACK



BENCHES: DUMOR 160 IN BLACK WITH "FAIRMOUNT PANEL" CENTER ARMREST

Waterview Recreation Center

Art Commission Response to questions for Administrative Approval

1. Lighting details: existing and any new proposed
 - a. There are existing lights to remain, and no new lights proposed. Existing lights have been added to the existing site plan in the presentation.
2. Tree Details: Confirmation that one diseased tree is the only tree to be removed; photo of diseased tree, and total number and species of new tree plantings
 - a. There is only one tree that is to be removed, shown below. As you can see from the photo, taken in September of 2024, this tree displays signs of early leaf drop indicative of disease, compared to the full canopies of the other trees on the site. We are proposing 5 new trees, with 4 Red Maples (*Acer rubrum*) and 1 Serviceberry (*Amelanchier canadensis*).



Figure 1: Diseased tree to be removed outlined.

3. Stormwater/drainage details
 - a. We are proposing a new underground stone basin for the lower playground area.
4. Fencing
 - a. Approximately 267 linear feet of 4' high chainlink fence is to be removed, and is now reflected on the existing conditions and demolition plan in the presentation. Previously, this fencing was utilized to encompass play areas & separate uses. Due to the implementation of planting beds in these same areas, fencing is no longer

necessary, and improved viewsheds and circulation are the end result.



Figure 2: Photo showing portion of existing fence that is to be removed, with approximate extents of new planting bed hatched.

5. Pedestrian circulation
 - a. Additional entrances to the project area have been added to the Site Context presentation sheet. There is an existing-to-remain point of entry from McMahon street. Rec Center building access points are also shown.
6. Furnishing photos
 - a. Furnishing photos have been added as a final slide to the presentation.