

EZ SIGNS, LLC  
1839 Bustleton Pike  
Feasterville, PA 19053  
P: 1 (866) 349-5444  
F: (215) 676-3269

**EZ SIGNS LLC**  
**1 (866) FIX-LIGHT**

February 12,2025

---

Re: Sign Install for SANDBOX  
1712 Walnut ST

Scope of work:

SIGN A - Proposed one (1) statically LED-lit accessory wall sign 52.23 SQ FT

SIGN B - Proposed one (1) statically LED-lit accessory sign 3.97 SQ FT

SIGN C - Proposed one (1) D/S statically LED-lit accessory blade sign 9 SQ FT

SIGN D - Proposed second surface door vinyl, Qty of two (2), 0.17 SQ FT each

SIGN E - Proposed eight-panel window vinyl graphic 135.15 SQ FT

All existing signage to be removed.

---

Natalya Atroshyna  
EZ SIGNS LLC  
1839 Bustleton Pike  
Feasterville, PA 19053  
p. 267- 406 - 0273  
e. [permits@signsinstall.com](mailto:permits@signsinstall.com)

# PROJECT SCHEDULE

SIGN TYPE/ DESCRIPTION:	QTY.:
A. ILLUM. TRIMLESS FACE-LIT. CHANNEL LTRS/LOGO - R/W MTD "SANDBOX VR" with logo, on raceway flush mounted to building exterior	ONE (1)
B. ILLUM. TRIMLESS FACE-LIT. CHANNEL LTRS/LOGO "SANDBOX VR" with logo mounted to suspended raceway at entrance.	ONE (1)
C. ILLUM. BANNER STYLE BLADE SIGN W/ PUSH THRU COPY mounted to building exterior	ONE (1)
D. DIGITALLY PRINTED QR CODE VINYL DECALS mounted to entrance doors	TWO (2)
E. DIGITALLY PRINTED HP VINYL WINDOW GRAPHICS mounted to window set - 8 panes	EIGHT (8) PANES

PROJECT:

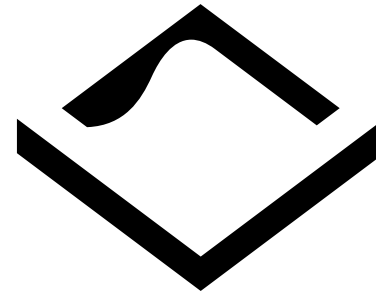

SANDBOX<sup>VR</sup>

Sandbox VR  
Philadelphia - Walnut  
1712 Walnut St  
Philadelphia, PA 19103

## MAP

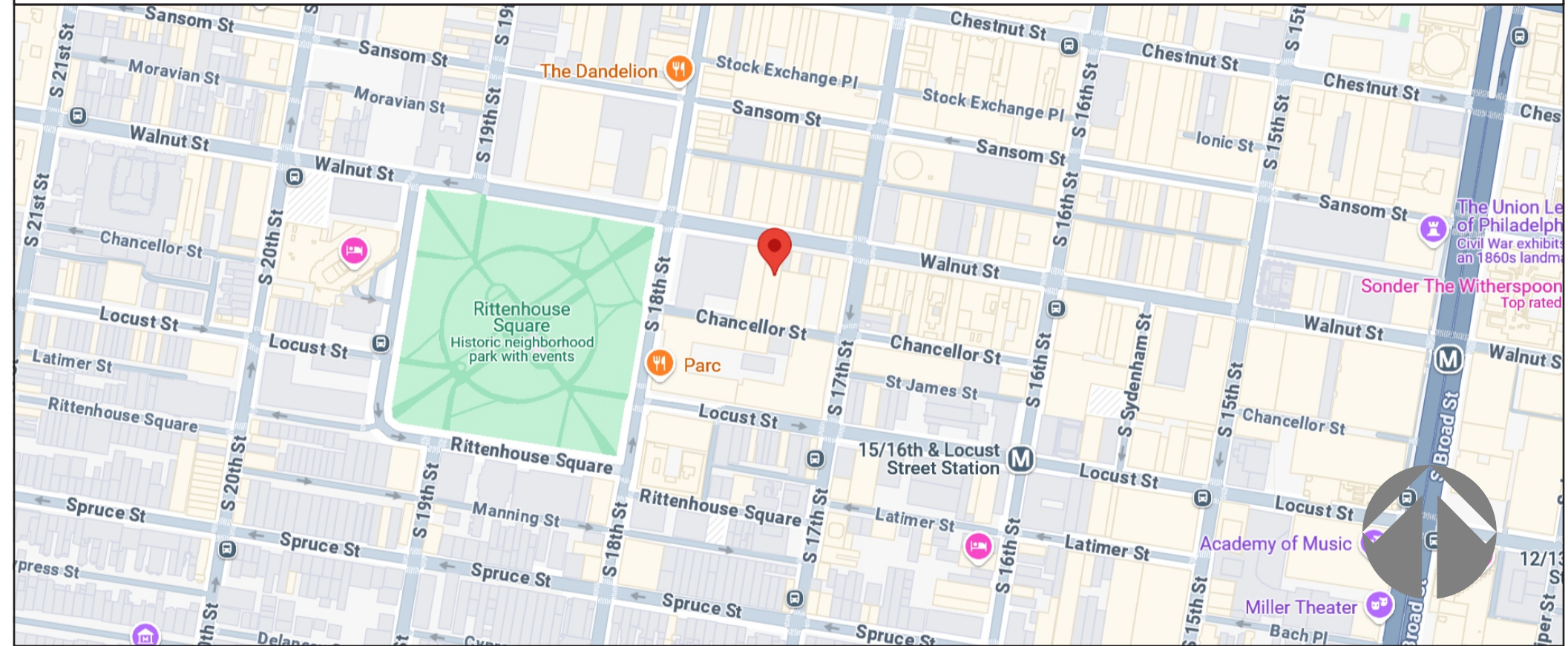

CLIENT & LOCATION



Sandbox VR /// Philadelphia - Walnut  
1712 Walnut St  
Philadelphia, PA 19103



EXISTING STOREFRONT



PROPOSED STOREFRONT



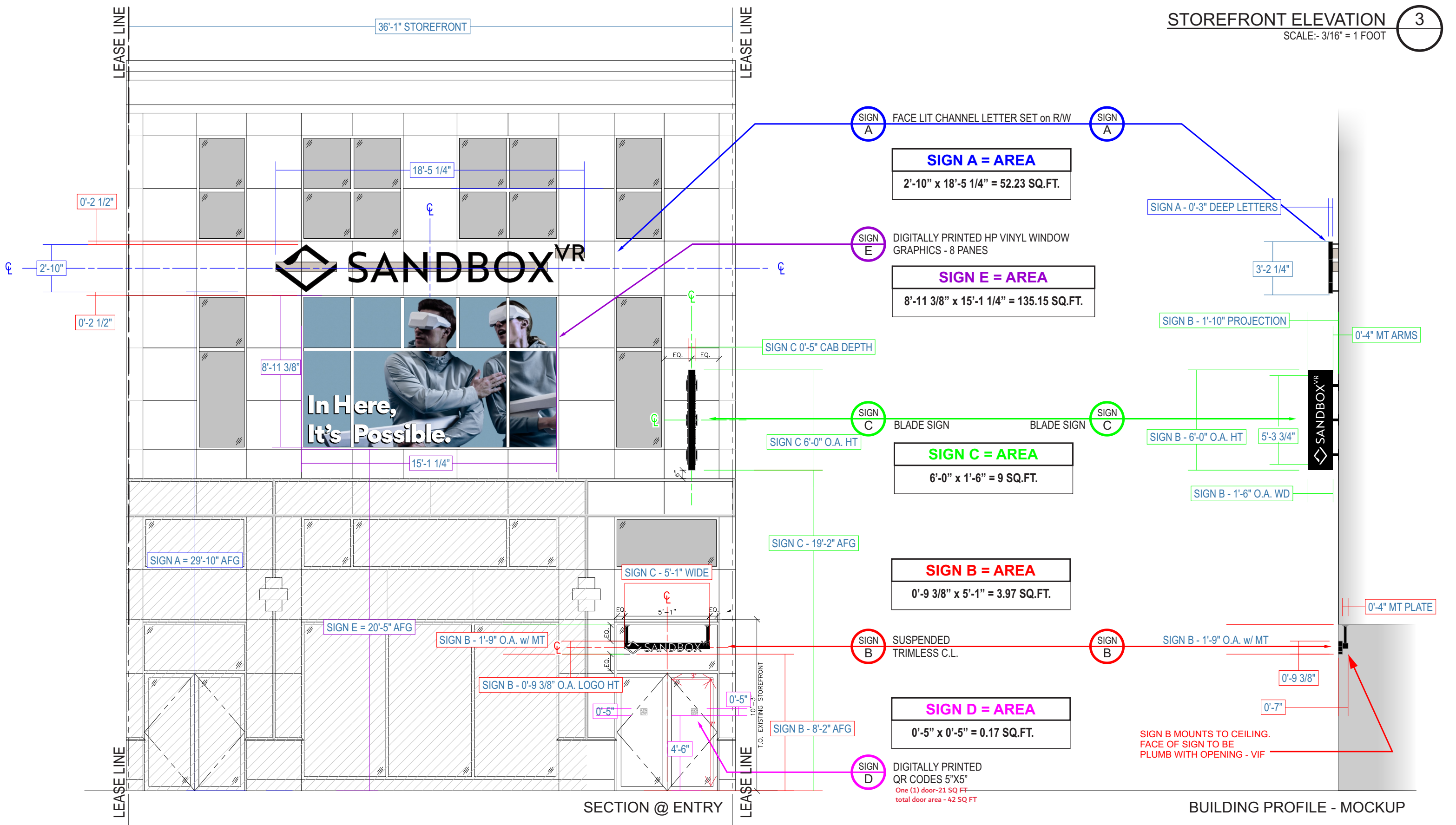

**SIGN A** FACE LIT CHANNEL LETTER SET on R/W

**SIGN A = AREA**  
2'-10" x 18'-5 1/4" = 52.23 SQ.FT.

**SIGN E** DIGITALLY PRINTED HP VINYL WINDOW GRAPHICS - 8 PANES

**SIGN E = AREA**  
8'-11 3/8" x 15'-1 1/4" = 135.15 SQ.FT.

**SIGN C** BLADE SIGN

**SIGN C = AREA**  
6'-0" x 1'-6" = 9 SQ.FT.

**SIGN B** SUSPENDED TRIMLESS C.L.

**SIGN B = AREA**  
0'-9 3/8" x 5'-1" = 3.97 SQ.FT.

**SIGN D** DIGITALLY PRINTED QR CODES 5"X5"

**SIGN D = AREA**  
0'-5" x 0'-5" = 0.17 SQ.FT.

SIGN B MOUNTS TO CEILING.  
FACE OF SIGN TO BE PLUMB WITH OPENING - VIF

SECTION @ ENTRY

BUILDING PROFILE - MOCKUP

# SIGN A - FACE-LIT TRIMLESS CHANNEL LTRS with LOGO on RACEWAY - LAYOUT

**A**

SCALE: 3/8" = 1'

QTY.: ONE (1)

**SIGN A = AREA**  
2'-10" x 18'-5 1/4" = 52.23 SQ.FT.

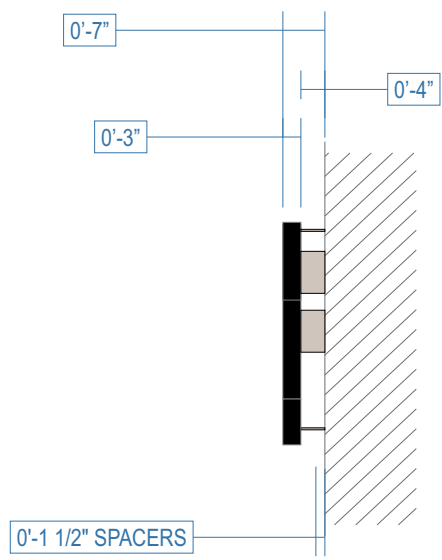
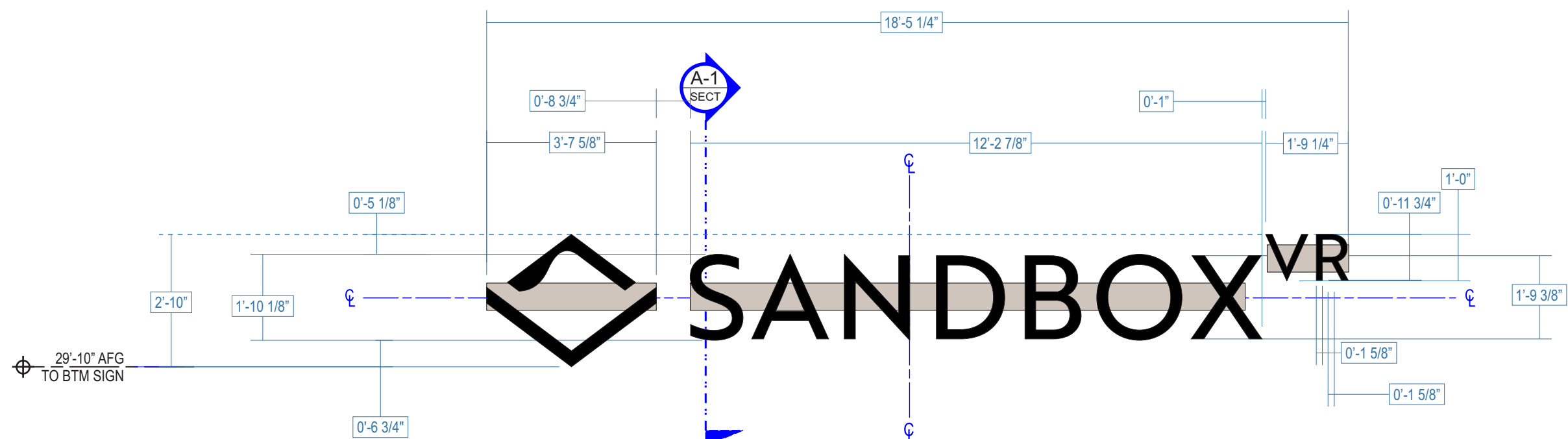

TYP. SIDE

TYP. FRONT

Proposed one (1) statically LED-lit accessory wall sign 52.23 SQ FT

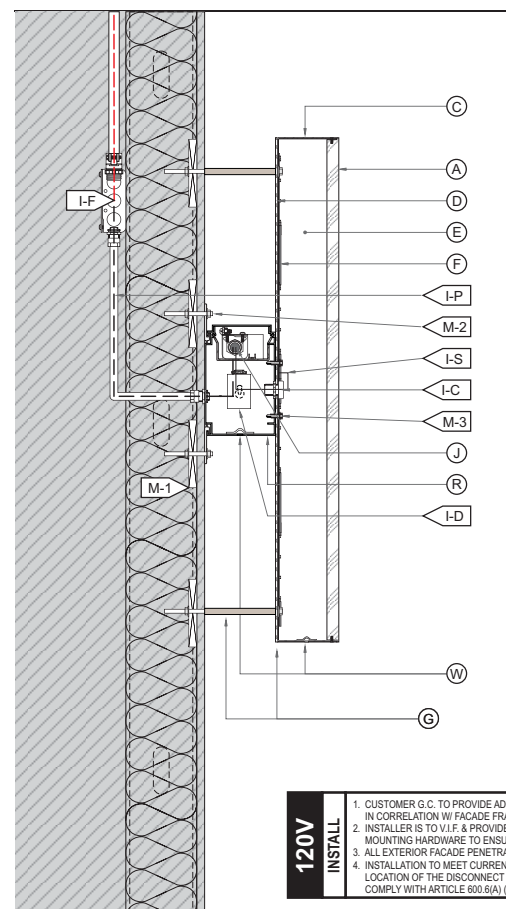

## FACE-LIT CHANNEL LTRS - TRIMLESS ON RACEWAY / SECTION DETAIL

SCALE: N.T.S. **A-1**

### EXTERIOR/ OUTDOORS

<b>(A) FACE</b>	MATERIAL: 1/2" 2447 WHITE ACRYLIC. ~1/8" KIRF EDGE @ FRONT.	<b>(1) WIRING</b>	I-F: FEED SEE ELEC. NOTE. 120V PRIMARY IN J-BOX BY OTHERS.
VINYL: PERFORATED DAY/NIGHT	COLOR: BLACK	I-P: PRIMARY 12awg FEED IN Ø1/2" SEAL-TITE w/ 1/2" CONNECTORS.	I-S: SECONDARY U.L. APPROVED CLASS II LOW VOLTAGE WIRE.
<b>(C) RETURN</b>	DEPTH: 3"	I-C: CONNECTOR U.L. APPROVED CLASS II LOW VOLTAGE CONNECTOR.	I-D: DISCONNECT 120V DISCONNECT SWITCH (@ SIDE OF RACEWAY).
MATERIAL: 0.040" ALUM.	COLOR/ FINISH: WHITE/ SATIN FINISH.	<b>(J) POWER SUPPLY</b>	TYPE: LED POWER SUPPLY IN WEATHER-PROOF, TOP ACCESS
<b>(D) BACK</b>	MATERIAL: 0.060" ALUM.	RACEWAY, J-BOX TO HOUSE ELEC. CONNECTION TO PRIMARY.	VOLTAGE: 120V.
COLOR/ FINISH: PRE-COAT WHITE/ SATIN.	<b>(R) RACEWAY</b>	MATERIAL: 7" x 4" ALUM. EXTRUSION RACEWAY, TOP ACCESS.	COLOR/ FINISH: BEIGE - MATCH BLD FACADE VIF
<b>(E) INSIDE OF CAN</b>	COLOR: PRE-COAT WHITE.	<b>(M) MOUNTING</b>	M-1: SEE INSTALL NOTE. REQ'D. BLOCKING BY OTHERS.
<b>(F) ILLUMINATION</b>	TYPE: 6500°K WHITE LEDS. SEE FABRICATOR NOTE.	M-2: Ø3/8" ALLTHREAD, NUT & WASHERS THRU MNTG. BAR TO BLOCKING BEYOND.	M-3: SELF-TAPPING SCREW.
MECH. NOTE: ALL WIRES TERMINATED w/ A U.L. LISTED MECH. FASTENER.	<b>(G) B/G. PANEL / STRUT</b>	MATERIAL: 1/8" CONTOUR CUT PANEL BEHIND LOGO FOR SUPPORT	TYPE: Ø1/4" HOLE w/ LIGHT BLOCKING COVER.
<b>(W) WEEP HOLE</b>	MATERIAL: 1/2" DIA - SPACER / STRUT AS NEEDED ON LOGO OVERHAND	COLOR/ FINISH: BEIGE - MATCH BLD FACADE VIF	MIN. QTY.: ONE (1) PER LETTER & @ EVERY BOTTOM.
MIN. QTY.: TWO (2) @ 4'-0" O.C. FOR RACEWAY.			



<b>120V INSTALL</b>	<ol style="list-style-type: none"> <li>CUSTOMER G.C. TO PROVIDE ADEQUATE WOOD OR MTL. BLOCKING IN CORRELATION W/ FACADE FRAMING AS REQUIRED.</li> <li>INSTALLER IS TO V.I.F. &amp; PROVIDE THE PROPER NON-CORROSIVE MOUNTING HARDWARE TO ENSURE SAFE INSTALLATION.</li> <li>ALL EXTERIOR FACADE PENETRATIONS TO BE WATER-TIGHT.</li> <li>INSTALLATION TO MEET CURRENT N.E.C., U.L. &amp; LOCAL CODES. LOCATION OF THE DISCONNECT SWITCH AFTER INSTALLATION SHALL COMPLY WITH ARTICLE 600.6(A) (1) OF THE NATIONAL ELECTRICAL CODE.</li> </ol>	<b>ELECTRICAL</b>	<ol style="list-style-type: none"> <li>ALL ELECTRICAL COMPONENTS TO BE U.L. APPROVED.</li> <li>CUSTOMER IS RESPONSIBLE FOR ONE (1) 120V/ 20A DEDICATED CIRCUIT w/ GROUND PER SIGN TO WITHIN 6' OF SIGN.</li> <li>THIS SIGN IS INTENDED TO BE INSTALLED IN ACCORDING W/ THE REQUIREMENTS OF ARTICLE 600 OF THE NATIONAL ELECTRICAL CODE AND/OR OTHER APPLICABLE LOCAL CODES. THIS INCLUDES PROPER GROUNDING &amp; BONDING OF THE SIGN.</li> </ol>	<b>FABRICATOR</b>	<ol style="list-style-type: none"> <li>PLACEMENT OF LIGHTING ELEMENTS FOR OPTIMUM ILLUMINATION OF SIGN TO BE DETERMINED IN PRODUCTION.</li> <li>MANUFACTURER &amp; U.L. LABELS TO BE APPLIED &amp; VISIBLE FROM THE GROUND. LOCATED ON THE LAST CHANNEL LETTER OR END OF THE SIGN BOX/FREESTANDING SIGN.</li> </ol>	<p>ALL ELECTRICAL COMPONENTS ARE TO BE UL APPROVED</p>
---------------------	---	-------------------	--	-------------------	---	--

# SIGN B - TRIMLESS FACE-LIT. CHANNEL LETTER SET with LOGO/ SUSPENDED on RACEWAY - LAYOUT

**B**

SCALE: 1-1/2" = 1'

QTY.: ONE (1)

**SIGN B = AREA**  
 0'-9 3/8" x 5'-1" = 3.97 SQ.FT.

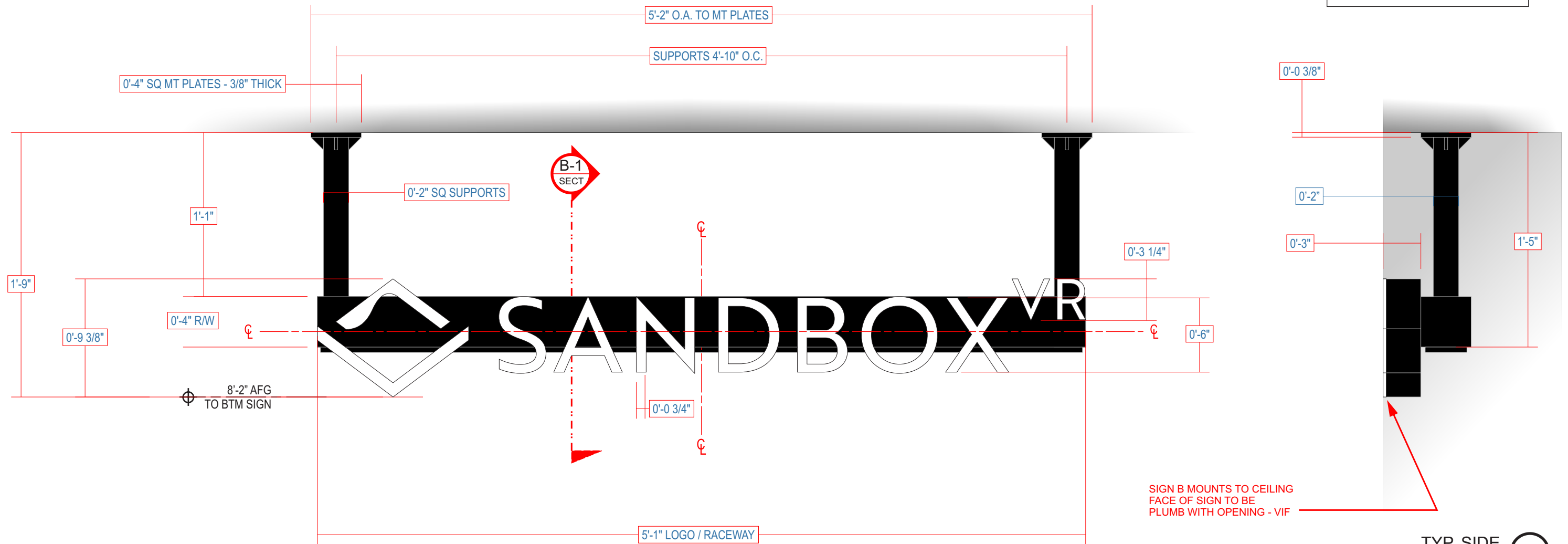

SIGN B MOUNTS TO CEILING  
 FACE OF SIGN TO BE  
 PLUMB WITH OPENING - VIF

TYP. SIDE

TYP. FRONT

**Proposed one (1) statically LED-lit accessory sign 3.97 SQ FT**

**TYP. TRIMLESS FACE-LIT ILLUM. LETTER ON SUSPENDED RACEWAY SECTION DETAIL**  
 EXTERIOR/OUTDOORS  
 SCALE: N.T.S.

<b>FACE</b>	MATERIAL: 3/4" THK. 2447 WHITE ACRYLIC, W/ KERF FOR RETURN	<b>WIRING</b>	SEE ELEC. NOTE. 120V PRIMARY IN J-BOX BY OTHERS
<b>VINYL</b>	N/A	<b>I-P. PRIMARY</b>	20aw FEED IN Ø1/2" SEAL-TITE w/ CONNECTORS
<b>COLOR</b>	N/A	<b>I-S. SECONDARY</b>	1L APPROVED CLASS II LOW VOLTAGE WIRING
<b>RETURN FINISH</b>	N/A	<b>I-C. CONNECTOR</b>	1L APPROVED ELEC. PASS-THRU CONNECTOR
<b>RETURN</b>	2"	<b>I-D. DISCONNECT</b>	120V DISCONNECT SWITCH. LOCATION T.B.D.
<b>DEPTH</b>	2 1/2"	<b>POWER SUPPLY</b>	REMOTE LED POWER SUPPLY & DISCONNECT SWITCH
<b>MATERIAL</b>	1/2" ALUM.	<b>TYPE</b>	HOUSED IN WEATHER-PROOF, TOP ACCESS METAL BOX
<b>COLOR/ FINISH</b>	BLACK/ SATIN	<b>TYP. J-BOX TO HOUSE ELEC. CONNECTION TO PRIMARY</b>	
<b>BACK</b>	3mm ACM	<b>VOLTAGE</b>	120V
<b>COLOR/ FINISH</b>	EXTERIOR: BLACK/ SATIN	<b>RACEWAY</b>	2" x 4" ALUM. RACEWAY w/ ACCESS
<b>INTERIOR: WHITE</b>		<b>COVER @ BOTTOM</b>	TWO (2) 2" x 2" HEAVY WALL SQ. TUBES
<b>INSIDE OF SIGN</b>	FINISHED WHITE	<b>FINISH</b>	w/ 4" x 4" x 3/8" ALUM. MNTG. PLATES - GUSSETS AS NEEDED
<b>ILLUMINATION</b>	6500°K WHITE LEDS. SEE FABRICATOR NOTE.	<b>COLOR/ FINISH</b>	BLACK/ SATIN
<b>MECH. NOTE</b>	ALL WIRES TERMINATED w/ FULL LISTED MECH. FASTENER	<b>MOUNTING</b>	
<b>MNTG. PANEL</b>	CONTOUR CUT 1/8" ALUM. PANEL. BOND TO RACEWAY	<b>M-1</b>	SEE INSTALL NOTE. SUPPORT BLOCKING BY OTHERS.
<b>COLOR/ FINISH</b>	BLACK/ SATIN	<b>M-2</b>	3/16" MECH. FASTENERS TO BLOCKING. VERIFY
<b>TYPE</b>	120V	<b>M-3</b>	FLUSH FIT COUNTER-SUNK SCREW TO NUTSERT
<b>INSTALL</b>		<b>M-4</b>	FLUSH FIT COUNTER-SUNK SCREW
		<b>M-5</b>	FLUSH FIT SET SCREW. FINISH HEAD TO MATCH
		<b>WEEP HOLE</b>	
		<b>TYPE</b>	3/16" HOLE w/ LIGHT-BLOCKING COVER/ BAFFLE.
		<b>MIN. QTY.</b>	ONE (1) PER LETTER & @ EVERY BOTTOM

**120V INSTALL**

- CUSTOMER G.C. TO PROVIDE ADEQUATE WOOD OR METAL BLOCKING IN CORRELATION W/ FACADE FRAMING AS REQUIRED.
- INSTALLER IS TO V.I.F. & PROVIDE THE PROPER NON-CORROSIVE MOUNTING HARDWARE TO ENSURE SAFE INSTALLATION.
- ALL EXTERIOR FACED FINISHING TO BE WATER-TIGHT.
- INSTALLATION TO MEET CURRENT N.E.C., U.L. & LOCAL CODES.
- LOCATION OF THE DISCONNECT SWITCH AFTER INSTALLATION SHALL COMPLY WITH ARTICLE 680.5(A) (1) OF THE NATIONAL ELECTRICAL CODE.

**ELECTRICAL**

- ALL ELECTRICAL COMPONENTS TO BE U.L. APPROVED.
- CUSTOMER IS RESPONSIBLE FOR ONE (1) 120V 20a DEDICATED CIRCUIT w/ GROUNDING FOR SIGN TO WITHIN 4' OF SIGN.
- THIS SIGN IS INTENDED TO BE INSTALLED IN ACCORDANCE W/ THE REQUIREMENTS OF ARTICLE 680.5(A) OF THE NATIONAL ELECTRICAL CODE AND/OR OTHER APPLICABLE LOCAL CODES. THIS INCLUDES PROPER GROUNDING & BONDING OF THE SIGN.

**FABRICATOR**

- PLACEMENT OF LIGHTING ELEMENTS FOR OPTIMUM ILLUMINATION OF SIGN TO BE DETERMINED IN PRODUCTION.
- MANUFACTURER'S & U.L. LABELS TO BE APPLIED & VISIBLE FROM THE GROUND. LOCATED ON THE LAST CHANNEL LETTER OR END OF THE SIGN BODY/FREESTANDING SIGN.

**UL**  
 ALL ELECTRICAL COMPONENTS ARE TO BE U.L. APPROVED



**SIGN C - ILLUM. BANNER STYLE BLADE SIGN W/ PUSH THRU COPY**

**C**

SCALE: 1" = 1'  
QTY.: ONE (1)

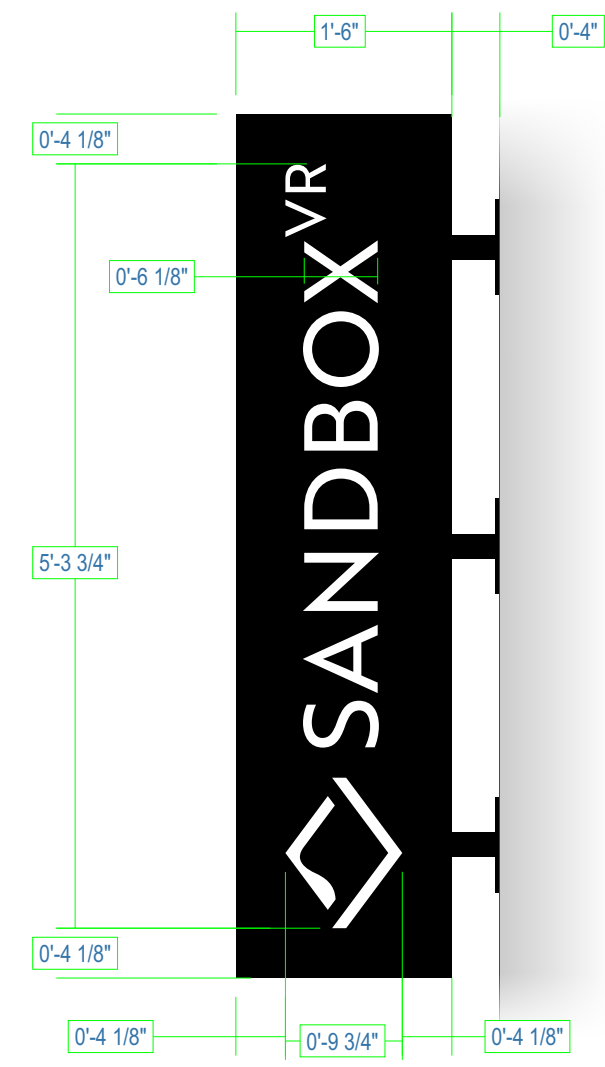
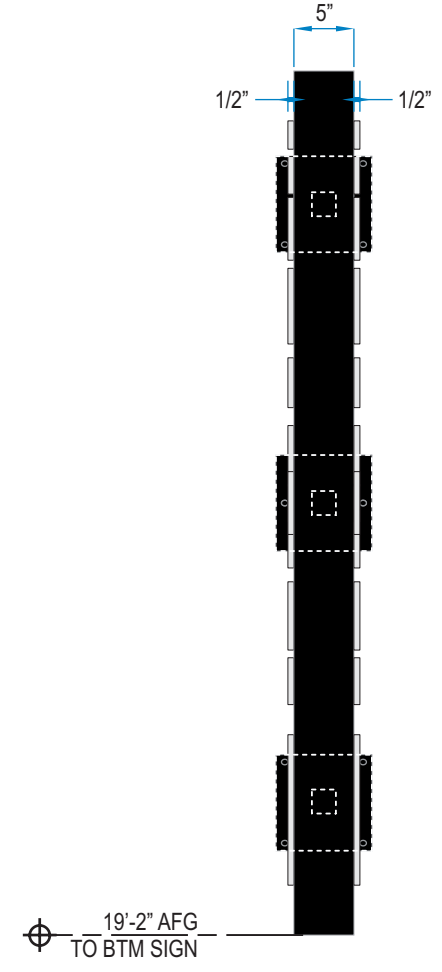
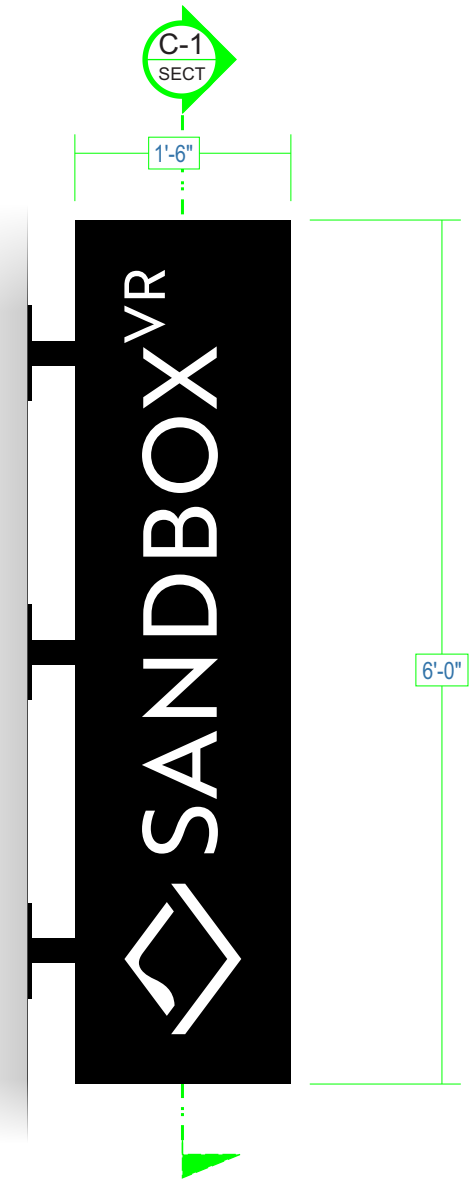

**SIGN C = AREA**  
6'-0" x 1'-6" = 9 SQ.FT.

**FOUR (4) MECHANICAL FASTENERS PER 3/8" PLATE**

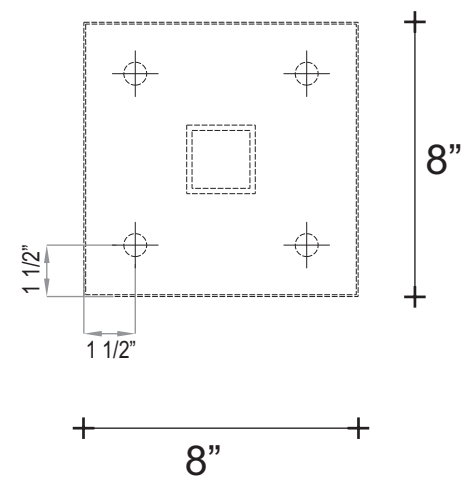

**MOUNTING PLATE**  
SCALE: N.T.S.  
QTY.: THREE (3)

LEFT FACE

END

RIGHT FACE

**Proposed one (1) D/S statically LED-lit accessory blade sign 9 SQ FT**

**INTERNALLY ILLUM. D/S BLADE SIGN W/ PUSH-THRU COPY - SECTION DETAIL**  
EXTERIOR INSTALLATION  
SCALE: N.T.S. **C-1 SECT**

<b>(A) FACE</b>	MATERIAL: 1/8" ALUM. ROUTED w/ LOGO COPY	<b>(I) WIRING</b>	I-F: SEE ELEC. NOTE. 120V PRIMARY ELEC. SERVICE BROUGHT TO TOP J-BOX LOCATED BEHIND SIGN BY OTHERS
<b>COLOR FINISH:</b>	SATIN BLACK	I-G:	UL APPROVED CLASS II LOW VOLTAGE WIRE
<b>A-1:</b>	BACKUP MOUNTS w/ 1024 WELDED STUDS & NUTS	I-H:	UL APPROVED DISCONNECT SWITCH LOCATED @ TOP
<b>A-2 BACKUP:</b>	3/16" WHITE ACRYLIC #2447	I-J:	TYP. J-BOX TO HOUSE ELECTRICAL CONNECTIONS
<b>A-3 PUSH THRU:</b>	1/2" CLEAR ACRYLIC	I-S:	12mg IN 1/2" SEAL-TITE & 1/2" CONNECTOR
<b>A-3 FINISH:</b>	CLEAR FINISH RETURNS	I-L:	UL LABELS AFFIXED @ TOP & OUT OF VIEW
<b>(B) MOUNTING PLATE</b>	MATERIAL: 4 1/2" W x 4 1/2" H x 1/4" ALUM.	<b>(J) POWER SUPPLY</b>	TYPE: INTERNAL LED POWER SUPPLY
<b>COLOR FINISH:</b>	SATIN BLACK	VOLTAGE:	120V
<b>(C) RETURNS</b>	DEPTH: 1/2"	<b>(M)</b>	SEE MOUNTING NOTE. REDD. BLOCKING BY OTHERS
<b>MATERIAL:</b>	1/8" ALUM.	M-1:	3/8" DIA. MOUNTING HOLES w/ MASONRY ANCHORS THRU
<b>COLOR FINISH:</b>	SATIN BLACK	M-2:	ALUM. ANGLE ATTACHES TO BACK SIDE OF FACE
<b>(F) ILLUMINATION</b>	TYPE: WHITE LEDS MOUNTED ON ALUM. BAFFLE	M-3:	FLUSH MOUNTING SCREWS (PAINT TO MATCH RETURNS)
<b>(B) BAFFLE</b>	MATERIAL: 0.047" PRE-COAT WHITE ALUM.	<b>(W) WEEP HOLES:</b>	1/4" DIA. WITH COVER
<b>(H) SUPPORTS</b>	MATERIAL: 2" x 2" x 1/8" ALUM. TUBE		
<b>COLOR FINISH:</b>	SATIN BLACK		

**120V INSTALL**

- CUSTOMER O.C. TO PROVIDE ADEQUATE WOOD OR MTL. BLOCKING IN CORRELATION W/ FACADE FRAMING AS REQUIRED.
- INSTALLER IS TO V.I.F. & PROVIDE THE PROPER NON-CORROSIVE MOUNTING HARDWARE TO ENSURE SAFE INSTALLATION.
- ALL EXTERIOR FACADE PENETRATIONS TO BE WATER-TIGHT.
- INSTALLATION TO MEET CURRENT N.E.C., U.L. & LOCAL CODES. LOCATION OF THE DISCONNECT SWITCH AFTER INSTALLATION SHALL COMPLY WITH ARTICLE 600.8(A) (1) OF THE NATIONAL ELECTRICAL CODE

**ELECTRICAL**

- ALL ELECTRICAL COMPONENTS TO BE U.L. APPROVED.
- CUSTOMER IS RESPONSIBLE FOR ONE (1) 120V/20A DEDICATED CIRCUIT w/ GROUND PER SIGN TO WITHIN 6' OF SIGN.
- THIS SIGN IS INTENDED TO BE INSTALLED IN ACCORDING WITH THE REQUIREMENTS OF ARTICLE 600 OF THE NATIONAL ELECTRICAL CODE AND/OR OTHER APPLICABLE LOCAL CODES. THIS INCLUDES PROPER GROUNDING & BONDING OF THE SIGN.

**FABRICATOR**

- PLACEMENT OF LIGHTING ELEMENTS FOR OPTIMUM ILLUMINATION OF SIGN TO BE DETERMINED IN PRODUCTION.
- MANUFACTURER & U.L. LABELS TO BE APPLIED & VISIBLE FROM THE GROUND. LOCATED ON THE LAST CHANNEL LETTER OR END OF THE SIGN BOX/FREESTANDING SIGN

**BLACK SATIN** **ACRYLIC**

**UL**  
ALL ELECTRICAL COMPONENTS ARE TO BE UL APPROVED

**SIGN D - DIGITALLY PRINTED QR CODE DECALS**

D

SCALE: ACTUAL SIZE

QTY.: TWO

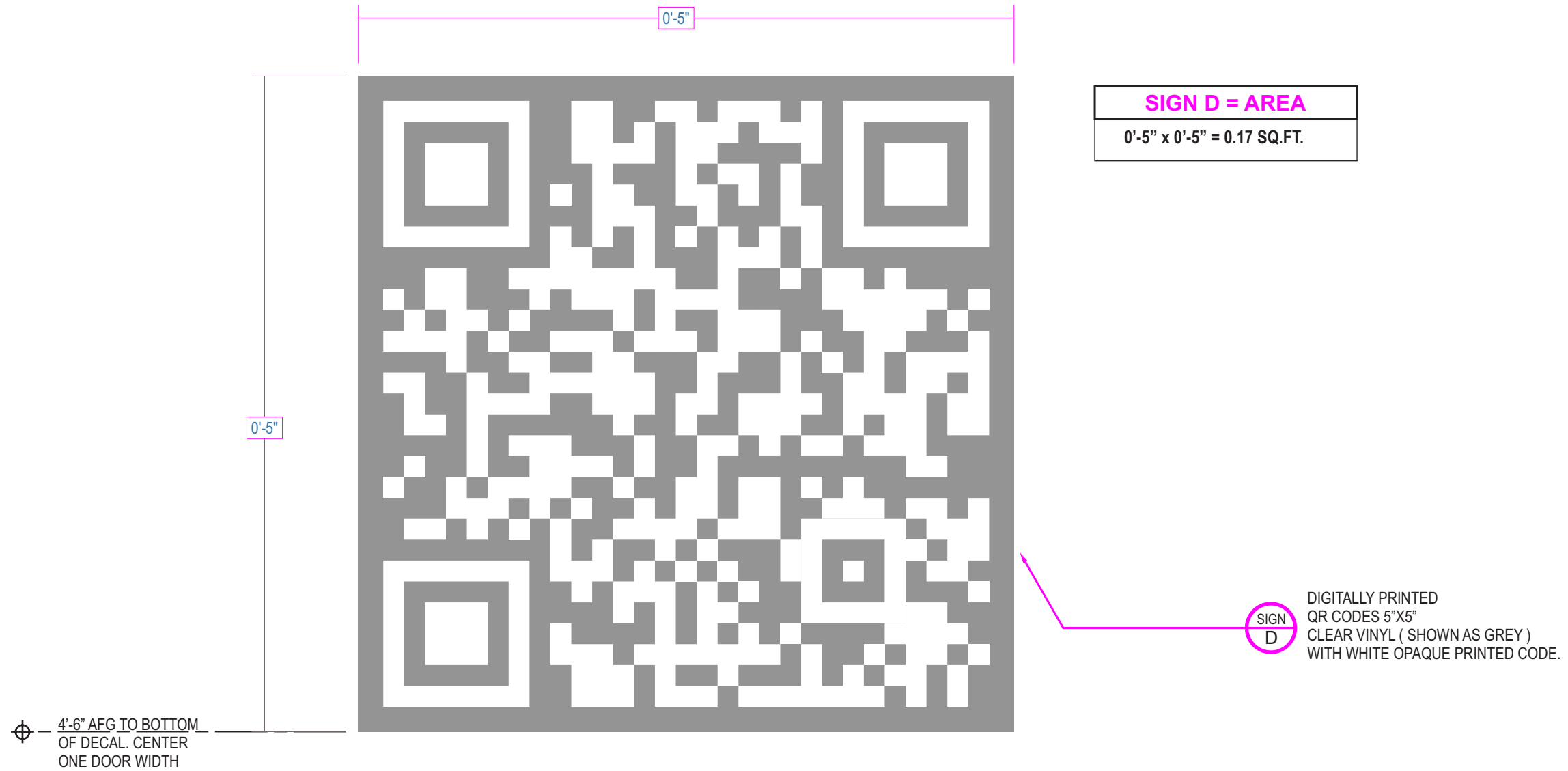

**Second surface door vinyl graphics**

**Qty: 2**

**0.17 SQ FT -each**

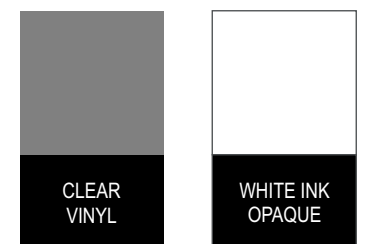



# SIGN E - DIGITALLY PRINTED WINDOW GRAPHICS

E

SCALE: 3/4" = 1 FOOT

QTY.: EIGHT (8) PANES



## SIGN E = AREA

8'-11 3/8" x 15'-1 1/4" = 135.15 SQ.FT.

DIGITALLY PRINTED HP VINYL WINDOW GRAPHICS - 8 PANES  
VERIFY ALL DIMENSION IN FIELD PRIOR TO PRODUCTION ( SIZES FROM ELEVATIONS SHOWN )

⊕ 20'-5" AFG  
TO BTM SIGN

Proposed eight-panel window vinyl 135.15 SQ FT

# SITE PLAN - SIGN LOCATIONS

SCALE: 1"=15'-0"

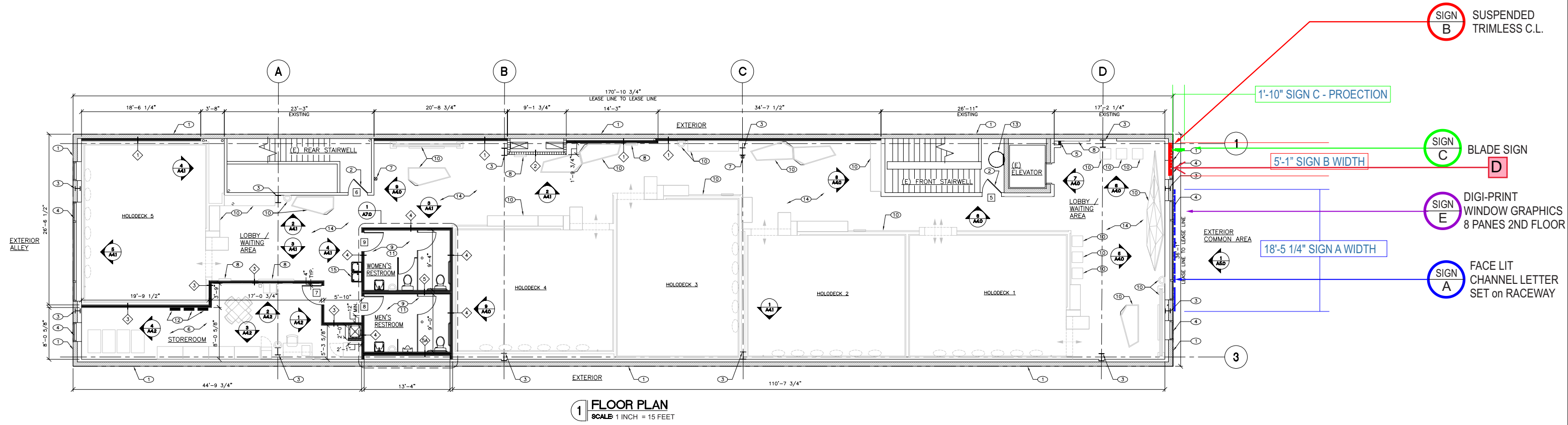

**1 FLOOR PLAN**  
SCALE: 1 INCH = 15 FEET



Sandbox VR /// Philadelphia - Walnut  
1712 Walnut St  
Philadelphia, PA 19103

17TH ST

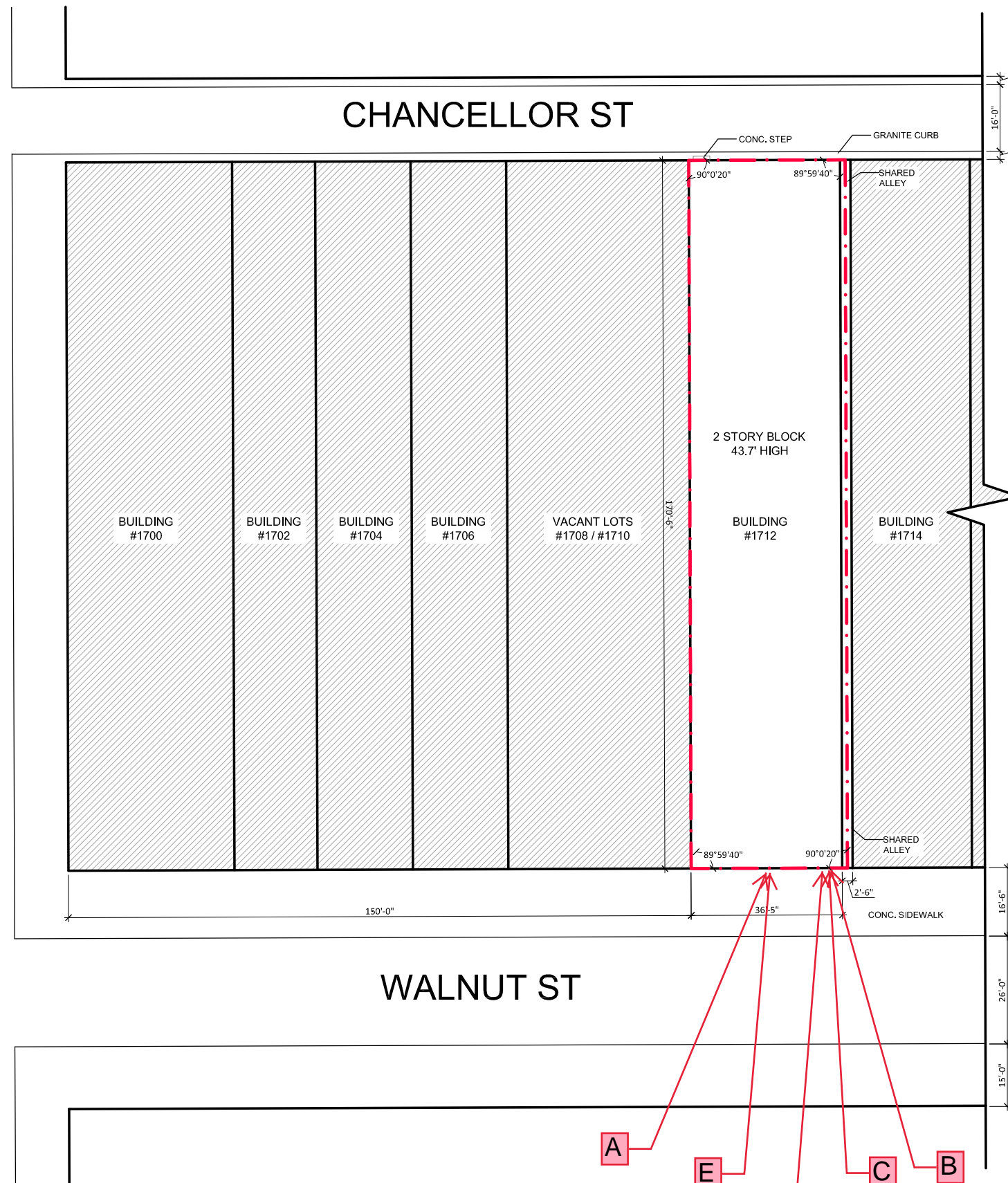

SIGN A - Proposed one (1) statically LED-lit accessory wall sign 52.23 SQ FT  
SIGN B - Proposed one (1) statically LED-lit accessory sign 3.97 SQ FT  
SIGN C - Proposed one (1) D/S statically LED-lit accessory blade sign 9 SQ FT  
SIGN D - Proposed second surface door vinyl, Qty of two (2), 0.17 SQ FT each  
SIGN E - Proposed eight-panel window vinyl graphic 135.15 SQ FT

All existing signage to be removed.

SCALE: 1/32" = 1'-0"

