

**NOMINATION OF HISTORIC BUILDING, STRUCTURE, SITE, OR OBJECT
PHILADELPHIA REGISTER OF HISTORIC PLACES
PHILADELPHIA HISTORICAL COMMISSION**

SUBMIT ALL ATTACHED MATERIALS ON PAPER AND IN ELECTRONIC FORM (CD, EMAIL, FLASH DRIVE)
ELECTRONIC FILES MUST BE WORD OR WORD COMPATIBLE

1. ADDRESS OF HISTORIC RESOURCE *(must comply with an Office of Property Assessment address)*

Street address: 376 MARTIN STREET

Postal code: 19128

2. NAME OF HISTORIC RESOURCE

Historic Name: deutschen evangelisch-lutherischen Bethanien-Kirche (Ecke Martin und Pechin Straße) zu Roxborough und Manayunk

Current/Common Name: German Evangelical Lutheran Bethanien Burial Ground of Manayunk & Roxborough

3. TYPE OF HISTORIC RESOURCE

Building

Structure

Site

Object

4. PROPERTY INFORMATION

Condition: excellent good fair poor ruins

Occupancy: occupied vacant under construction unknown

Current use: BURIAL GROUND / CEMETERY

5. BOUNDARY DESCRIPTION

Please attach a narrative description and site/plot plan of the resource's boundaries.

6. DESCRIPTION

Please attach a narrative description and photographs of the resource's physical appearance, site, setting, and surroundings.

7. SIGNIFICANCE

Please attach a narrative Statement of Significance citing the Criteria for Designation the resource satisfies.

Period of Significance (from year to year): from 5th April 1845 to 1970's (English)

Date(s) of construction and/or alteration: 25th August 1850 — Burial Ground Consecrated

Architect, engineer, and/or designer: German Evangelical-Lutheran Congregation in the town of Manayunk

Builder, contractor, and/or artisan: Consecrated by REV. C. C. A. BRANDT

Original owner: Deeds are cited within the nomination

Other significant persons: REV. ADOLPH HELLWEGE

CRITERIA FOR DESIGNATION:

The historic resource satisfies the following criteria for designation (check all that apply):

- (a) Has significant character, interest or value as part of the development, heritage or cultural characteristics of the City, Commonwealth or Nation or is associated with the life of a person significant in the past; or,
- (b) Is associated with an event of importance to the history of the City, Commonwealth or Nation; or,
- (c) Reflects the environment in an era characterized by a distinctive architectural style; or,
- (d) Embodies distinguishing characteristics of an architectural style or engineering specimen; or,
- (e) Is the work of a designer, architect, landscape architect or designer, or engineer whose work has significantly influenced the historical, architectural, economic, social, or cultural development of the City, Commonwealth or Nation; or,
- (f) Contains elements of design, detail, materials or craftsmanship which represent a significant innovation; or,
- (g) Is part of or related to a square, park or other distinctive area which should be preserved according to an historic, cultural or architectural motif; or,
- (h) Owing to its unique location or singular physical characteristic, represents an established and familiar visual feature of the neighborhood, community or City; or,
- (i) Has yielded, or may be likely to yield, information important in pre-history or history; or
- (j) Exemplifies the cultural, political, economic, social or historical heritage of the community.

8. MAJOR BIBLIOGRAPHICAL REFERENCES

Please attach a bibliography.

9. NOMINATOR

Organization _____ Date 22 February 2024

Name with Title John C. Manton & Joseph J. Menkevich Email menkevich.research@gmail.com

Street Address Frankford Post Office. PO Box 45148 Telephone _____

City, State, and Postal Code 19124

Nominator is is not the property owner.

PHC USE ONLY

Date of Receipt: 22 February 2024; 8 January 2025 (revised)

Correct-Complete Incorrect-Incomplete Date: January 14, 2025

Date of Notice Issuance: January 17, 2025

Property Owner at Time of Notice:

Name: Southeastern Pennsylvania Synod of the Evangelical Lutheran Church in America

Address: United Lutheran Seminary

7241 Germantown Avenue

City: Philadelphia State: PA Postal Code: 19119

Date(s) Reviewed by the Committee on Historic Designation: February 19, 2025

Date(s) Reviewed by the Historical Commission: March 14, 2025

Date of Final Action: _____

Designated Rejected

NOMINATION OF THE GERMAN EVANGELICAL LUTHERAN BETHANIEN BURIAL GROUND AT MANAYUNK AND ROXBOROUGH FOR DESIGNATION TO THE PHILADELPHIA REGISTER OF HISTORIC PLACES

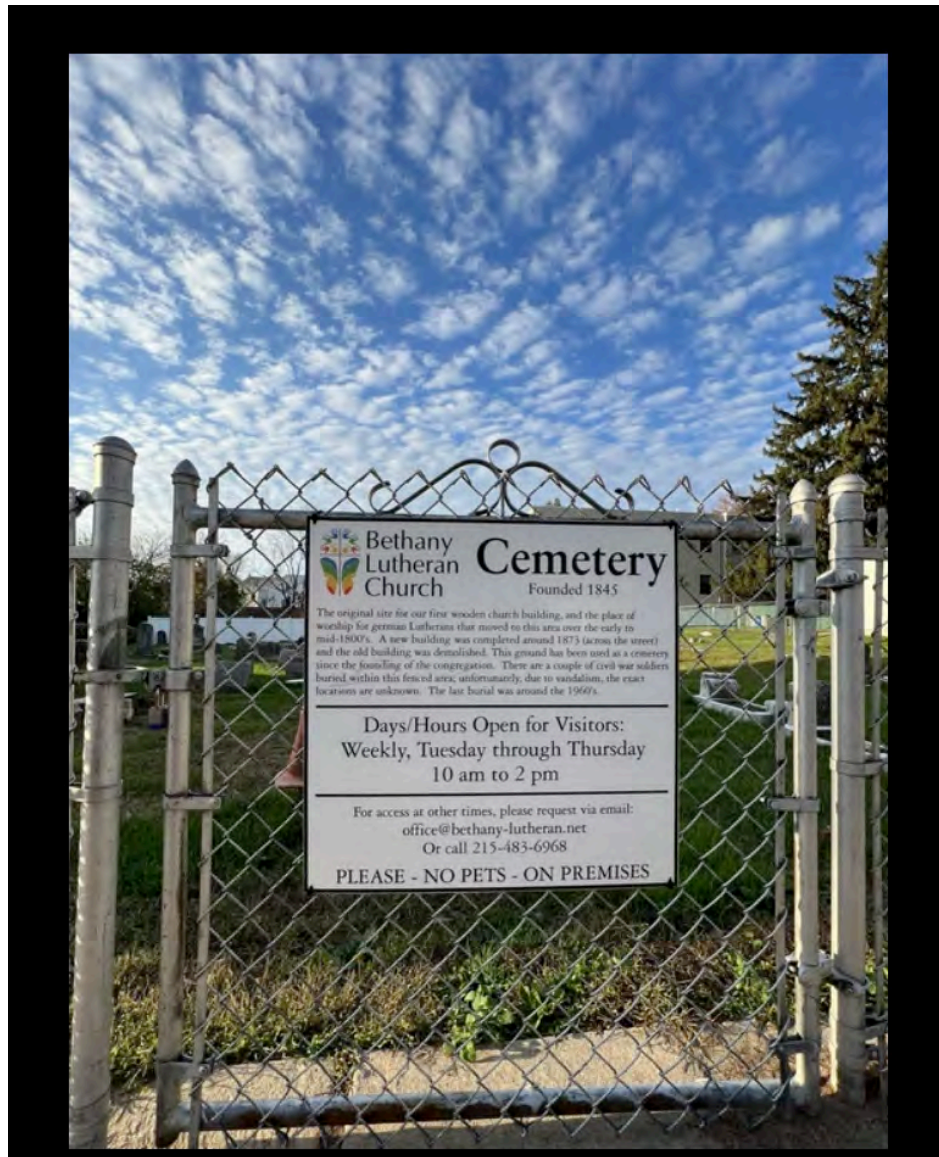

©Photo by The Roxborough, Manayunk & Wissahickon Historical Society.
<<https://www.rmwhs.org/landmarks/bethany-lutheran-cemetery>>.

Constitution of the German Evangelical Lutheran Church of Manayunk — 17th December 1853
Article 22nd of The Burying Ground — Recorded 7th March 1854

Art. 22nd
Of the Burying Ground
Every member who regularly pays his dues is entitled in
case of the death of himself or any member of his family
(wife and children) to a free grave lot. Provided that
no child of such member above the age of 21 years shall
be entitled to this privilege unless he is a member and shall
have paid his regular dues

Miscellaneous Book: TH No.1 page 60 — Accessed: Philadelphia City Archives. 27th June 2023.

1. LOCATION: 376 – 378 MARTIN STREET in the 21ST WARD of PHILADELPHIA, PENNSYLVANIA

BETHANY GERMAN EVANGELICAL LUTHERAN CEMETERY AT ROXBOROUGH–MANAYUNK

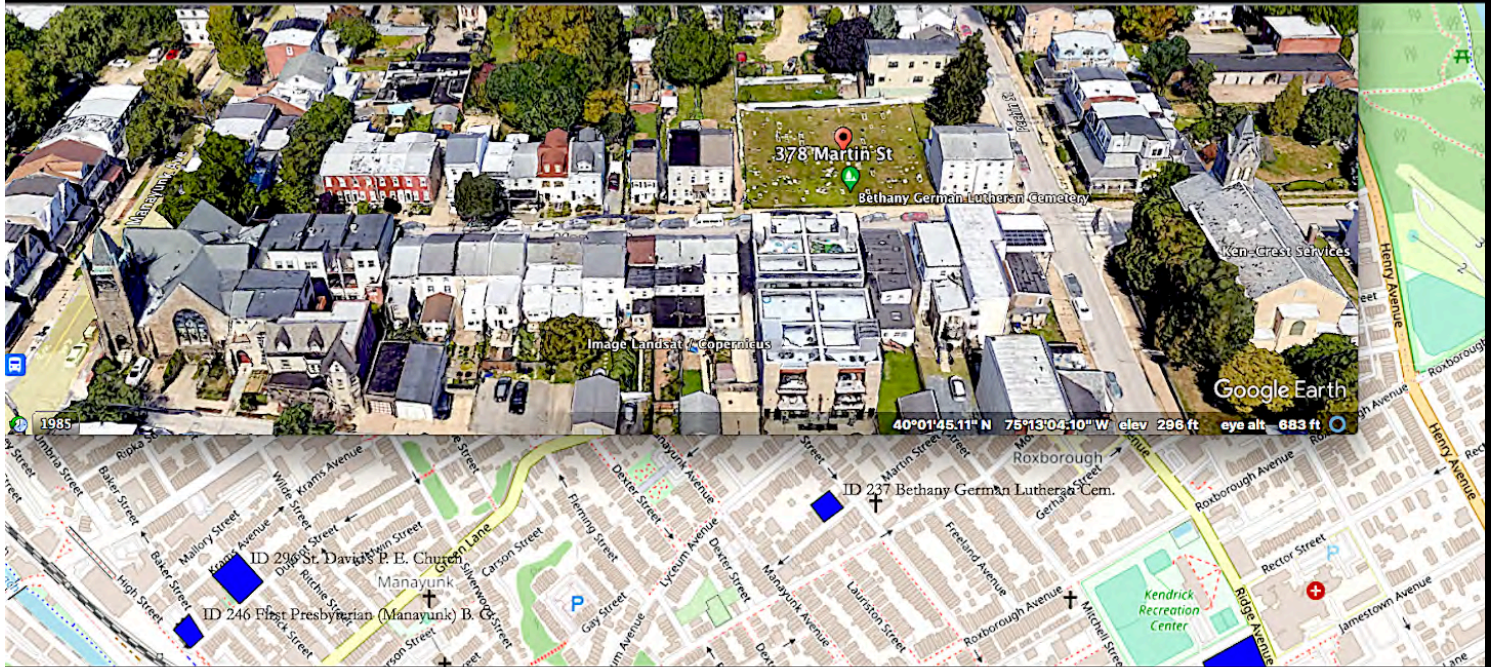

Image No. 03 – Google Earth Overlay onto Philadelphia Archaeological Forum Historic Burial Place Database. ¹

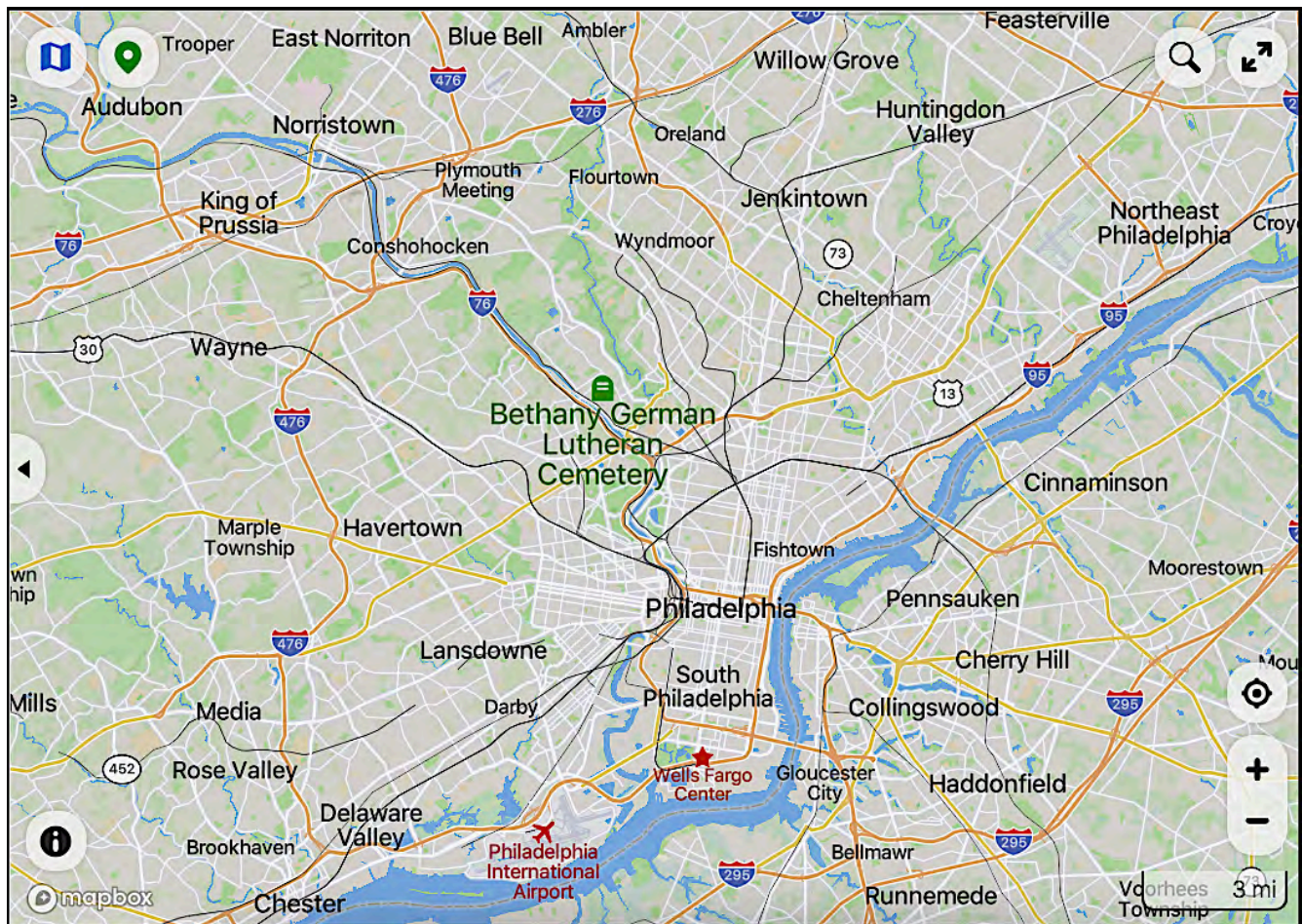

Image No. 04 – Courtesy of Mapcarta. Web. 23rd August 2023. <<https://mapcarta.com/W666537046>>.

¹ Philadelphia Archaeological Forum. Web. <<https://www.phillyarchaeology.net/paf-activities/burial-places-forum/>>.

2. NAME: THE BURIAL GROUND OF THE GERMAN EVANGELICAL LUTHERAN BETHANIEN CHURCH OF ROXBOROUGH — MANAYUNK ²

UPON THIS CONSECRATED GROUND - A CHURCH WAS ERECTED AND A BURIAL GROUND LAID OUT.



Image No. 05 – Courtesy of the Philadelphia Water Revenue Department

² Religious services were in the German Language for many years. This Church was known as: *deutschen evangelisch-lutherischen Bethanien-Kirche (Ecke Martin und Pechin Straße) zu Roxborough und Manayunk, Philadelphia, Pa.*

5. BOUNDARY DESCRIPTION: THREE (3) CERTAIN CONTIGUOUS LOTS OR PIECES OF LAND

The German Evangelical Lutheran Bethanien Burial Ground situate 376–378 Martin Street is composed of three separate and individually numbered parcels, combined - forming a rectangle measuring 117 feet in breadth on Martin Street & 100 feet in depth. The lines run parallel to Pechin Street & perpendicular (90°) against Martin Street. (See images Nos. 05, 06, 07 & 08).

376 MARTIN STREET — MAP REGISTRY NOS. 092N13008 (25 x 100 FEET) AND 092N130150 (17 x 100 FEET)

City of Philadelphia | Atlas

376 MARTIN ST
PHILADELPHIA, PA 19128-4841

There is 1 active parcel at this address.

092N130008

Parcel Details

Map Registry #	092N130008
Parcel Address	376 MARTIN ST
Status	Active
Origination Date	04/22/2003
Inactive Date	12/30/1899
Has Air Rights	No

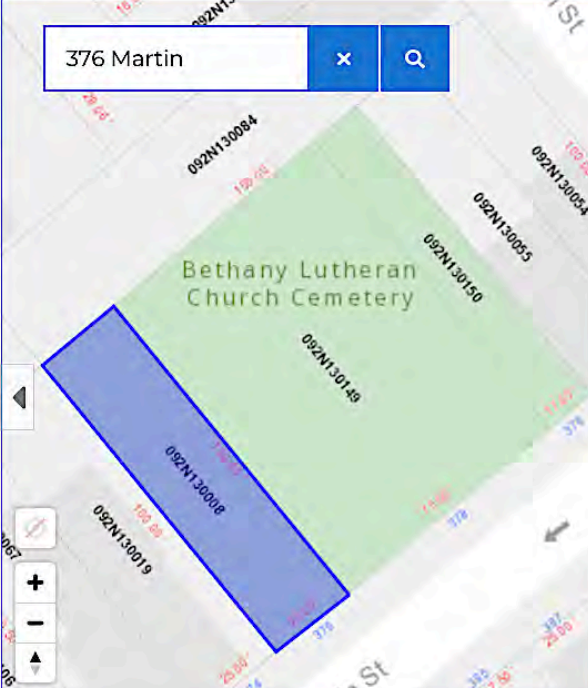

City of Philadelphia | Atlas

376 MARTIN ST
PHILADELPHIA, PA 19128-4841

There are 2 active parcels at this address.

092N130150 092N130008

Parcel Details

Map Registry #	092N130150
Parcel Address	376 MARTIN ST
Status	Active
Origination Date	04/22/2003
Inactive Date	12/30/1899
Has Air Rights	No

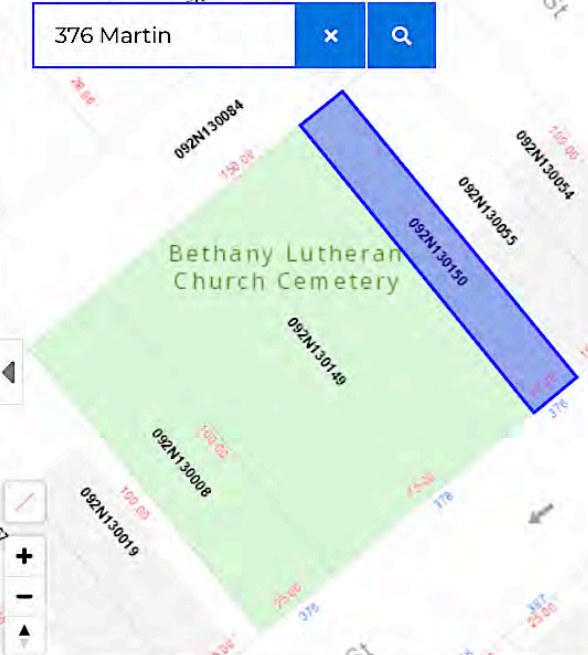

Images Nos. 06 & 07 – City of Philadelphia <<https://atlas.phila.gov/376%20MARTIN%20ST/deeds>>.

5. BOUNDARY DESCRIPTION: THREE (3) CERTAIN CONTIGUOUS LOTS OR PIECES OF LAND

378 MARTIN STREET — MAP REGISTRY No. 092N130149 (75 x 100 FEET)

378 MARTIN ST
HILADELPHIA, PA 19128-4841

There is 1 active parcel at this address.

092N130149

Parcel Details

Map Registry #	092N130149
Parcel Address	378 MARTIN ST
Status	Active
Origination Date	04/22/2003
Inactive Date	12/30/1899

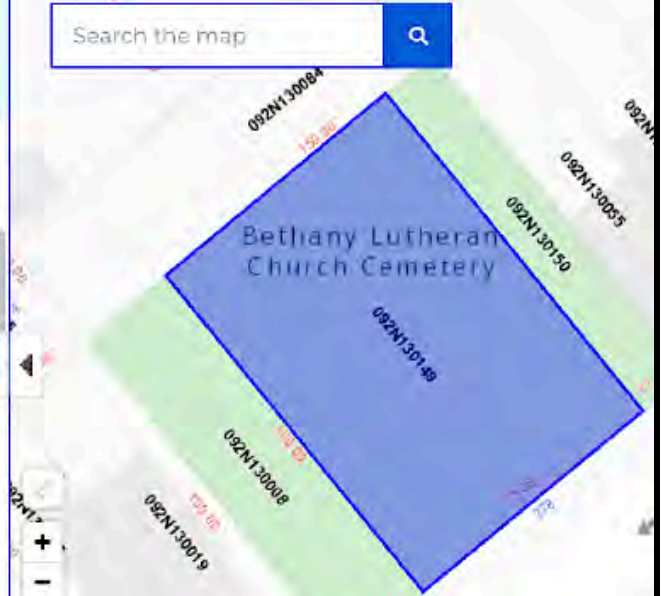

Image No. 08 – City of Philadelphia <<https://atlas.phila.gov/378%20MARTIN%20ST/deeds>>.

BEING A CERTAIN LOT OF GROUND with a Church thereon erected (now demolished), laid out for a Burial Ground SITUATE on the Northwesterly side of Martin Street in MANAYUNK-ROXBOROUGH in the TWENTY-FIRST WARD of the city of Philadelphia **CONTAINING** in front or breadth on said Martin Street ONE HUNDRED SEVENTEEN (117) FEET and extending at right angles to said Martin Street ONE HUNDRED (100) FEET in Depth – as described in the deeds:

...**BEING** the same lot of ground which Amelia Copeland of the City of Philadelphia and State of Pennsylvania, Singlewoman, William H. Copeland of Titusville County of Crawford State of Pennsylvania, Merchant and Emma L. his Wife & others... [the Children of William Copeland of the City, Carpenter deceased and Martha Copeland, Widow and relict] granted and conveyed unto the German Evangelical Lutheran Church of Manayunk,

...**BEING** the Westerly moiety or half part of lot 149 in the Plan of Upper Manayunk (on Summer Street) 25 feet in breadth and at right angles 100 feet bounded by the German Evangelical Lutheran Church of Manayunk.³

Vicinity of Philadelphia, From Actual Surveys, 1861, Plate 4-B: Southeast Suburbs

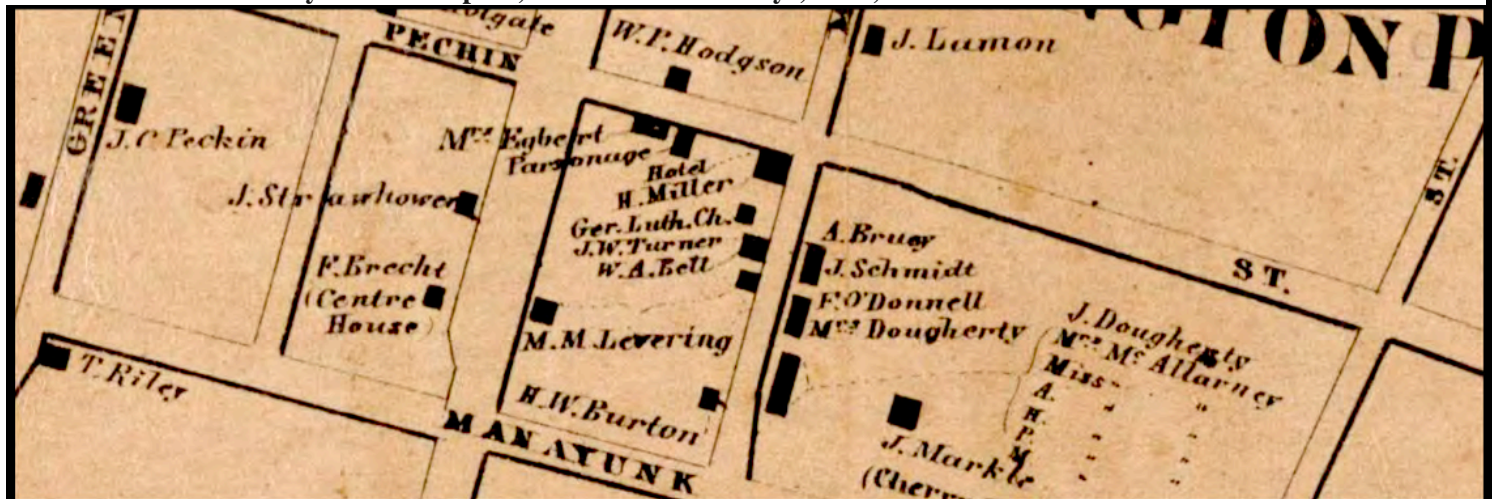

Image No. 09 – Courtesy of The Free Library of Philadelphia: <<https://libwww.freelibrary.org/digital/item/zoom/40609>>.

³ Philadelphia Deed Book: LRB.178.311 Amelia Copeland et al to German Evangelical Lutheran Church of Manayunk — 31st January 1866. [Conforms to Registry No. 092N130008].

5. BOUNDARY DESCRIPTION: THREE (3) CERTAIN CONTIGUOUS LOTS OR PIECES OF LAND.

Deed in tripartite endorsed Otto Franklin, Louis Grebe and Henry Kemper Trustees &c., and Henry Miller and Wife

THIS INDENTURE tripartite made the Sixth day of May in the year of our Lord One thousand eight hundred and fifty four BETWEEN OTTO FRANKLIN — LOUIS GREBE and HENRY KEMPER TRUSTEES named in the within Indenture of the first part, HENRY MILLER of Manayunk in the said City, weaver, and MARIA, his Wife, of the second part and “THE GERMAN EVANGELICAL LUTHERAN CHURCH of MANAYUNK” of the third part **WHEREAS**, in and by the within Indenture bearing date the twenty-fifth day of May Anno Domini 1849 intended to be herewith recorded the within named T. MASON MITCHELL and ANN E.S. his Wife did grant and convey unto the parties of the first part hereto in fee simple the within described lot of ground situate on the northwesterly side of Summer Street at a distance of fifty feet southwesterly from the southwesterly side of Prospect Avenue in Upper Manayunk containing in front or breadth on the said Summer Street seventy five feet and in length or depth one hundred feet Bounded and being as mentioned and described together with appurtenances **TO HOLD** the same **IN TRUST** among other things to convey the same to the parties of the third part hereto when and so soon as they should become incorporated And which incorporation took place on the sixth day of March last past A.D.1854 as will appear by articles duly recorded in the office for recording deeds &c. in miscellaneous Book T.H. No.1., page 60 &c.

AND WHEREAS certain members of the Church have purchased a Lot of ground from the party of the second part hereto containing in front on Summer Street ten feet and in depth one hundred feet along the north-east line of the premises above the within described for the purposes of burial lots to be attached to the church grounds of the parties of the third part hereto and to be held by them for the use and benefit of the said members **AND** it is the object of these present to convey and vest the whole of the said premises by this conveyance in the party of the third part hereto

NOW THIS INDENTURE WITNESSETH that the said party of the part hereto Trustees aforesaid in consideration of the premises and the sum of one dollar lawful money to them well and truly paid by “the German Evangelical Lutheran Church of Manayunk”...hereby acknowledged **HAVE** granted, bargained, sold, remise, released and confirmed and by these presents in pursuance and in execution of the Trust in the reposed and vested **DO** grant bargain, sell remise, release and confirm unto the German Evangelical Lutheran Church of Manayunk aforesaid their successors and assigns **ALL** that within and above described lot of ground containing in front on Summer Street seventy five feet and in depth one hundred feet Bounded and Being as above and within mentioned and set forth together with the church building or meeting house thereon erected and other appurtenances and the reversicas and remainders thereof and all the Estate Right Title Interest Property Claim and Demand whatsoever....

AND THIS INDENTURE further witnesseth that the said Henry Miller and Maria his Wife for and in consideration of the sum of seventy five dollars ... **HAVE** granted bargained sold and confirmed and by these presents...

All that lot of ground situate on the northwesterly side of Summer Street at a distance of forty feet southwesterly from the southwesterly side of Prospect Avenue containing in front or breadth on Summer Street ten feet in length or depth of that width at right angles to Summer Street one hundred feet bounded northeastwardly by the ground of T. Mason Mitchell southeastwardly by Summer Street and southwestwardly by the premises above and within described (Being the southwesternmost part of a larger lot of ground of which T. Mason Mitchell by Indenture dated the twenty ninth day of October A.D. 1852 recorded in Deed Book T.H. No.77 page 529 &c., granted and conveyed unto said Henry Miller) ...

And the said Henry Miller for himself his Heirs and Assigns doth by these Presents Covenant, Promise and agree to and with the said party of the third part hereto their successors and assigns in manner following to say that as respects the ten feet of his remainder ground which lies next to and adjoins the lot he now hereby conveys, there shall not at any time hereafter be built erected or placed any privies, styles or pig pens or stables of any description or other building for offensive use and that no building thereon placed shall at any time be converted into any such purposes. And in case such privies, pens or stables should be placed within ten feet of the line of the premises hereby granted then the party of the third part hereto their successors and assigns shall have the right to enter upon the adjoining ten feet and tear down abate and remove the same at all times as often as it occurs....⁴

⁴ Philadelphia Deed Book DWH.1468.533-535 Otto Franklin, et al to The German Evangelical Lutheran Church of Manayunk - 6th May 1854. [Conforms to Registry No. 092N130149 & Registry No. 092N130150] (Abstract of 1941).

5. BOUNDARY DESCRIPTION: THREE (3) CERTAIN CONTIGUOUS LOTS OR PIECES OF LAND

THE OTHER LOT OR PARCEL:

...**BY INDENTURE** made the twenty-fifth day of May in the year of Our Lord One Thousand eight hundred and forty nine, 1849, Between T. MASON MITCHELL of the City and County of Philadelphia, Conveyancer, and ANN E.S. his wife of the one part and OTTO FRANKLIN, LOUIS GREBE, and HENRY KEMPER all of the township of Roxborough in the county aforesaid Trustees as hereinafter mentioned of the other part at the time of the execution hereof of the receipt whereof is hereby acknowledged have granted bargained sold assigned aliened enfeoffed released conveyed and confirmed; and by the presents do grant bargain sell assign alien enfeoff release convey and confirm unto the said Otto Franklin, Louis Grebe, and Henry Kemper and to the survivors and survivor of them...

ALL THAT CERTAIN LOT or piece of ground situate on the north westwardly side of Summer Street (forty feet wide) at the distance of Fifty feet south westerly from the South Westerly side of Prospect Avenue in Upper Manayunk in the Township of Roxborough and County of Philadelphia aforesaid, Containing in front or breadth of Summer Street Seventy-five feet and extending in length or depth of that width between Parallel lines at right angles to the said Summer Street One hundred feet Bounded north eastwardly and north westwardly by other ground of the said T. Mason Mitchell, Southwestwardly by ground now or late of the said T. Mason Mitchell and South Eastwardly by Summer Street aforesaid. (The above described lot of Ground being composed of the whole of the Lot numbered One hundred and forty eight (148) and the adjoining moiety of half peat of the Lot numbered One hundred and forty nine (149) which are laid down and numbered on a certain map or plan of the said upper Manayunk; and which the said two lots of ground John C. Petchin and Margaret his Wife, by a certain Indenture bearing date the eighth day of November Anno Domini eighteen hundred and forty-one, recorded in Deed Book G.S. No.35 pg. 575 &c. did grant and convey (inter alia) unto the said T. Mason Mitchell in fee, as referenced thereto will appear)...

TO HAVE AND TO HOLD all and singular the hereditaments and premises hereby granted and assigned or mentioned as intended so to by with the appurtenances unto the said Otto Franklin, Louis Grebe and Henry Kemper... forever,

IN TRUST, nevertheless, to and for the uses, intents, and purposes following, to say: In Trust to hold the same to and for the use of the persons [incorporated] as “The German Evangelical Lutheran Church of Upper Manayunk in the Township of Roxborough and County of Philadelphia.” And **In Trust**, further, when and as soon as the said persons so associated shall have been incorporated, to convey the said premises with all the improvements and appurtenances unto them, and their successors and assigns in fee simple...⁵

The Burial Ground of The German Evangelical Lutheran Bethanien Church at Roxborough—Manayunk

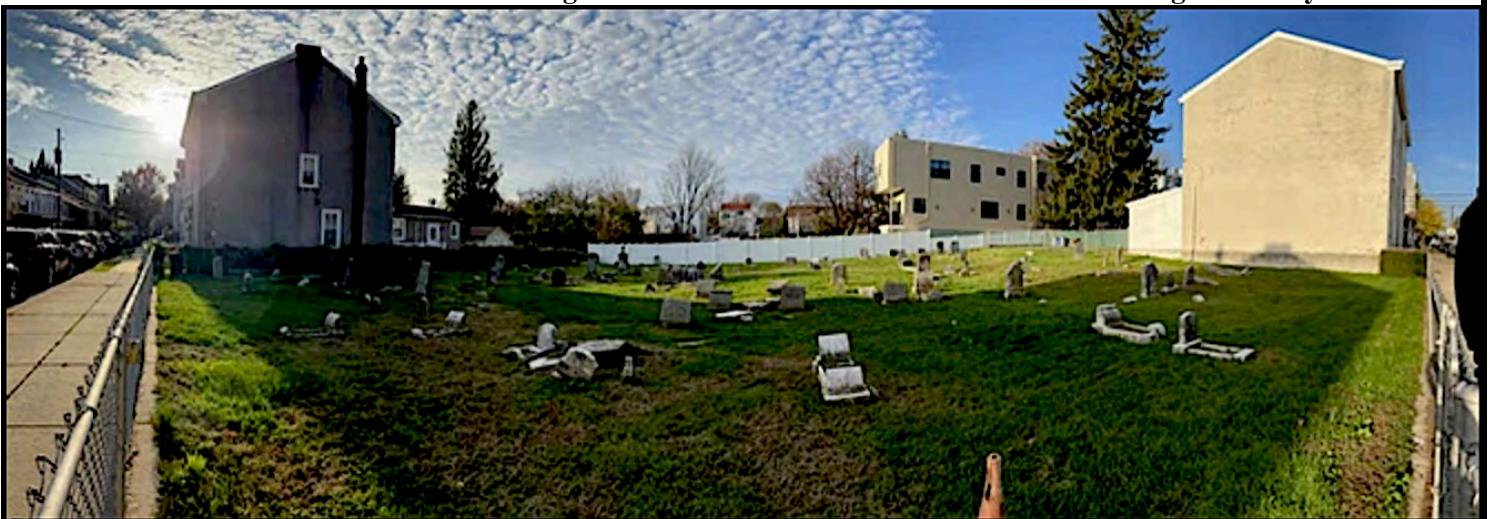

Image No. 10 – ©Photo Courtesy of The Roxborough, Manayunk & Wissahickon Historical Society.

⁵ Philadelphia Deed Book DWH.1468.530–532 T. Mason Mitchell et ux to Otto Franklin, et al – 25th May 1849. [Conforms to Registry No. 092N130149]. Abstract, Transcribed and Typed on 22nd December 1941.

6. DESCRIPTION: GERMAN EVANGELICAL LUTHERAN BETHANIEN CHURCH – MANAYUNK

“The Lutherans were the last of the major Protestant communions to enter the Twenty-first Ward area. German speaking Lutherans organized in 1845 and in 1848 bought the lot on Martin Street in Roxborough where their cemetery is now situated. Here the first church building was erected and dedicated in 1851...

There is no known photograph of the first German Evangelical Lutheran Church of Manayunk. It may have been a small single-story clapboard structure - lacking a basement, similar to the image below.



Image No. 11 – Dutch Hill School, Courtesy of Hillsdale Historical Society ⁶

A little Sunday School of eight children was also begun. A second and larger church building was dedicated in 1874. In 1889 a Sunday School for English-speaking Lutherans which had been begun at Temperance Hall, Mansion and Levering Streets, led to the establishing of an independent congregation worshipping entirely in English. Its members were drawn mainly from Bethanien (Bethany) Church and formed the Epiphany Lutheran Church.

In 1891 by an alteration in the charter the official name of the German Church became ‘The German Evangelical Lutheran Bethanien Church of Manayunk and Roxborough’...

English services were introduced in 1934, but German services continue to be largely attended...”⁷

⁶ Hillsdale Historical Society, Hillsdale, MI. <<https://www.hillsdalehistoricalsociety.org/early-hillsdale-schools>>.

⁷ Miles Joseph Starne and William H Cooper. *A Historical Sketch of Roxborough Manayunk Wissahickon*. G. Fein 1940. 188-189. Web. 17th November 2023. <<https://archive.org/details/historicalskech00mile>>.

6. DESCRIPTION — by Rev. Adolph Hellwege:

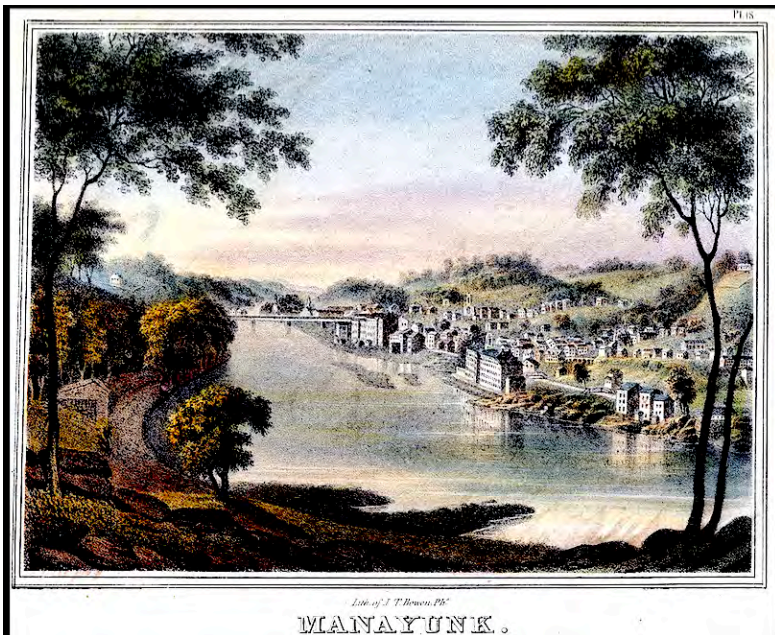

Image No. 12 – Manayunk, near Philadelphia By J. C. Wild
Courtesy of the Library Company of Philadelphia.

<<https://digital.librarycompany.org/islandora/object/digitool%3A64996>>.

Rev. Adolph Hellwege



Image No. 13 – Courtesy of the Nomination of St. Jakobus
German Evangelical Lutheran Church by the Keeping Society
of Philadelphia. Web. <<https://keepingphiladelphia.org/>>.

Manayunk and Roxborough.

At the time our church was founded, this area was not yet the 21st “ward” among the 40 “wards” in the metropolis of Philadelphia, but a very modest little village. Where today long rows of houses stretch out and the electric train runs on its tracks on well-paved streets, the first churchgoers still trudged through rough country roads and the first Sunday schoolchildren climbed around in the forest-like trees on their way to Sunday school when they went to the little church.

Manayunk is a Native American word meaning “water spring;” Roxborough is of English origin and means “rock village;” both meaningful names. This mountain peak is beautifully framed by the world-famous Wissahickon with its parks and the Schuylkill with its many industrial workshops.

It was the iron and woolen mills chiefly that brought the German population to this part of town, and as the Pencoyd ironworks grew and the wool, calico, velvet and paper mills were established here along the Schuylkill, so did more countrymen, also from Austria-Hungary, all business classes were represented...

At the time, the idea of building the church on Grape street and Silverwood street was being considered, but the chosen location on Martin street and Pechin street is so centrally located that churchgoers can't be uncomfortable approaching their church from all sides to reach; mountaineering is something everyone here is used to anyway, and our ancestors always liked to build their churches on mountain tops.

“Up there is the chapel, quietly looking down into the valley,” says the folk song, and it's worth something if the services aren't finished Railway and road rattles, as usual in cities, are disturbed in an unpleasant way. So it was wise to build the church on the rock of Roxborough, a symbol also of that which our Savior speaks of in the Sermon on the Mount, “Whoever builds his house on the rock (namely on the confession of Jesus Christ).

Manayunk easily accessible to “draw the water of life from the well of salvation” here in the church at the true “water source” and to cultivate brotherly love in this northernmost part of Philadelphia.”⁸

⁸ Hellwege Adolf. *Gemeinde-Geschichte Der Deutschen Evangelisch-Lutherischen Bethanien-Kirche ... Zu Roxborough Und Manayunk Philadelphia Pa.* 1899. P. 4-5. Web. Google Books in German Fraktur typeface. / Google-Translate.



Ordination.—On Sunday last, the 13th inst., the Rev. W. B. Rally was ordained as Pastor of the German Lutheran Church at Manayunk, by Dr. Demme, Pastor of the Lutheran Church of this city, by whom the sermon was preached in the morning. In the afternoon, the Trustees and Elders were duly installed by the Rev. Mr. Richards, of Germantown, who preached the sermon on the occasion. The choir connected with the German Lutheran Church of this city sang, in their usual excellent style, a number of beautiful pieces. The ceremony was witnessed by a large number of German Lutherans from the city, who attended by invitation. After the ceremonies of the morning had closed, the numerous guests proceeded, by invitation, to Quinton's hotel, and partook of a dinner specially provided for the occasion. The entire ceremonies of the day were imposing and solemn, and were fully appreciated by those who were present.

Image No. 14 – Public Ledger 15th July 1845.

Pastor Heinrich Melchior Mühlenberg is said to be the founder of the German Evangelical Lutheran Church in America who landed in Philadelphia in 1742 and put the still disordered church relationships on the right track and created an evangelical-Lutheran synod of Pennsylvania and neighboring states.

In his time, the 5th and Cherry was the first German-Lutheran St. Michaelis Church built. In 1769 the old Zion Church was inaugurated and 70 years later the St. Paul Church was built in the so-called "Northern Liberties." Anyone who wanted to go to church in our area or have official acts carried out had to make the long journey to those churches.

On 5th April 1845, the few evangelical residents of Manayunk came together for a congregational meeting and decided: "A German Evangelical-Lutheran congregation in the town of Manayunk, in the county of Philadelphia" and called the pastor Professor Rally to be their pastor from Richmond, Virginia.

On 6th April 1845 the newly chosen minister gave his inaugural sermon on Matthew 6:33: "Seek the kingdom first of God and according to His righteousness."

On the 8th Sunday after Trinity (13th July) 1845, the same was given by Dr. C. R. Demme, pastor of the Michaelis and Zion church, was solemnly inaugurated, with Ehrm. Professor Haverstick performed the altar service. 1 Corinthians 2:1-5 was the sermon and the topic: Paul, the model of an Evangelical Lutheran pastor.

In the afternoon, Pastor J.W. Reichert of Germantown introduced the first church council of the congregation. Elders: Joh. Koch, President; G. Louis Grebe, secretary; Philipp Becker, treasurer. Directors: Johann Astfalk, Friedrich Dräse, Samuel Farell, Heinrich Köhl, Christian Schnorr, Christoph Wenzel.

The baptism, confirmation, and burial register began in 1844. The first confirmation took place in the fall 1846, when 8 confirmands were consecrated, who had already been taught by a newly appointed pastor C. R. Kessler were. It seemed as if the young sprout of this new community would not yet thrive; it threatened to wither again; until 21st June 1848 Pastor A. T. Geissenhainer, from the Evangelical Lutheran Synod of Pennsylvania was commissioned to seek out the Germans in Manayunk, Conshahocken, etc., and seek to collect them.

On 15th February 1849, regular church council and community minutes began. In the introduction it is noted that all the Protestant Germans got together, "but since the majority of the Protestants living in Manayunk at that time belong to the Lutheran faith, the church should also be given the name Lutheran for all time." - At the same time, however, a "church association" was founded, to which all Protestants, Reformed or Lutheran, could join in order to receive a church building fund, to which each member committed himself to contribute 12 cents a month. They look around for a church building site, and Mr. George Mitschel (Michael), always well disposed towards this congregation, gives her a plot of land on what is now Martin street, now a burial ground for the members of the congregation, for the cheap price of \$145. Meanwhile, Pastor C. C. A. Brandt was called to officiate from Trenton, NJ, once a month for a year in return for travel expenses in a rented facility, Temperance Hall.

On 1st April 1850, the cornerstone was laid for the first little church, which was to be 30 feet by 40 feet, and one story, with about 200 seats...⁹

⁹ Hellwege Adolf. P. 5-7. Web. Google Books. German Fraktur typeface. / Google-Translate.

6. DESCRIPTION — by Rev. Adolph Hellwege:

A written ecclesiastical order was placed in the cornerstone; and pastors Bibigfuss of Philadelphia, Anspach of Barrenhill, and Wagner of Norristown presided the act of consecration, raising a collection of \$34.21. The Evangelical Lutheran Synod approved \$75 from the fog "Streitschen Legate" as a contribution to the building of the church.

On 25th August 1850, Pastor C.C.A. Brandt consecrated the surrounding cemetery and buried the two-year-old Luise Müller, daughter of Heinrich Müller, as the first dead. The funeral expenses initially had to be paid in the range of \$1.50 to \$2.00.

On 21st October, Pastor Dr. Demme from the Michael Church, in the name and on behalf of the Evangelical Lutheran Synod of Pennsylvania the church council following the reverse, which they signed. *war: We the undersigned, church councils of the Evangelical-Luth. Congregation in Manayunk hereby confirm that the church founded by the congregation there in 1850 should be and remain a German evangelical-lutheric church for all time, whereupon Pastor Demme handed over \$50.00 for the construction of the church.*

Now the women of the congregation also got together and formed an association to provide support and assistance in the construction of the church. Here we find the first beginnings of a women's association, which, however, went astray again and only blossomed in the last two decades. Mrs. Christine Schnorr was President, Philippine Meier, Secretary, and Luise Nachtigall, Schahmeister.

The "Youth Mission Society" of Philadelphia donated \$128 and valuable items to the young congregation, for which the church council entered the following worthwhile resolutions in the minutes as a thank you: *Never may our descendants forget what this club did to our church, and should the call to if you indulge in helping poor German communities, show that your ancestors and you were not unworthy of the support we enjoyed.*

During 1851 Pastor F. Walk took over from Wilmington, Delaware, agreed to preach in the hall every three weeks, for which he received \$3 each time. Under him the finished house of God was inaugurated on 6th April 1851 with a morning service in the presence of a large congregation and participating fellow citizens; in the afternoon an after-party was held, and on 4th May 1851, a Sunday school with 8 children was organized and opened.

On 16th September 1851, the congregation called Pastor Gerwig, who moved to Cincinnati on 23rd November. Until 18th January, the candidates Kruck and Schmauck preached alternately when Pastor B. Schifterling took office, who had to give his farewell sermon that same year, on 3rd September 1852. His successor was Pastor L. W. Heidenreich, who remained until the following year, 27th March 1853.

Now Pastor G. F. Gärtner was called, who held office for three years until 16th November 1856. In his time he gave the plot of land to the so-called old rectory with the condition that a rectory be built on it. Since building materials were cheap in those days and church members helped out without compensation, the same could be built for the cheap price of \$1010.00.

A strange resolution can be found in the minutes around this time, June 1856: *Resolved that evening services should not be introduced, as the church council is of the opinion that they could lead the youth to immorality rather than to virtue.* Today it is unlikely that anyone will approve of this resolution.

If all young people really do morning service would attend or could attend, and if such a decision could prevent the easily misled youth from running into the English sectarian churches, which keep their doors wide open in the evening, then it would probably be more correct if the whole congregation worshiped in the morning, because *morning hour has gold in Mouth.*

But God grant that only all young people could also be found in the evening service, and if the older people also wanted to go along to look after their youth, then it is a precious thing to thank the Lord - *Your grace in the morning, and proclaim your truth at night...*¹⁰ [The Church History Continues.]

¹⁰ Hellwege Adolf. P. 7-10. Web. Google Books/Translate. (19th Century German idioms may be misunderstood today).

7. STATEMENT OF SIGNIFICANCE

The German Evangelical Lutheran Bethanien Burial Ground, established circa 1850, situate 376–378 Martin Street, City of Philadelphia, State of Pennsylvania in Manayunk, formerly an incorporated borough within the Township of Roxborough is an extremely significant historical site, merits designation by the Philadelphia Historical Commission and inclusion on the Philadelphia Register of Historic Places, satisfying Criterion A, I and J as enumerated in Section 14-1004 of the Philadelphia Code:

- (A) Has significant character, interest or value as part of the development, heritage, or cultural characteristics of the City, Commonwealth, or Nation, or is associated with the lives of persons significant in the past; or,
- (I) Has yielded, or may be likely to yield, archaeological information important in history.
- (J) Exemplifies the cultural, social or historical heritage of the community.

Bethanien Church Corner of Martin and Pechin Streets at Roxborough—Manayunk



Image No. 15 – City Atlas of Philadelphia, 21st & 28th Wards, 1875, Plate B - G.M. Hopkins, C.E.

Free Library of Philadelphia. Web. 13th Dec. 2023. <<https://libwww.freelibrary.org/digital/item/zoom/40088>>.

7. SIGNIFICANT PERSONS: *THE GERMAN-SPEAKING*

LUTHERAN IMMIGRANTS



Image No. 16 – Map of European origins of German-speaking immigrants to Pennsylvania (in blue), Courtesy, Winterthur Museum; artwork, Tom Willcockson, <http://www.mapcraft.com/index.html> [Cit. Minardi, as Fig.18]

“...Most Lutheran and Reformed immigrants came from the Palatinate, Kraichgau, and Württemberg regions of southwestern Germany as well as the Alsatian region of eastern France. The Mennonites and Amish came primarily from the German-speaking cantons of Bern and Zurich in Switzerland, the Moravians from Bohemia and Moravia, and the Schwenkfelders from Silesia (modern-day Poland). Before these immigrants could become Pennsylvania German, they had to develop a shared sense of German identity. This process began during their shared migration experiences and was fostered by participation in German-speaking churches and organizations such as the German Society of Pennsylvania (est. 1764) or the German-speaking Hermann Masonic Lodge no. 125 (est. 1811)...”¹¹

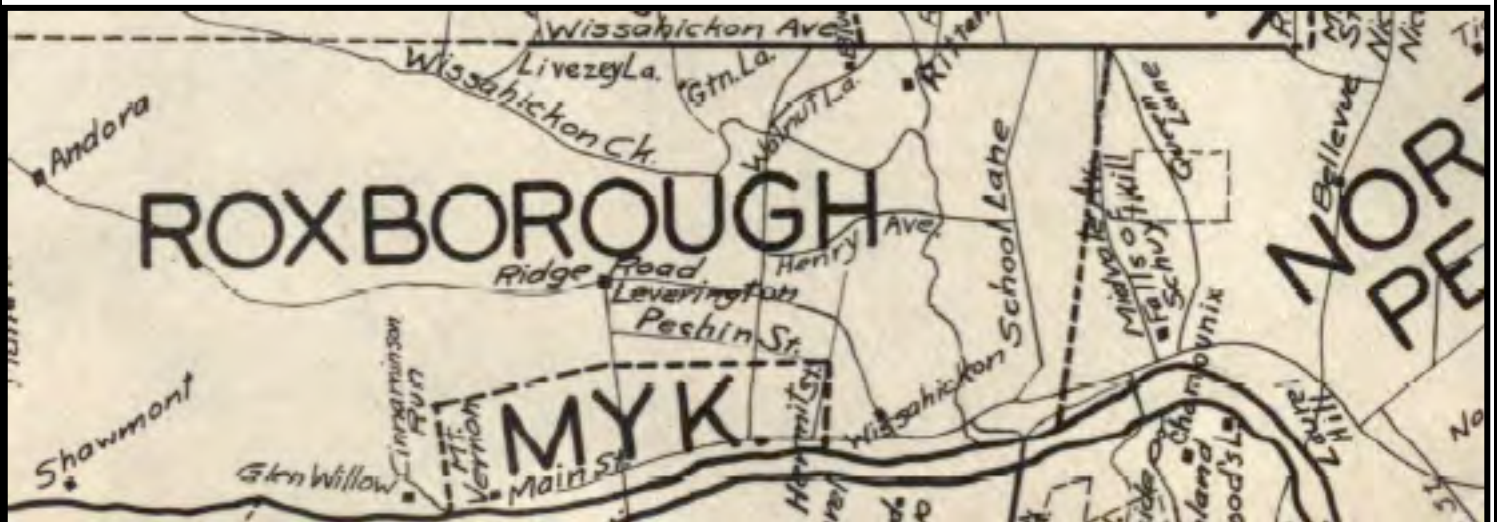

Image No. 17 – Campbell, William B. *Old Towns and Districts of Philadelphia*: City History Society, 1942.

¹¹ Minardi, Lisa. 2013. “Philadelphia, Furniture, and the Pennsylvania Germans: A Reevaluation.” *American Furniture*, Luke Beckerdite, ed. Milwaukee. <<https://chipstone.org/issue.php/34/American-Furniture-2013>>. Excerpt F/n. No.9 [Note: The Appendix contains additional information on the area’s German-Speaking Lutheran Immigrants].

7. MEMBERS OF THE GERMAN EVANGELICAL LUTHERAN CHURCH OF MANAYUNK

... Incorporated... Under the name *Stile and Title of the German Evangelical Lutheran Church of Manayunk*, Trustees:

List of Members of the Community.
From 1845---1899.

Heinrich Kemper, Ch[ristian] Rubig,
Louis Grebe, Jacob Kram,
Louis Kraemer, Otto Franklin,
Nikolaus Meister Bernhard Beust and
Edward Nachtigall.¹²

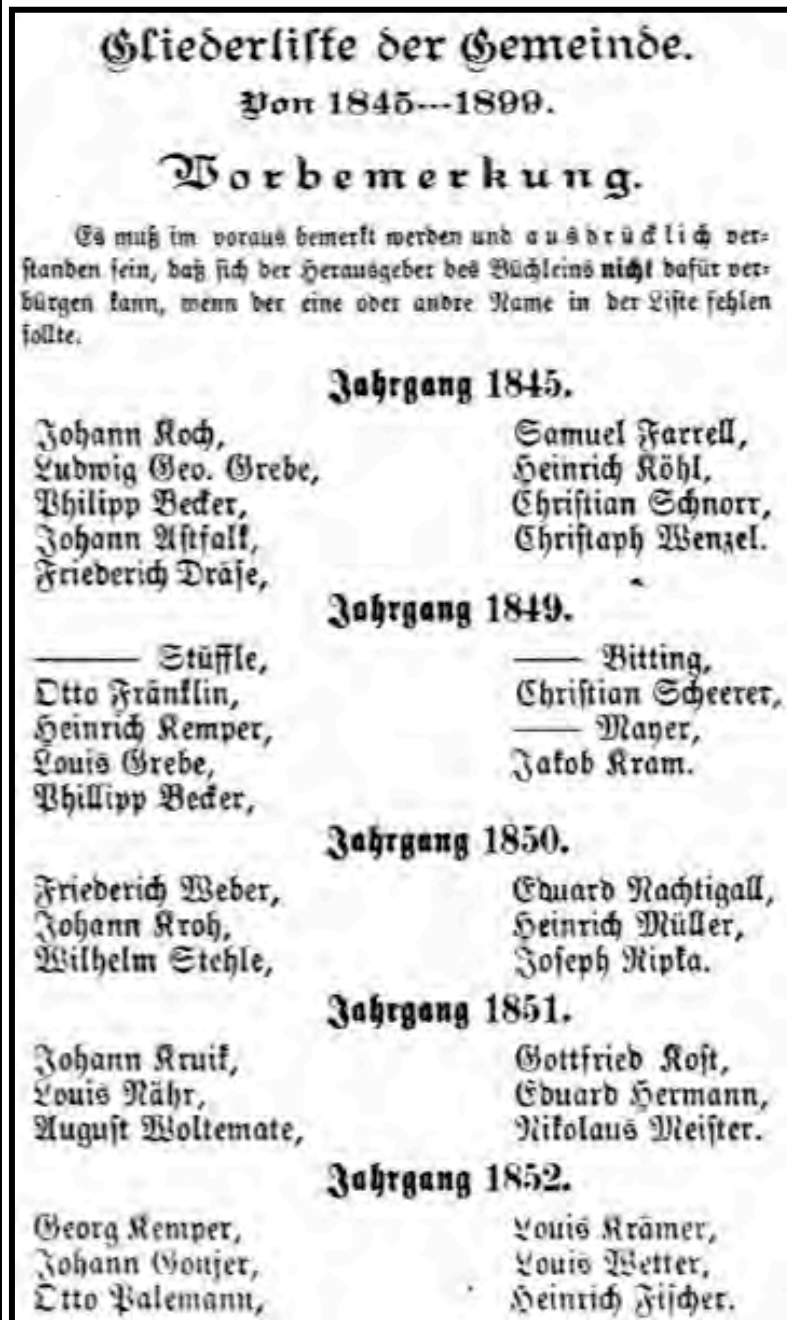

Louis Grebe & Jacob Kraemer, trustees, became partners in a mill located in Berks County, Pa.

“At the base of Mt. Penn stands historic Aulenbach Cemetery, in which many notable Germans are buried. Louis Grebe worked for Louis Kraemer and Company Woolen Mills in Stony Creek, which prided itself on the fact that its output of mens’ Stony Creek Trousers was 1,200 pairs a day. The trousers were known the world over. Louis Grebe was born in Westphalia, Germany and came to the US as a young man. His occupation was as an indigo dyer.¹³ He also worked in Manayunk as superintendent of Pekin Mills.”¹⁴

“Louis Kraemer, the father, was born at Berleberg, in the province of Westphalia, Germany, on Jan. 2, 1828, and was brought up and educated in that place. He learned the trade of dyeing at Barmen on the Rhine River, a prominent textile-manufacturing town. Upon completing a thorough apprenticeship, he emigrated to Pennsylvania in 1848, while still under age, and located at Manayunk, where he secured the position of dyer in the manufacturing plant of Joseph Ripka.”¹⁵

“An enhanced pen-and-ink drawing by Berks County artist J. Heyl Raser shows the Louis Kraemer & Co. mills, which was located in Stony Creek Mills where the current Antietam Road is, across from the intersection of Friedensburg and Antietam roads in Lower Alsace Township. The first mill constructed on the site was a paper mill erected by Conrad Feger.”¹⁶

← [NOTE: Other notable *Members of the Community* who were not mentioned may be found in this book].

Image No. 18 – Courtesy of Rev. Adolf Hellwege, Page 60.

¹² Miscellaneous Book T.H. No.1, page 60 &c. Accessed: Philadelphia City Archives 27th June 2023.

¹³ Reading Liederkranz - German Singing & Sport Society Newsletter. January 2017. 16. Web. 12th October 2023. <<https://www.readingliederkranz.com/newsletters>>.

¹⁴ Pekin Mills, River Road & Canal (Schuylkill River) Manayunk. Hexamer General Surveys, Vol.14. Web. 12th Oct. 2023. <<https://www.philageohistory.org/rdic-images/view-image.cfm/HGSv14.1325-1326>>.

¹⁵ Montgomery Morton L and J.H. Beers & Co. *Historical and Biographical Annals of Berks County Pennsylvania Embracing a Concise History of the County and a Genealogical and Biographical Record of Representative Families*. J.H. Beers. 1909. 348-349. Web. 12th October 2023. <<https://archive.org/details/cu31924097286300/mode/2up>>.

¹⁶ Reading Eagle, 12th Oct. 2023. <<https://www.readingeagle.com/2021/11/22/berks-places-stony-creek-mills-history/>>.

7. SIGNIFICANT PERSONS: UNION VETERANS OF THE CIVIL WAR — IN THE BURIAL GROUND

Summe der Amtshandlungen von 1845—1899.

Taufen: 2169.
 Konfirmanden: 872.
 Trauungen: 604.
 Begräbnisse: 802.

Von diesen Amtshandlungen sind in den letzten 8 Jahren (1891 bis 1899) vollzogen worden von P. A. Hellwege:

Taufen: 577.
 Konfirmanden: 254.
 Trauungen: 151.
 Begräbnisse: 242.

Sum of Official Acts from 1845—1899.

Baptisms: 2169.
 Confirmations: 872.
 Weddings: 604.
 Burials: 802.

These official acts were carried out in the Last 8 years (1891 to 1899) by P. A. Hellwege:

Baptisms: 577.
 Confirmations: 254.
 Weddings: 151.
 Burials: 242.

Image No. 19 – Courtesy of Rev. Adolf Hellwege, Page 75

PHILADELPHIA, THURSDAY, MAY 31, 1900 — Copyright, 1900, by The Philadelphia Inquirer Co.

SOFTLY FELL BRIGHT FLOWERS ON THE GRAVES OF DEAD HEROES

Fast Thinning Army of Civil War Veterans Observed Memorial Day's Labors of Love and Honor Towards Departed Comrades



ROXBOROUGH AND MANAYUNK
Hettie Jones Post and General Warren Post Spent a Busy Day
 The soldiers' graves in all the cemeteries of Roxborough and Manayunk were cared for, as in the past, by Hettie A. Jones Post, 12, G. A. R., of Roxborough, and General G. K. Warren Post, No. 15, G. A. R., of Manayunk. Every church and building in that section was bedecked with the national colors intermingled with crepe drapings in memory of the dead.
 Post 12, assisted by Sam Clegg Camp, No. 9, Sons of Veterans, and Sam Clegg Guards, decorated graves in the following cemeteries in the morning: St. Timothy's, 8 graves; Bethany Lutheran, 12 graves; St. Mary's Catholic, Lenoxe street, 34 graves, and Roxborough Presbyterian, 12 graves. After lunch served at the post hall, Fountain street and Ridge avenue, by the Women's Relief Corps, No. 124, they marched over the following route in the afternoon, accompanied by Washington Military Band and a mounted escort and marshaled by John Frantz: Ridge avenue to Green lane, to Manayunk avenue, to Martin street, to Pechin street, to Lyceum avenue, to Leverington avenue, where memorial exercises were held at the soldiers' monument and 500 graves were decorated. The orators were Rev. John E. Reber, of Emanuel M. E. Church, Manayunk, and former chaplain of the Third Regiment, Pennsylvania Volunteers, and Rev. A. M. Vivien, of Wissahickon M. E. Church. There was singing of patriotic airs by a chorus of thirty children from Roxborough Baptist Church led by Samuel Birkinire.
 In Manayunk General G. K. Warren Post met at Post Hall at 9 A. M. and decorated graves in the following cemeteries: St. David's, 22 graves; St. Mary's, Conarroe street, 1 grave; Fourth Reformed Church, 29 graves, and St. John the Baptist's Catholic Church, 85 graves. After lunch was served at the post headquarters by the Ladies' Aid the post, in company with the Independent Rifles and Post 15 Pipe and Drum Corps, paraded through the streets as follows: Down Carson street to Main street, to Rector street, countermarch to Westminster Cemetery. The memorial exercises were conducted there at the soldiers' monument. Rev. Patrick J. Kaln, of Fourth Reformed Church, and a member of Wadsworth Post, No. 159, G. A. R., of Stroudsburg, Pa., was the orator.

U. S. A. R. MEN FIRING SALUTES OVER THE GRAVES OF THEIR DEAD COMRADES

Image No. 20 – Hettie A. Jones Post No. 12 & General Warren Post No. 15, Grand Army of the Republic Decorate The Graves of Civil War Veterans. Philadelphia Inquirer 31st May 1900. FLP. Web. <<https://www.freelibrary.org/>>.¹⁷

¹⁷ Civil War Soldiers in *Bethany Lutheran Graveyard* are missing headstones — Their names remain a mystery.

SUMMARY: DECLINE OF THE GERMAN CHURCH — VETO OF A GERMAN NEWSPAPER BILL ANGLICIZATION OF THE GERMAN-SPEAKING IMMIGRANTS¹⁸

A DANGEROUS CRISIS

“For the distant existence of this German Evangelical Lutheran congregation came to light in the next few years. With praiseworthy zeal, Pastor Gardner set to work. Possessing organizational talent, he was able to introduce better order into the Sunday School and Luther Association which he created. The number of teachers grew to 33 and the number of students to 250. The congregation owes the spacious, stately new parsonage next to the church to his active work. But church attendance declined alarmingly. He himself complained in the “Community-News” that only 67 members entitled to vote had taken part in Holy Communion during the year, and that of 548 confirmed members only 275 had come to the Lord’s Table.

Where did this come from? A very justified distrust, caused by a few Englishizing elements, at whose spite the pastor unfortunately allowed himself to be pushed, had been generated in the members of our German church. With how many sacrifices, through how many worries and struggles the Germans had won their stately, valuable church property. And now the congregation was blossoming outwardly, the number of German members was sufficient to maintain what had been acquired, so that the Gospel could be preached in the dear, dear German mother tongue for future immigrants, and sung and prayed in German, half a dozen dissatisfied people rose up and demanded the introduction of English evening services.

A very understanding and wise church council firmly rejected this unreasonable request, and almost the entire congregation sided with it. They rightly saw in this movement a betrayal of their rights, and bitter experiences, which many other communities had already made in this area, and which still led to the Germans finally being forced out of their property and having to start all over again taught them to be on their guard.

Naturally, the members of this congregation had no objection to the establishment of an independent English Lutheran Church, and so the few English-speaking members moved to Temperance Hall and organized themselves as the English Epiphany Lutheran Church. Initially, Pastor Gardner led the services until they obtained their own English pastor in the person of Pastor Geschwind. Since Pastor Gardner realized that further blessed and unanimous work here was no longer possible, he resigned...”¹⁹

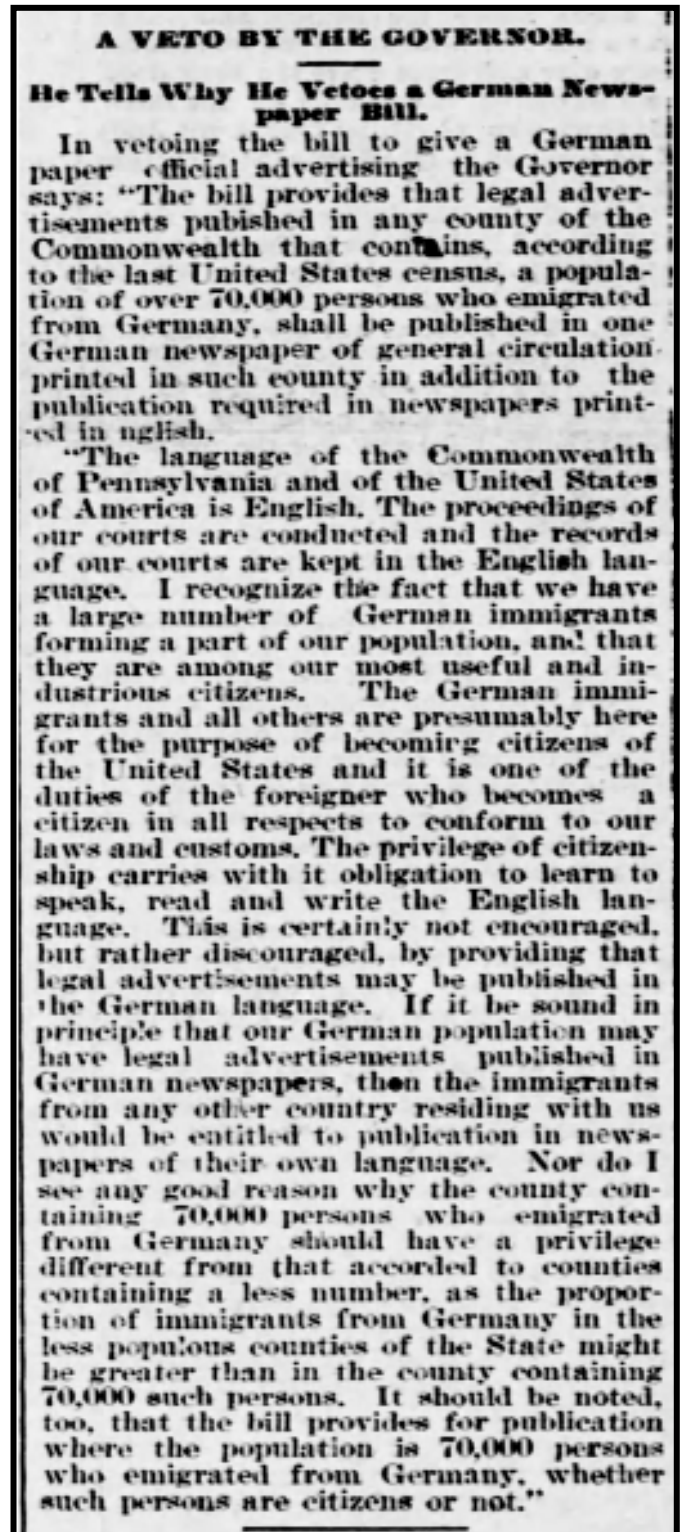

Image No. 21— Harrisburg Telegraph 10th July 1897.

¹⁸ Rosalind J. Beiler, German-Speaking Immigrants in the British Atlantic World, 1680–1730, *OAH Magazine of History*, Volume 18, Issue 3, April 2004, Extract. <<https://academic.oup.com/maghis/article-abstract/18/3/19/1033073>>.

¹⁹ Hellwege Adolf. *Gemeinde-Geschichte Der Deutschen Evangelisch-Lutherischen Bethanien-Kirche ... Zu Roxborough Und Manayunk Philadelphia Pa.* 1899. 15-18. Translation by DeepL. Web. <<https://www.deepl.com/en/translator>>.

Three Wilmingtonians and four residents of Arden were all that went on the peace mission to Washington today. They included Rev. Sigmund G. Von-Bosse, a minister of this city, who has been active in pro-German letter writing. Those who went on the special peace train were Miss Margaret H. Shearman and John S. Downing, of Wilmington; J. Frank Stevens, Don G. Stevens, Edward S. Potter and Miss Rhoades, of Arden.

Image No. 22 – Philadelphia Inquirer, 3rd April 1917

Prior to his appointment as pastor of Bethany German Lutheran Church at Roxborough, the Rev. Sigmund von Bosse had served as president of National German American Alliance.²⁰

Reverend S. G. Von Bosse's political associations and activities during World War II ended as an embarrassment to the German Society of Pennsylvania and proved detrimental to many of the German-Speaking Churches.

Bible Classes Start Wednesday

The fifth season of the Roxborough Community Daily Vacation Bible School will be held at First M. E. Church, Green lane, Roxborough, beginning Wednesday and continuing to July 30.

The leading topic for this year's studies will be taken from the "Decalogue," and Pastors W. H. Cooper, of Grace Lutheran Church; R. P. Mallery, of Fourth Reformed Church, and Marion G. Gosselink, of Talmage Reformed Church, will teach the older grades.

There will be four departments under the supervision of a staff of 10 teachers. Rev. S. G. von Bosse, of Bethany Lutheran Church, is superintendent. The school is supported by 10 local churches and last year had an enrollment of 225 pupils.

Image No. 23 – Phila. Inquirer, 3rd July 1937.

THE PHILADELPHIA INQUIRER. THURSDAY MORNING. AUGUST 14, 1941

TELLS OF WARNING TO PRO-NAZI PASTOR

German Society Head Says Church Was Embarrassed

So emphatic were the pro-Nazi utterances of Rev. Sigmund G. von Bosse, Roxborough pastor who mysteriously disappeared recently, that they embarrassed members of his congregation at the Bethanien German Lutheran Church.

That was disclosed yesterday by Captain Louis H. Schmidt, 73-year-old president of the German Society of Pennsylvania, of which von Bosse was secretary.

'WENT TOO FAR'

Schmidt said he had received a letter of resignation from the society from von Bosse on Aug. 6, a few days before the pastor vanished from his home at 4351 Pechin st., Roxborough.



Image No. 24 – Philadelphia Inquirer. 14th August 1941.

²⁰ National German-American Alliance. Web. <https://findingaids.library.upenn.edu/records/GSP_GSP.MS.COL.58>.

SUMMARY & OPINION: THE DECLINE OF THE GERMAN CHURCH IN MANAYUNK

THE SPIRIT OF THE AGE IS CHANGING ²¹

“The primary cause of their decline came from an aging congregation whose children had moved away from the parish. The congregation had become assimilated and thus the sacraments no longer required the German language to be understood, confession, last rites, communion, and baptism, etc. Clergy morality played no part in the decline. But ethnic parishes catering to the needs of the Poles, Germans, Italians, etc. had declined. Considering the fact that so many of these ethnic churches were within a few blocks of each other, the archdiocese decided to merge them with nearby English language parishes and use the equity of their parish real estate to add to their legal coffers. Sunday attendance declined along with the weekly collection from the plate, and this forced tapping the principle of any endowment fund. With its income greatly reduced the Lutheran Synod tried merging Epiphany, Grace, and Bethany into a single parish. But each congregation wanted the merger to include any merging with their own parish. In time Grace decided to disband and close, whilst Epiphany had a building with a termite problem left unattended far too long and sought co-usage with the nearby Episcopal Church of Saint Alban, hoping to use that church in the afternoon. When negotiations failed to reach an agreement, Epiphany finally disbanded and the Synod sold off their real estate. This left Bethany as the sole surviving Lutheran Church in Roxborough. With a greatly reduced congregation coupled with a large loss of income, the end was inevitable.”

Opinion — Roxborough Historian.²²

²¹ A primary reason for the suspicion of the direction of the Church in Germany is that the same efforts to embrace the *zeitgeist* failed in the United States forty years ago and continue to fail today. — Henricks, Jayd. “An American perspective on the situation of the Church in Germany” 2023. *Catholic World Report*. Web. 22 February 2024. <<https://www.catholicworldreport.com/author/henricks-jayd/>>.

²² Manton, John Charles. <<https://search.worldcat.org/search?q=%22Manton%2C+John+C%22&offset=1>>.

The Site situates 376–378 Martin Street, formerly the German Evangelical Lutheran Bethanien Church of Roxborough-Manayunk, but now a Burial Ground is an extremely significant historic site.

The site contains (an estimate) about one hundred man-made monuments, structures or grave-markers. According to Pastor Adolf Hellwege, nearly one thousand burials were recorded by the turn of the 20th Century. A chain link fence four foot in height currently encloses the site. Because the site predates modern utilities, it may contain an ancient privy along with the remnants of the demolished church building and thus possess a high potential for significant archaeological resources.

This site is an irreplaceable historical asset satisfying Criteria for Designation a, i, and j, as enumerated in Section 14-1004 of the Philadelphia Code meriting historic designation and placement onto the Philadelphia Register of Historic Places:

Satisfying Criterion A

- for its significant character, interest or value as part of the development, heritage, or cultural characteristics of the city, commonwealth, or nation, for its association with the lives of persons significant in the past;

Satisfying Criterion I

- as a site that was largely settled in the mid-nineteenth century, containing a demolished German Lutheran Church, its church-yard is now used a burial ground, it has an extremely high potential for discovery of significant archaeological resources & artifacts.

Satisfying Criterion J

- for exemplifying the cultural, political, economic, social or historical heritage of the community by its connections through its ministers, trustees and its congregants, German-speaking immigrants, who were mill workers and mill-owners - they participated in the development of the Manayunk and Roxborough section of Philadelphia;

Satisfying Criterion J

- for its connections to the faithful German-American Lutherans who fought for the United States of America throughout various wars and conflicts, many who are currently interred at this site, it exemplifies the cultural, political, economic, social historical heritage of the community.

8. MAJOR BIBLIOGRAPICAL REFRENCES

- Campbell, William B. *Old Towns and Districts of Philadelphia: An Address Delivered Before the City History Society of Philadelphia, February 26, 1941*. Philadelphia: City History Society of Philadelphia, 1942. Web. 6th December 2017. <<https://collection1.libraries.psu.edu/cdm/ref/collection/digitalbks2/id/19978>>.
- Childs, Cephas G. *Views in Philadelphia and Its Vicinity: Engraved from Original Drawings*. Philadelphia: Published by C.G. Childs, Engraver, 1827. Web. 15th December 2017. <<https://archive.org/details/viewsinphiladelp00phil>>.
- Fisher, Elizabeth W. "Prophesies and Revelations": German Cabbalists in Early Pennsylvania' *The Pennsylvania Magazine of History and Biography*. 109.3 (1985). Web. 17th December 2023. <<http://journals.psu.edu/pmhb/article/download/44064/43785>>.
- Hagner, Charles V. *Early History of the Falls of Schuylkill, Manayunk, Schuylkill and Lehigh Navigation Companies, Fairmount Waterworks, Etc.* Philadelphia: Claxton, Remsen and Haffelfinger, 1869. Web. 05th June 2018. <<https://archive.org/details/earlyhistoryoffa00hagn>>.
- Hellwege Adolf. *Gemeinde-Geschichte Der Deutschen Evangelisch-Lutherischen Bethanien-Kirche ... Zu Roxborough Und Manayunk Philadelphia Pa.* 1899. Web. Google Books.
- Hotchkin, S F. *Country Clergy of Pennsylvania*. Phila.: P.W. Ziegler, 1890. Web. 5th February 2018. <<https://archive.org/details/countryclergyofp00hotc>>.
- Manton, John C. *Bygones: A Guide to Historic Roxborough-Manayunk*. Phila. Pa. J.C. Manton, 1990. Web. 30th May 2018. [[Google Books](#)].
- Miles Joseph Starne and William H Cooper. *A Historical Sketch of Roxborough Manayunk Wissahickon*. G. Fein 1940. Web. 17th November 2023. <<https://archive.org/details/historicalskech00mile>>.
- Minardi, Lisa. 2013. "Philadelphia, Furniture, and the Pennsylvania Germans: A Reevaluation." *American Furniture*, Luke Beckerdite, ed. Milwaukee. <<https://chipstone.org/issue.php/34/American-Furniture-2013>>. Excerpt F/n. No.9
- Montgomery Morton L and J.H. Beers & Co. *Historical and Biographical Annals of Berks County Pennsylvania Embracing a Concise History of the County and a Genealogical and Biographical Record of Representative Families*. J.H. Beers. 1909. Web. 12th October 2023. <<https://archive.org/details/cu31924097286300/mode/2up>>.
- Philadelphia (Mt Airy) Lutheran Theological Seminary et al. *The Philadelphia Seminary Biographical Record 1864-1923*. Publisher Not Identified 1923. Web. 22nd February 2024. <<https://archive.org/details/philadelphiasemi00phil/mode/2up>>.
- Rendon, Mary J. *Manayunk As a Historic District.*, 1987. Web. 6th June 2018. <<https://archive.org/details/manayunkashistor00rend>>.
- Schmieder, Claire G. and Emily T. Cooperman. "Roxborough and Manayunk," Historic Context Statement for Neighborhood Cluster 2. Preservation Alliance, 2008-2009. Web. 12th October 2108. <<http://www.preservationalliance.com/wp-content/uploads/2014/09/HCSCluster2.pdf>>.
- Scranton, Philip. "An Immigrant Family & Industrial Enterprise: Sevill Schofield & the Philadelphia Textile Manufacture, 1845-1900." *The Pennsylvania Magazine of History and Biography*. 106.3 (1982): Web. 6th June 2018. <<https://journals.psu.edu/pmhb/article/view/43834/43555>>.
- Scranton, Philip. *Proprietary Capitalism: the Textile Manufacture at Philadelphia, 1800-1885*. 1983. Acc. 6th June 2018.
- Shelton, Cynthia J. *The Mills of Manayunk*. Baltimore: The Johns Hopkins University Press, 1986. Access: 6th June 2018.
- The Pennsylvania Magazine of History and Biography*. 109.3 (1985). Web. 17th December 2023. <<http://journals.psu.edu/pmhb/article/download/44064/43785>>.

OTHER WEB RESOURCES

DeepL. Translation Generator. Web. <<https://www.deepl.com/en/translator>>.

Free Library of Philadelphia: Philadelphia Inquirer & Maps.

Google Search, Google Books, Google Maps, Google Translate.

Greater Philadelphia GeoHistory Network. <<http://www.philageohistory.org/>>.

Historic Preservation Recommendations for the Upper Northwest Planning District.

<https://chconservancy.org/wp-content/uploads/2018/06/UNW_historicpreservation_recommendations_PHC.pdf>.

Library Company of Philadelphia. <<https://librarycompany.org/>>.

Lloyd Bowers. <<https://lloydbowers.com/Blog.html>>.

Maps Philadelphia Register of Historic Places:

<<https://phl.maps.arcgis.com/apps/View/index.html?appid=0a0b23447b6b4f7097d59c580b9045fe>>.

National German-American Alliance. Web. <https://findingaids.library.upenn.edu/records/GSP_GSP.MS.COLL.58>.

Nomination of St. David's P. E. Church of Manayunk. 65-70. *Historical Overview of Roxborough and Manayunk*. Web. 22nd October 2018. <<https://www.phila.gov/media/20201013081534/150-Dupont-St-nomination.pdf>>.

Philadelphia Archaeological Forum. Web. <<https://www.phillyarchaeology.net/paf-activities/burial-places-forum/>>.

Philadelphia2035 Lower Northwest District Plan. Web. 9 July 2023 <<https://www.phila2035.org/lower-northwest>>.

Philadelphia Grantor Index: <<https://epay.phila-records.com/phillyepay/web/login.jsp>>.

Reading Eagle, 12th Oct. 2023. <<https://www.readingeagle.com/2021/11/22/berks-places-stony-creek-mills-history/>>.

Reading Liederkrantz - German Singing & Sport Society Newsletter. January 2017. Web. 12th October 2023.

<<https://www.readingliederkrantz.com/newsletters>>.

RG-17. Records of the Land Office, Pennsylvania State Archives. Web. 9th November 2023.

<<https://www.phmc.state.pa.us/bah/dam/rg/di/r17-114CopiedSurveyBooks/r17-114MainInterfacePage.htm>>.

Ridge Avenue Roxborough Thematic Historic District Nomination. Web. 17th August 2023.

<<https://www.phila.gov/media/20190213131353/Thematic-District-Ridge-Ave-Roxborough.pdf>>.

Roxborough Manayunk Wissahickon Historical Society. <<https://www.rmwhs.org/>>.

The Germans in America Chronology. Accessed 9th November 2023. Library of Congress. Web.

<<https://www.loc.gov/rr/european/imde/germchro.html>>.

The Keeping Society of Philadelphia. Web. <<https://keepingphiladelphia.org/>>.

The Roxborough, Manayunk & Wissahickon Historical Society.

Victorian Roxborough Historic District. <<https://www.phila.gov/media/20220601135612/Historic-District-Victorian-Roxborough.pdf>>.

Workshop of The World. (Manayunk). <<http://workshopoftheworld.com/manayunk/blantyre.html>>.

APPENDIX: A PENNSYLVANIA COMMUNITY-TOWNSHIP FOUNDED FOR THE GERMANS ²³

1683 - Thirteen families of German Mennonites seeking religious freedom arrived in Pennsylvania; led by Franz Pastorius [Francis Daniel Pastorius], they purchased 43, 000 acres of land and founded Germantown, six miles north of Philadelphia. ²⁴

The acct. of the
German's
at ye Township &c.

Some merchands of Francfort in Germany bought 15000 acres
Some others of Crefelt bought $\frac{10000}{33000}$
To those the Governour did grant a township, and give us a Warrant for
6000 acres. But now it is onely 5190. In this our Germantownship the
Governour granded first to.
Daniell Pastorius 2000-
John Grun 3000-
George Hazfelder $\frac{1500}{650}$ -
Above those 6500- it rest 4540 acres for the said merchands of Fran-
cfort and Crefelt. to be divided betwixt them in partes equales to wit.
2270- for those of Francfort, and 2270- for those of Crefelt.
Now the friends of Francfort did give none order yet to divid their
portion; But the friends of Crefelt will divid theirs, and are those.
Jacob Tellner, bought 5000-
of those 5000- he gave to Herman, Der. ick and Abraham (obl) Graef.
2000-
Derick Sipman, bought 5000-
He has here two families, and gives to every ^{one} ~~whom~~ . 200-
Jan Strepers. bought 5000-

Appendix - Image No. A1 – Hughes, Jon. The Acct. of the German's at ye Township &c. ²⁵

²³ PHC. Historic Preservation Recommendations for the Upper Northwest Planning District. 2017. Web. 29th Dec. 2023. <https://chconservancy.org/wp-content/uploads/2018/06/UNW_historicpreservation_recommendations_PHC.pdf>.

²⁴ The Germans in America Chronology. Accessed 9th November 2023, Library of Congress. Web. <<https://www.loc.gov/rr/european/imde/germchro.html>>.

²⁵ RG-17. Records of the Land Office, Pennsylvania State Archives. Book No. D-76 pg.110. Web. 9th November 2023. <<https://www.phmc.state.pa.us/bah/dam/rg/di/r17-114CopiedSurveyBooks/r17-114MainInterfacePage.htm>>.

ROXBOROUGH & GERMAN TOWNSHIP

Roxborough - the Schuylkill River bordering its left side and the German Township is on its right side.

Roxborough formed by eleven named parcels, with the Wissahickon Creek crossing through seven. —>

THE MILLENNIUM did not arrive in 1694. For Johannes Kelpius, who had come to Pennsylvania with a small group to await the reign of Christ on earth, the disappointment was sharp.

The original leader of the group, Johann Jakob Zimmerman, had predicted the advent of the millennium for the year 1694. In preparation for this event, he organized a "Chapter of Perfection" in Germany—a brotherhood of learned men, most of them Lutheran Pietists...

When Zimmerman died in Rotterdam before embarking on the voyage to Pennsylvania, the group selected Kelpius as its leader. With the help of Benjamin Furly, William Penn's agent in Rotterdam, Kelpius and his companions finally sailed to the New World.²⁶

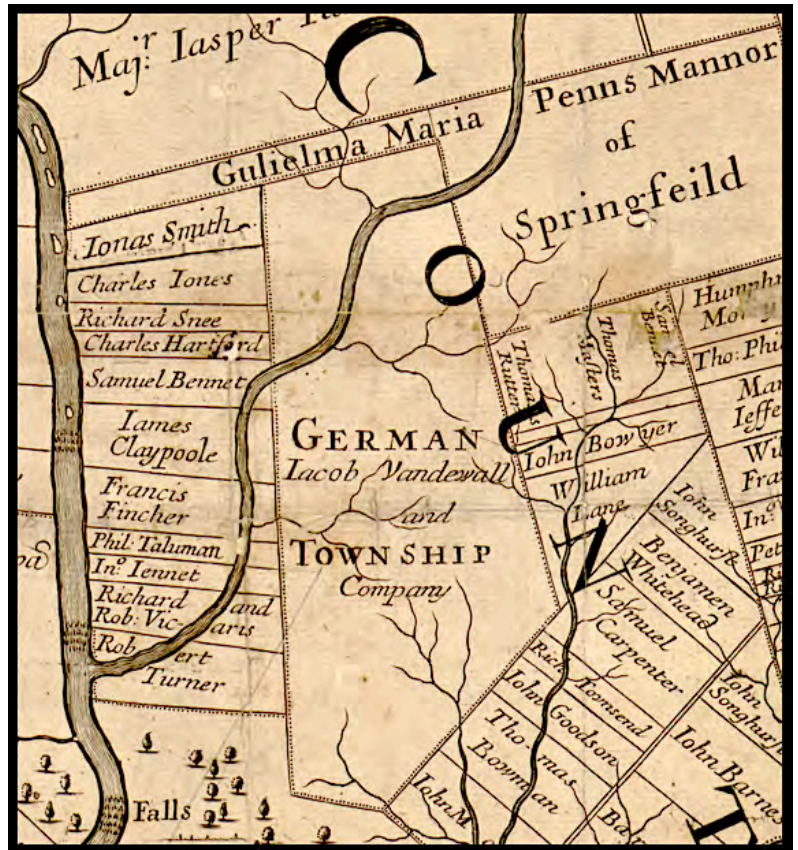

Image No. A2 – Holme, Thomas, 1695. Web. Library of Congress.



Image No. A3 – Miles, Joseph Starne. A historical sketch of Roxborough, Manayunk, Wissahickon. 1940

²⁶ Fisher, Elizabeth W. "Prophesies and Revelations": German Cabbalists in Early Pennsylvania' *The Pennsylvania Magazine of History and Biography*. 109.3 (1985): 299-333. Web. 17th December 2023.

<<http://journals.psu.edu/pmhb/article/download/44064/43785>>.

ROXBOROUGH & THE GERMAN TOWNSHIP – COUNTY OF PHILADELPHIA, STATE OF PENN^A

1731 – PLAN OR SURVEY OF THE CITY OF LIBERTIES BY BENJAMIN EASTBURN, SURVEYOR



Image No. A4 – Quarter Sessions Court, Clerk of. RG 21.26. Road Petitions. Phila. City Archives. 19th Aug. 2019.



Image No. A5 – Quarter Sessions Court, Clerk of. RG 21.26. Accessed Philadelphia City Archives. 20th August 2019.²⁷

²⁷ Joseph Wollen, Miller. 1737. Petition From His Mill To The Great Road From White Marsh To Philadelphia. (Survey was cited by Macfarlane John James & City History Society of Philadelphia. *History of Early Chestnut Hill*. 1927. 35).

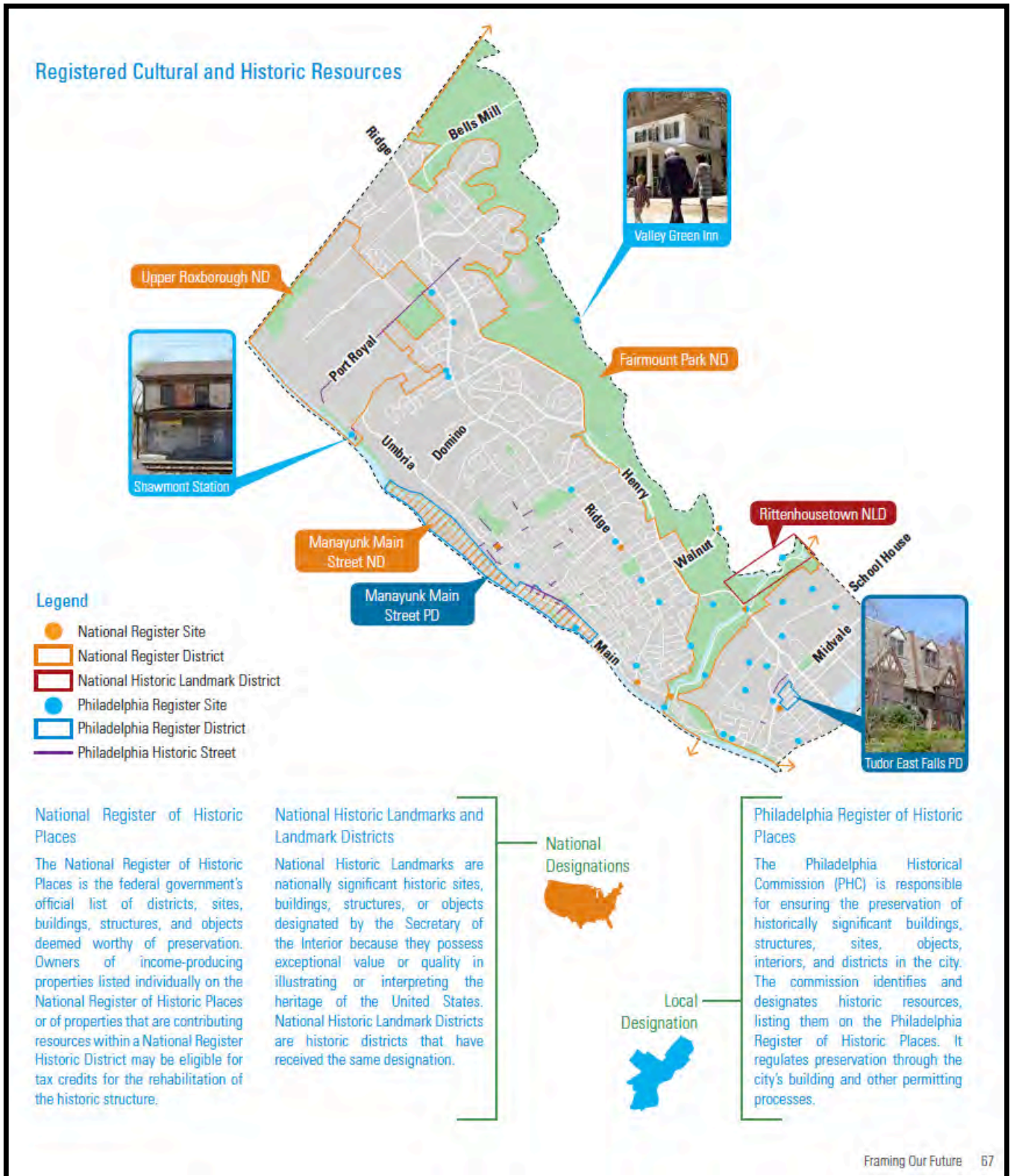

Image No. A6 – Courtesy of the Philadelphia Planning Commission’s Plan, adopted 09th December 2014.

²⁸ Philadelphia2035 Lower Northwest District Plan. Web. 9 July 2023 <<https://www.phila2035.org/lower-northwest>>.

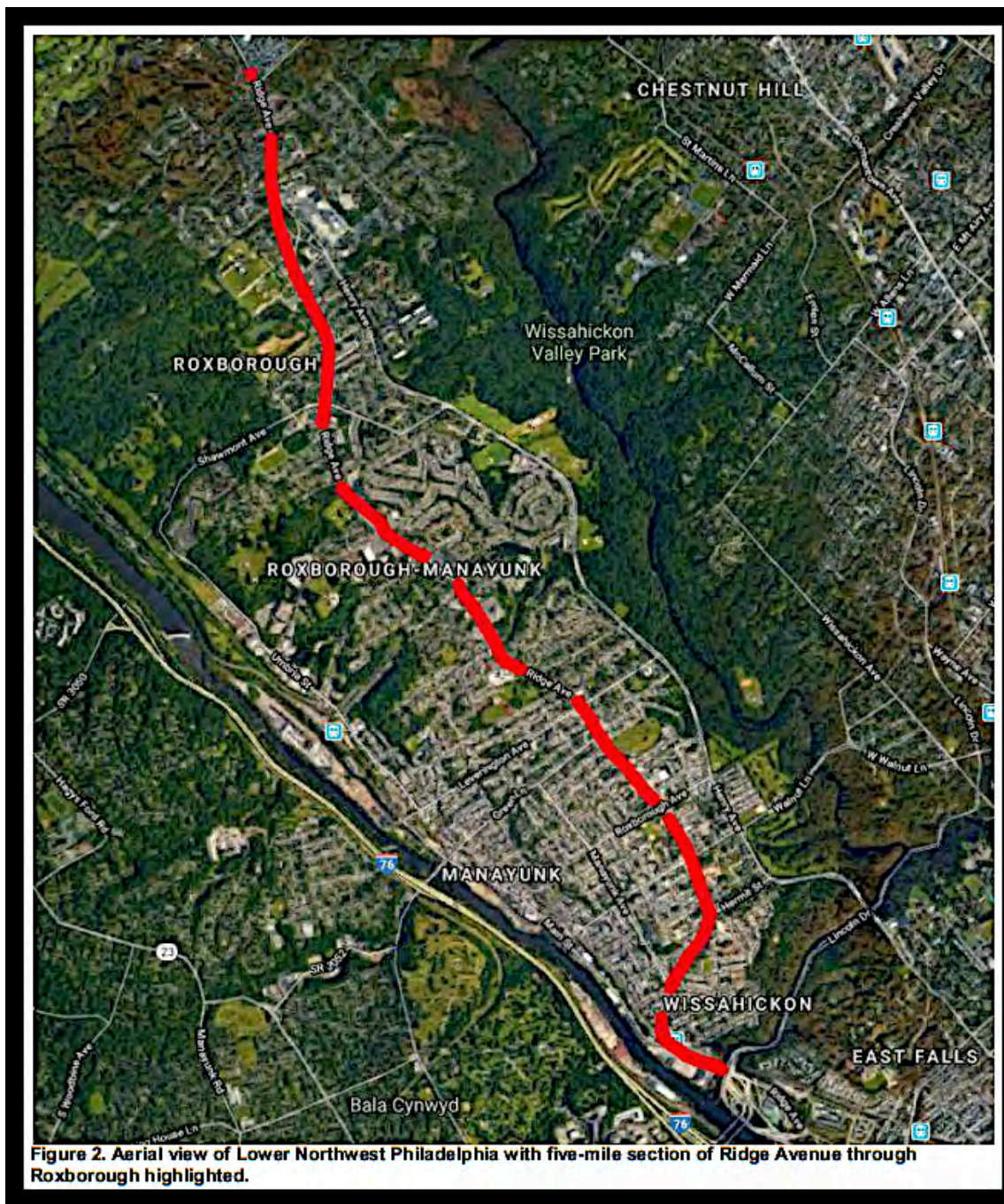

Image No. A7 – Ridge Avenue Roxborough Thematic Historic District – July 09, 2018

Courtesy of Jon Farnham – Executive Director of the Philadelphia Historical Commission:
The German Lutheran Church was established in 1845 at Pechin and Martin Streets, on the boundary of Manayunk and Roxborough. [1873 a new church was erected; enlarged in 1902]

²⁹ Ridge Avenue Roxborough Thematic Historic District Nomination. Page 37. Web. 17th August 2023.

<<https://www.phila.gov/media/20190213131353/Thematic-District-Ridge-Ave-Roxborough.pdf>>.

The German Evangelical Lutheran Bethanien Church edifice was designated historic; part of the *Victorian Roxborough Historic District*. See: Page 371: <<https://www.phila.gov/media/20220601135612/Historic-District-Victorian-Roxborough.pdf>>. The German Evangelical Lutheran Bethanien Burial Ground is a *stand-alone* cemetery, separate from the church building of 1873, on the opposite side of Martin Street. It was excluded from Victorian Roxborough Historic District. Laura DiPasquale Zupan, Historic Preservation Planner Supervisor stated on 12th June 2023: *The burial ground falls outside of the current district boundary*, referencing the Map of the Philadelphia Register of Historic Places: <<https://phl.maps.arcgis.com/apps/View/index.html?appid=0a0b23447b6b4f7097d59c580b9045fe>>.

NOTICE: ACKNOWLEDGEMENTS and COLLABORATIONS

This nomination was researched & prepared by Joseph J. Menkevich. John Charles Manton provided guidance. Mr. Manton had attended church services at Bethany and it is where he learned to speak fluent German. The materials and citations used in this nomination contain various opinions that are intended to add context to the changes, which have occurred in organized religion and their services.³⁰

Materials used in this nomination fall under the Fair Use Doctrine.

No part of this nomination may be reproduced in any form, for the purpose of private gain or profit, or for the purpose of a film script – fiction or nonfiction.

Permission to use materials belonging to other respective copyright holders or to their web pages should be addressed by those respective copyright holders.

All respective copyrights apply.

All rights reserved.

Copyright © 2024 Joseph J. Menkevich

Unauthorized duplication other than "fair use" is prohibited.

Thank You Reverend Adolph Hellwege.

**VETERAN PHILA. CLERGYMAN
DROWNS IN SURF AT SHORE**

Rev. Adolph Hellwege, 30 Years at St. Jacobus' Lutheran Church, Disappears While Bathing With Friends at Wildwood; Body Recovered

Rev. Adolph Hellwege, 64, pastor for thirty years of St. Jacobus' Lutheran Church, Third street and Columbia avenue, who resided at 1969 North Sixth street, was drowned while swimming at Wildwood, N. J. yesterday afternoon.

The body of the minister, who had maintained a summer home at the shore resort for a number of years, was found floating four hours later off Wildwood Crest. He had disappeared while bathing with a party of friends, who reported his absence to police.

No one actually saw the clergyman drown, but it was believed he be-

came chilled and developed cramps. His disappearance was not noted until almost an hour later.

Police started search for him and his body finally was found floating in the surf about two miles from the spot where he had gone boating.

The friends who reported him missing told Wildwood police that he had been bathing off Cresce avenue, a block from his home, at 253 East Bildeeth avenue, when last seen.

The minister was a swimming enthusiast and frequently went to his summer home for a day or two for salt water bathing. It was said he

Continued on 9th Page, 2d Column

Philadelphia Inquirer 3rd October 1930



~ FINIS ~

³⁰ Come gather 'round people - Wherever you roam
And admit that the waters - Around you have grown
And accept it that soon - You'll be drenched to the bone
If your time to you is worth savin' - And you better start swimmin'
Or you'll sink like a stone - **For the times they are a-changin'**
Lyrics — Bob Dylan: <<https://www.youtube.com/watch?v=CQU0TugySoo>>.