

22 November 2024

Alex Smith, Director of Art and Design  
Philadelphia Art Commission  
1515 Arch Street, 13<sup>th</sup> Floor  
Philadelphia, PA 19102

Re: Farm Philly Agriculture Resource Center in West Fairmount Park

Dear Mr. Smith:

On behalf of Farm Philly, we respectfully request time on December 11th, 2024, for the Art Commission meeting to present the revised plans for the Agriculture Resource Center (ARC) located in West Fairmount Park. In our previous meeting on June 14, 2023, we presented a revised plan which was approved by the committee. Since that period, Farm Philly has decided to move the ARC to a new site in West Fairmount.

#### Project Goals

To expand the community's capacity for local food production in the city, the ARC will be a city-operated, staffed, temporary all-in-one center to provide the tools necessary to start a garden or farm and provide public workshops and training for growers. This project is a recommended action step from Growing from the Root: Philadelphia's Urban Agriculture Plan.

#### Existing Conditions

The site is north of 100 N Horticultural Dr, Philadelphia, PA 19131 and the Fairmount Park Horticulture Center. Directly north of the site is a parking lot.

The site is approximately 0.18 acres of lawn with a gravel path through it. Adjacent to the site are a few young trees as well as a thicket of trees shrubs. All existing trees will be retained during the construction of the project.

#### Proposed Design

The proposed design consists of three recycled 40' shipping containers in an L configuration to house Farm Philly's tool inventory for lending and 'floating' wood decking (without concrete piers). The containers and decking are temporary; the total earth disturbance is less than 5000 SF.

The containers are connected and staffed by a tool librarian; the interior is not open to the public. People picking up or returning tools will schedule an appointment to visit a service window in the central container or, for large tools, doors at either end. All three containers are connected via interior doorways for ARC staff to access all parts of the library.

All three containers require electricity for outlets and lights; service will be from an onsite electrical pole. The container with the staffed service window has a point-of-sale system for transactions. The portion of the container with the service window will include an HVAC system.

The 1700 SF paved stone fines area offers a shaded gathering space to host workshops and events. The orientation of the containers and deck opens towards the Fairmount Park Horticulture Center and Horticulture Drive, providing an inviting view from the street as well as a view from the Horticulture Center to the service window of the shipping container for security. A stone fine walking path connects to the site's existing sidewalk path. The site has parking available to serve people arriving in vehicles for pick-ups and returns, therefore there will not be need new proposed parking. Host and nectar plants for pollinators and flowering vines comprise the plant palette.

Revisions from Final Review

The configuration of the containers will remain the same, however in lieu of a large wood deck to hold events, the new design proposes an ADA accessible stone fines paved area. The project will no longer include the geocell and gravel paths, since there is no drive way or need for additional parking.

Project Contacts

Keena Miles (*answer questions about the application and receive the Commission's Decision*)

Studio Bryan Hanes

340 N. 12<sup>th</sup> Street, Suite 415, Philadelphia, PA 19107

Office: 215-923-2858

Cell: 251-586-2197

Email: [armstrong@studiobryanhane.com](mailto:armstrong@studiobryanhane.com)

Ash Richards (*receive the Commission's Decision*)

Director of Urban Agriculture

Philadelphia Parks & Recreation

One Parkway Building

1515 Arch Street, Philadelphia, PA 19102

Email: [Ash.Richards@phila.gov](mailto:Ash.Richards@phila.gov)

Andrew Kirkpatrick (*receive the Commission's Decision*)

Urban Greening Coordinator

Philadelphia Parks & Recreation

Ohio House, 4700 States Drive

Philadelphia, PA 19131

Email: [Andrew.Kirkpatrick@phila.gov](mailto:Andrew.Kirkpatrick@phila.gov)

I will have application packets delivered to your office by December 4<sup>th</sup>, 2024.

Sincerely,

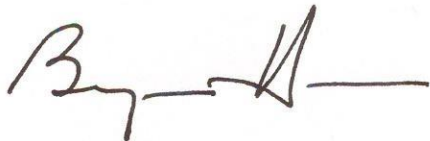
A handwritten signature in black ink, appearing to read 'Bryan Hanes', with a horizontal line extending to the right.

Bryan Hanes, ASLA, LEED

Principal

STUDIO | BRYAN HANES

# DESIGN REVIEW FOR AGRICULTURE RESOURCE CENTER

SUBMITTED TO THE PHILADELPHIA ART COMMISSION

PREPARED FOR FARM PHILLY

**04** DECEMBER **2024**

# CONTEXT PLAN - AERIAL



- N  
\* SITE    - - - - SITE    (A) STORAGE FACILITY    (B) FAIRMONT PARK HORTICULTURE CENTER    (C) DRAGON BOAT DOCK  
(D) SHOFUSO JAPANESE CULTURAL CENTER    (E) PLEASE TOUCH MUSEUM    (F) CAROUSEL HOUSE

# AERIAL IMAGE - SITE

Aerial imagery: City of Philadelphia 3in Color, 2019  
available from Pennsylvania Imagery Navigator



# PHOTOGRAPHS

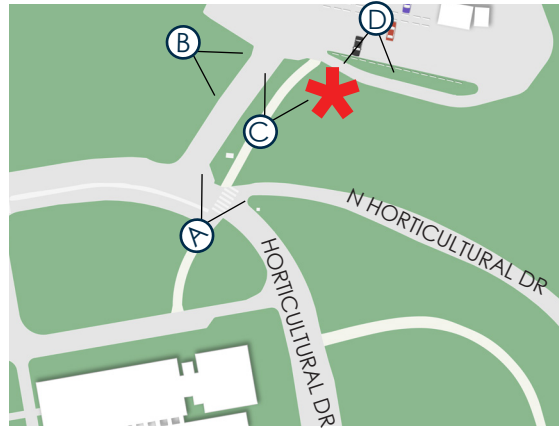

\* SITE



# PROGRAM

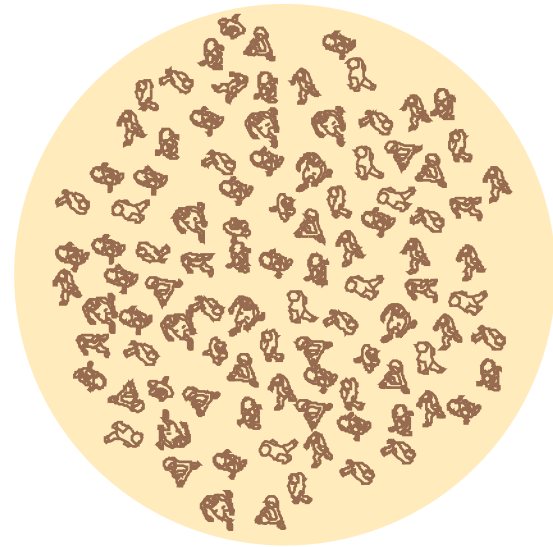

## GATHERING

minimum 1400 sf of paved  
gathering space  
100 people standing  
30-40 people at workshop tables

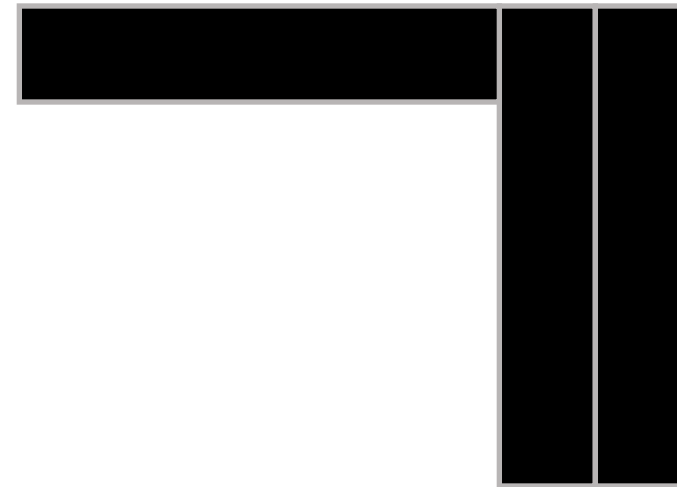

## TOOL LIBRARY

3 8'x40' containers  
opportunity to add containers

# SITE PLAN





# SITE PLAN ENLARGEMENT

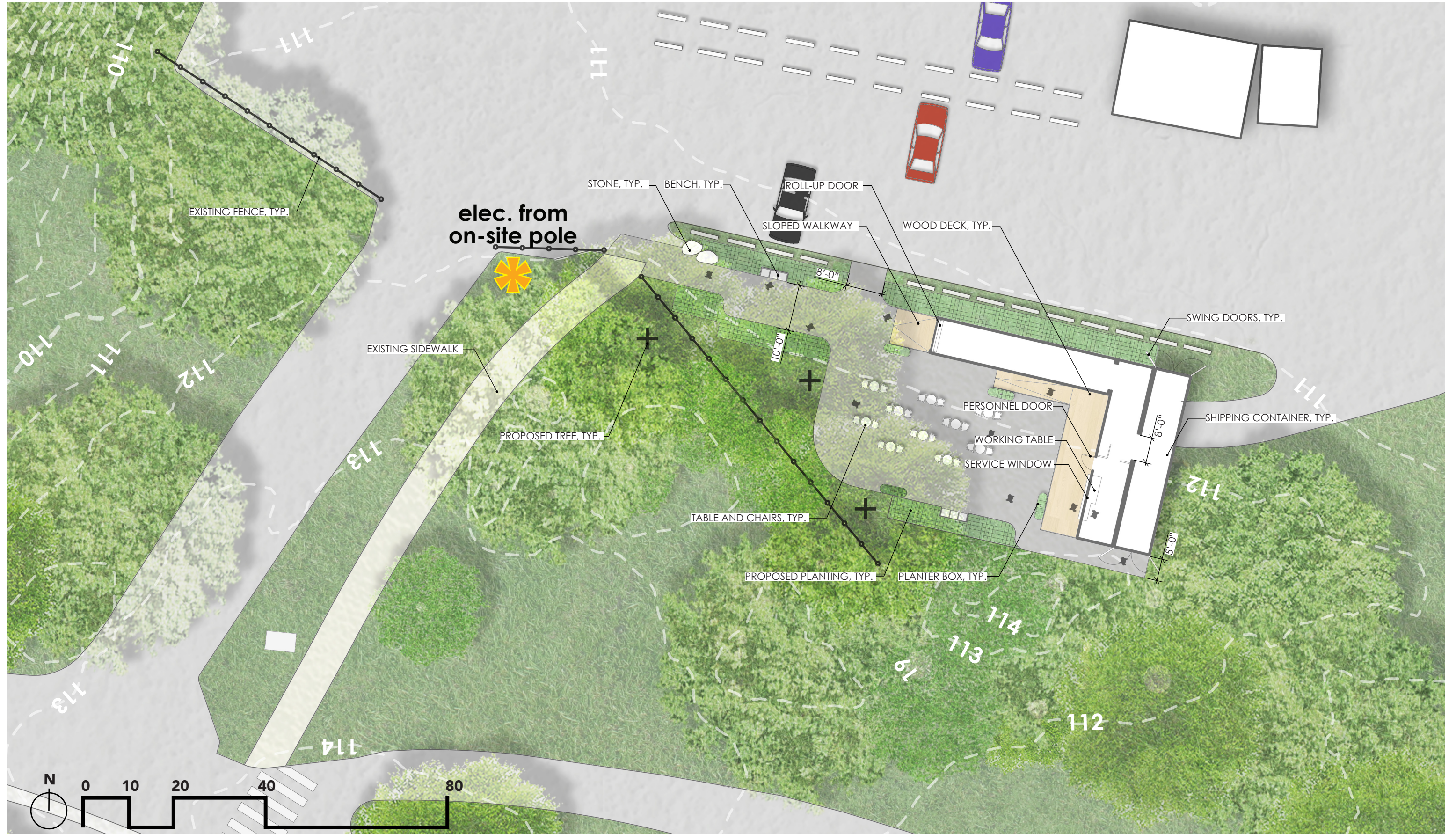

# ELEVATIONS

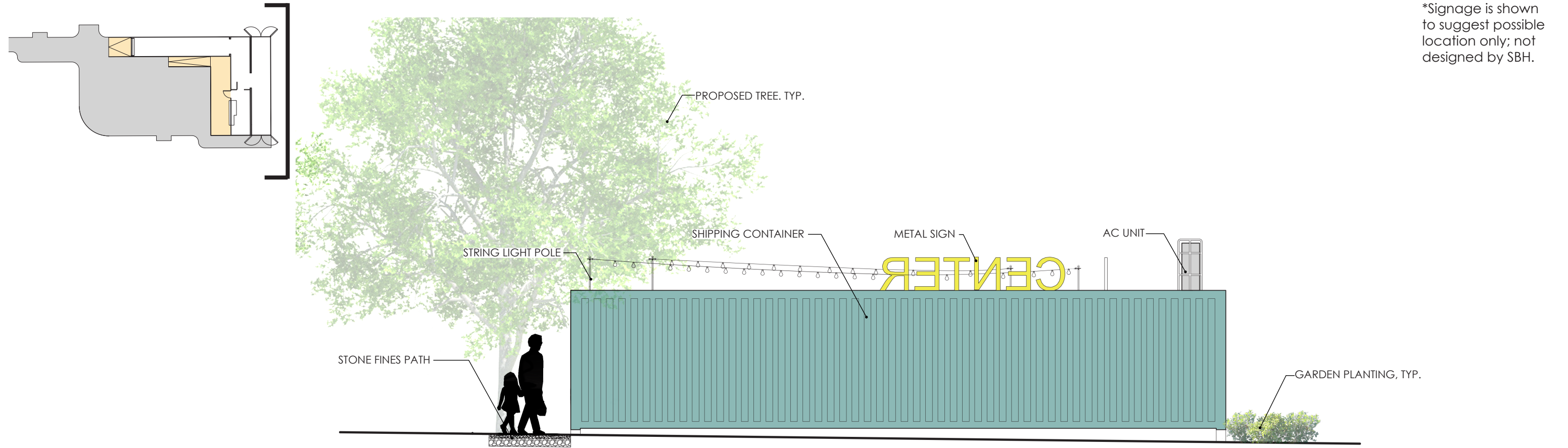

\*Signage is shown to suggest possible location only; not designed by SBH.



# ELEVATIONS

\*Signage is shown to suggest possible location only; not designed by SBH.

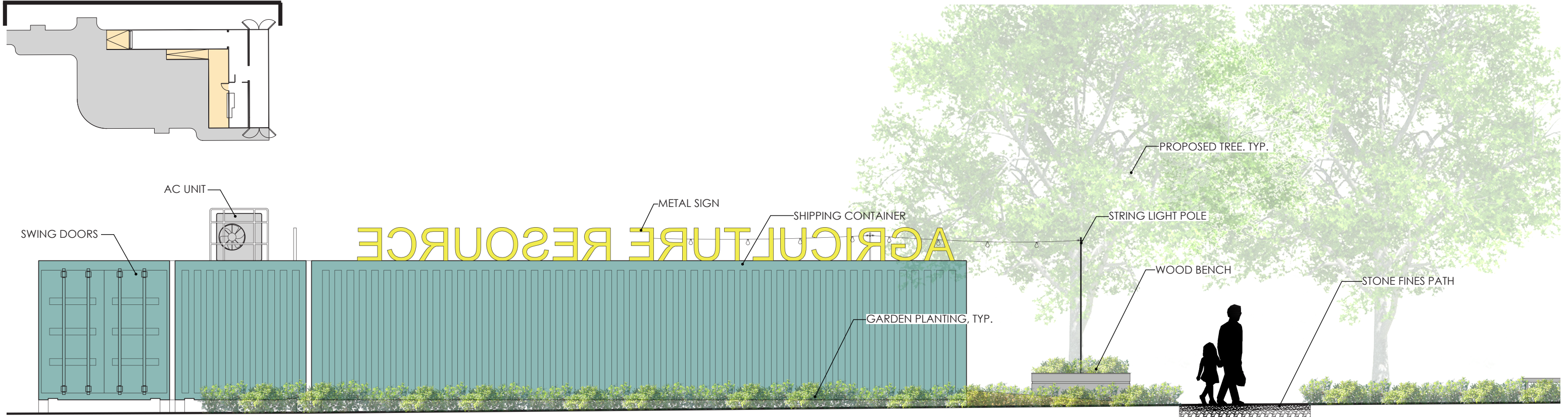
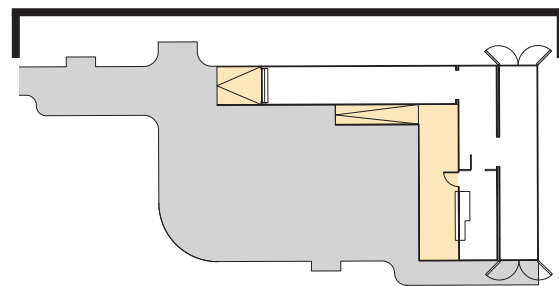
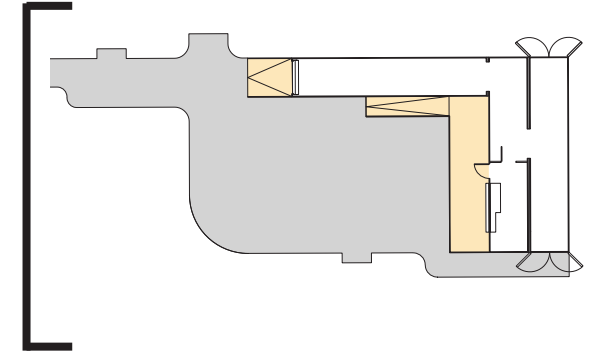
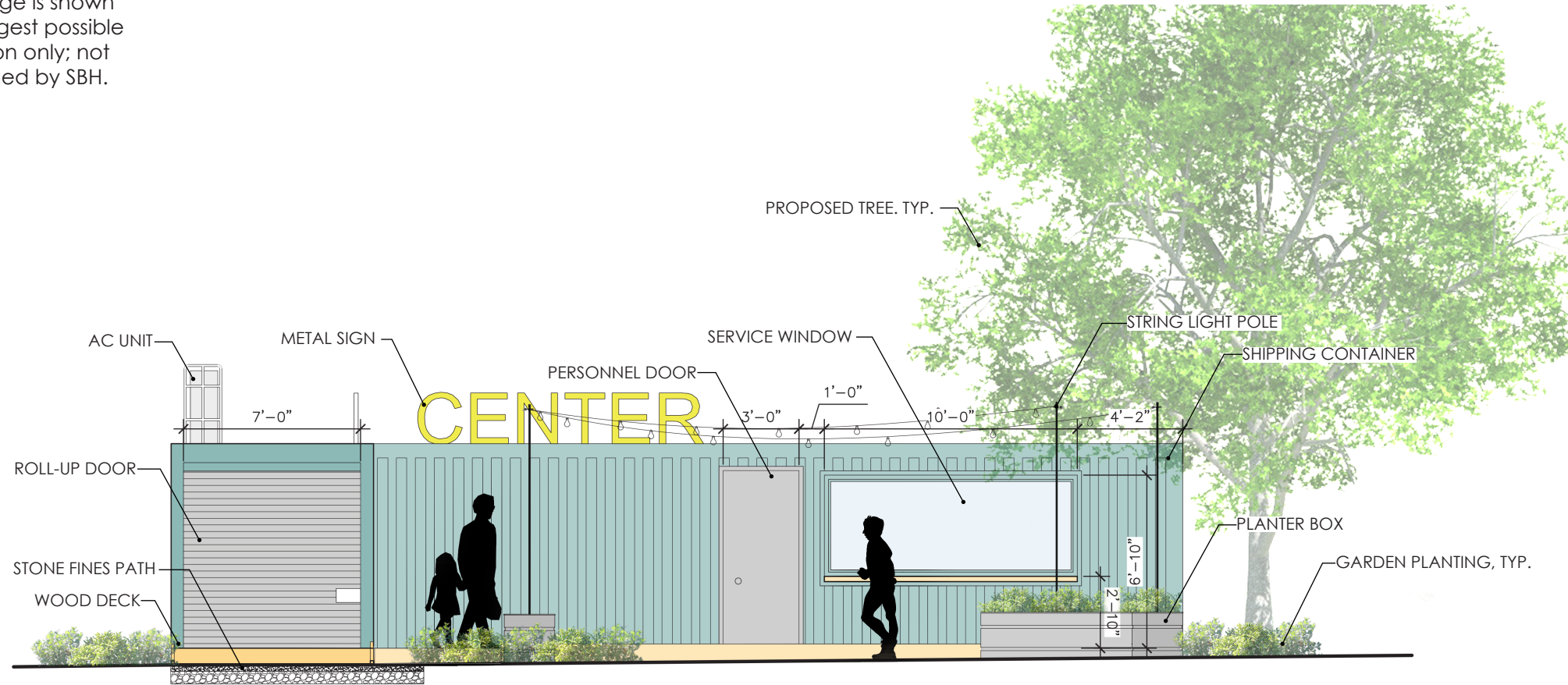

# PERSPECTIVE VIEW



# CONTAINER OPENINGS

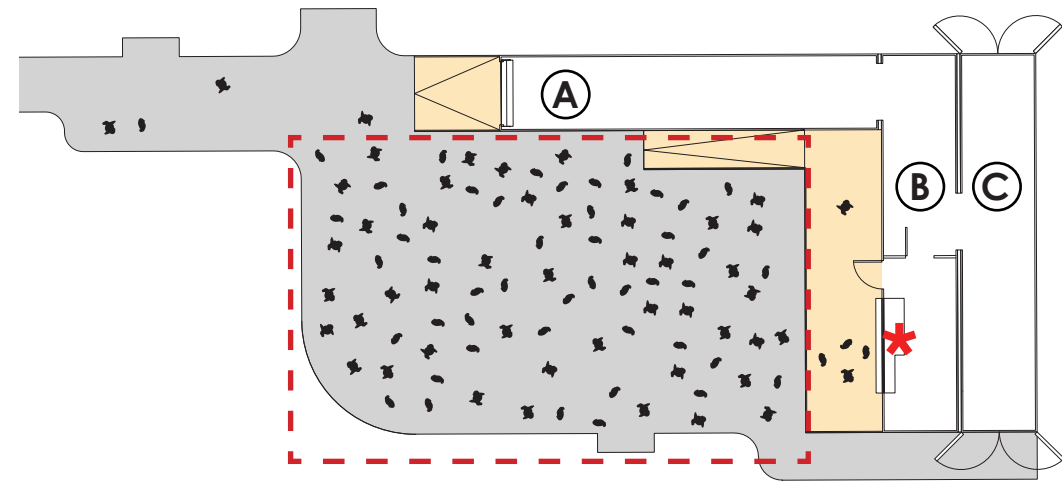

TOTAL AREA:  
1,400 SF

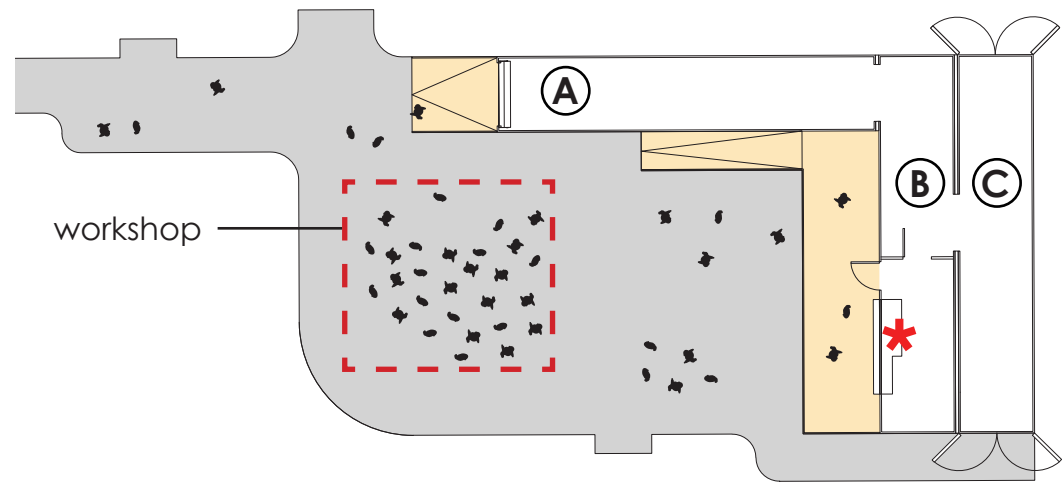

- DECK
- CONTAINER
- \* WINDOW

**A**



ROLL-UP DOOR

**B**



TRANSACTION WINDOW

**C**



CONTAINER SWING DOORS



CONTAINER SWING DOORS



PERSONNEL DOOR

# MATERIALS PALETTE



STONE FINES (PEDESTRIAN WALKWAY)



WOOD DECK (2' X 4')



PRESIDIO BENCH



TABLE AND MOVABLE CHAIRS (TO BE CABLED)



STRING LIGHTS



RAL 6033

PAINTED SHIPPING CONTAINER - GREEN

# PLANT PALETTE

POLLINATOR PLANTING



*PENSTEMON DIGITALIS*

BEARDTONGUE



*RHUS AROMATICA*

FRAGRANT SUMAC 'GRO-LOW'



*HEUCHERA VILLOSA*

HAIRY ALUM ROOT



*ILEX GLABRA*

INKBERRY, COMPACTA



*VACCINIUM ANGUSTIFOLIUM*

LOWBUSH BLUEBERRY



*EUTROCHIUM DUBIUM*

JOE PYE WEED, LITTLE JOE



*CONOCLINIUM COELESTINUM*

MISTFLOWER



*CEANOTHUS AMERICANUS*

NEW JERSEY TEA



*GERANIUM MACULATUM*

WILD GERANIUM



*FRAGARIA VIRGINIANA*

WILD STRAWBERRY



*ILEX VERTICILLATA*

WINTERBERRY

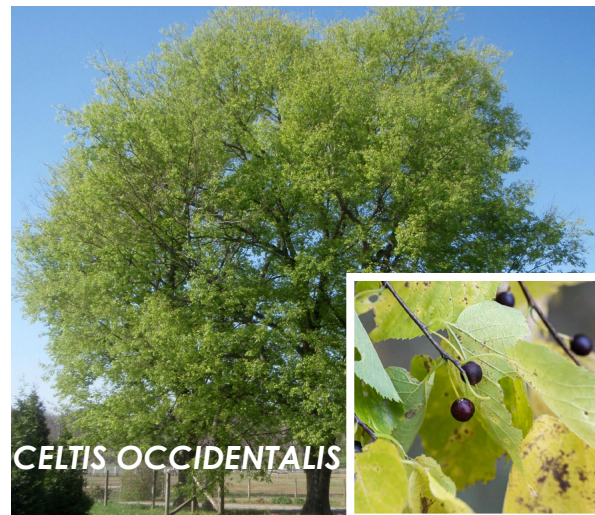

*CELTIS OCCIDENTALIS*

HACKBERRY

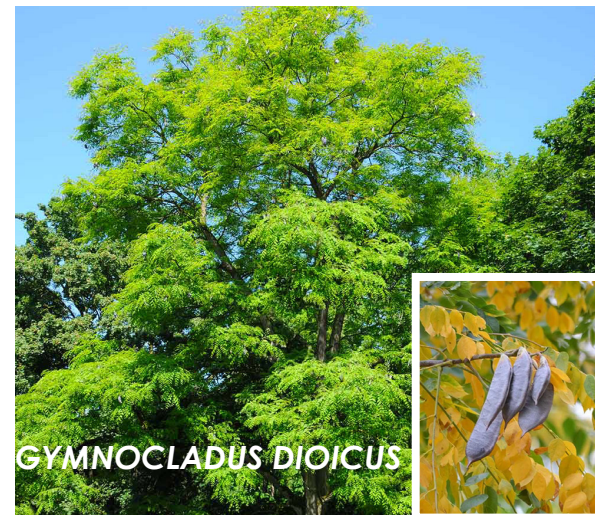

*GYMNOCLADUS DIOICUS*

KENTUCKY COFFEETREE

## FOOD CROPS

# BUDGET

**PROJECT NAME:** Farm Philly Agriculture Resource Center

## **PROJECT BUDGET**

### **SOURCES**

William Penn Foundation - \$ 295,000

Building Resilient Inclusive Communities - \$ 167,053.07

Total Sources \$ 462,053.07

### **USES**

Project Manager - \$130,000

Professional Development - \$5,000

Community Engagement - \$5,350

Indirect/Admin Fees - \$21,000

Design \$ 25,000

Signage (Design/Fabrication/Installation) - \$15,000

Materials & Supplies - \$10,800

Tools Inventory for Library - \$77,553.07

Fabrication & Installation \$172,350

Total Uses \$462,053.07