

30 October 2024

Alex M. Smith
Director of the Philadelphia Art Commission
Philadelphia City Planning Commission
City of Philadelphia

RE: Happy Hollow Recreation Center, 4800 Wayne Ave, Philadelphia, PA
Request for Final Review

Dear Mr. Smith:

We respectfully request to be included on the Art Commission agenda Wednesday November 13, 2024 for Final Review of renovations to the Happy Hollow Recreation Center, located at the address referenced above.

Following Conceptual Review in August, The Commission requested additional information regarding:

1. Nighttime lighting of the site
2. Site grading
3. Proposed tree plantings
4. Furniture revisions to show seating with backs
5. Hazardous material in the proposed safety surface
6. Stormwater management

The Design Team has revised the design to include additional site lighting and playground seating with backs. The current drawings for this project are forthcoming prospective to Art Commission review and will include nighttime photographs of existing conditions with a lighting diagram, grading plan, existing tree assessment and landscape plan, playground renderings, additional information regarding safety surfacing, and civil engineering drawings detailing grading and stormwater management features. We will also include a Letter of Intent for Percent for Art at Happy Hollow Recreation Center. Please let me know if you require any additional information for your consideration at this time.

Respectfully submitted,
SMP ARCHITECTS



Stephen Rafferty, Jr., RA
scr@smparchitects.com
215 985 4410 x 313

RENOVATIONS TO THE HAPPY HOLLOW RECREATION CENTER

CITY OF PHILADELPHIA

ART COMMISSION REVIEW
11/13/2024



PROJECT NUMBER: 718.07
© 2024 SMPARCHITECTS



HAPPY HOLLOW RECREATION CENTER

TOTAL COMMUNITY MEETINGS HELD

4 Stakeholder Level Meetings
3 Public Meetings

94
TOTAL YOUTH
PARTICIPANTS

71
ADULT ENGAGEMENT
PARTICIPANTS SIGNED-IN

SCOPE DETERMINATION

PLAYGROUND SCOPE SHARED

- New Playground:
 - Demolish existing playground
 - Replace with new inclusive playground equipment
 - Safety surface and lighting
- Pedestrian walkway from Wayne Ave
- Breezeway between 1911 Rec Center and 1958 Gym



NOVEMBER 16, 2023 PROJECT KICK OFF MEETING
Approximately 50 community members attended

- 45 PEOPLE SIGNED IN
- Meeting flyers distributed by Office of Council Dist. 4 and Recreation Center Staff

WHAT WE HEARD DURING SCOPE DETERMINATION

Happy Hollow Needs:

- Picnic Areas
- Outdoor seating
 - Families Parents + Teachers
- Safer Space
 - Cameras
 - Fencing
 - Lighting
- Childcare facilities in the area could use playground more
 - 6 weeks old - 5 years old
 - Gross motor skills activities
- After School 5-12 years old
- 13-14 year olds need spaces too
- Slides and swings for the playground
- Senior Citizens activities
 - Elderly exercise equipment
 - Turn the playground into a nice workout spot

COMMUNITY ENGAGEMENT

RENOVATIONS TO THE HAPPY HOLLOW RECREATION CENTER - CITY OF PHILADELPHIA

11/13/2024

PROJECT NUMBER: 718.07
©2024 SMPARCHITECTS



TOTAL COMMUNITY MEETINGS HELD

4 Stakeholder Level Meetings
3 Public Meetings

94
TOTAL YOUTH
PARTICIPANTS

71
ADULT ENGAGEMENT
PARTICIPANTS SIGNED-IN

CONCEPT DESIGN

ENGAGEMENT MEETINGS

1/20/24 COMMUNITY DESIGN WORKSHOP (VIRTUAL)

- 19 COMMUNITY MEMBERS ATTENDED
- Flyers distributed to Recreation Center and emails sent to November attendees

1/26/24 YOUTH DESIGN WORKSHOP AT HAPPY HOLLOW w/ afterschool, basketball, and boxing programs (IN PERSON)

- 20 YOUTH ATTENDED



COMMUNITY EXPRESSED DESIRE FOR
TWO SEPARATE PLAY ZONES:

TOT - 5 yrs old and 5 - 12 yrs old

PLAYGROUND FEEDBACK:

TOT EQUIPMENT:

DESIGNERS WERE ASKED TO ADD TOT EQUIPMENT TO THE 2-5 AREA TO CONSERVE SAFETY SURFACE

2-5 PLAY EQUIPMENT:

- PLATFORM CLIMBING
- SWINGS
- SPINNING
- SENSORY PANELS

5-12 PLAY EQUIPMENT:

- SWINGS
- SPINNING
- PLATFORM CLIMBING
- SLIDES



COMMUNITY ENGAGEMENT

RENOVATIONS TO THE HAPPY HOLLOW RECREATION CENTER - CITY OF PHILADELPHIA

11/13/2024

PROJECT NUMBER: 718.07
©2024 SMPARCHITECTS

SMP
ARCHITECTS

TOTAL COMMUNITY MEETINGS HELD

4 Stakeholder Level Meetings
3 Public Meetings

94
TOTAL YOUTH
PARTICIPANTS

71
ADULT ENGAGEMENT
PARTICIPANTS SIGNED-IN

SCHEMATIC DESIGN

ENGAGEMENT MEETINGS

5/07/24 COMMUNITY MEETING (IN-PERSON)

- 17 COMMUNITY ATTENDEES
- Flyered door to door over a 3 block radius surrounding the Happy Hollow Rec Center - Residences and Businesses

5/21/24 YOUTH SURVEYS AT KELLY ELEMENTARY

- 37 SURVEYS COMPLETED (ages 7-12)

5/25/24 YOUTH SURVEYS AT BRIGHTSIDE ACADEMY DAYCARE

- 10 SURVEYS COMPLETED (ages 3-4)



PLAYGROUND FEEDBACK:

EQUIPMENT PREFERENCES:

- PLAYFUL LEARNING ELEMENTS
- EXPLORE PAVEMENT / SURFACE GAMES
- SEPARATE PLAYZONES BASED ON AGE
- SLIDE AND LARGE ROPE / PLATFORM CLIMBER
- LARGE INCLUSIVE CAROUSEL SPINNER

PLAYFUL LEARNING IDEAS:

- INTEREST IN NATURAL SCIENCE
 - WATER, SUN, GEOLOGY, "FLOOR IS LAVA"
 - SITE GEOLOGICAL HISTORY AS FORMER QUARRY
- INTEREST IN MATH
 - COUNTING / MULTIPLYING



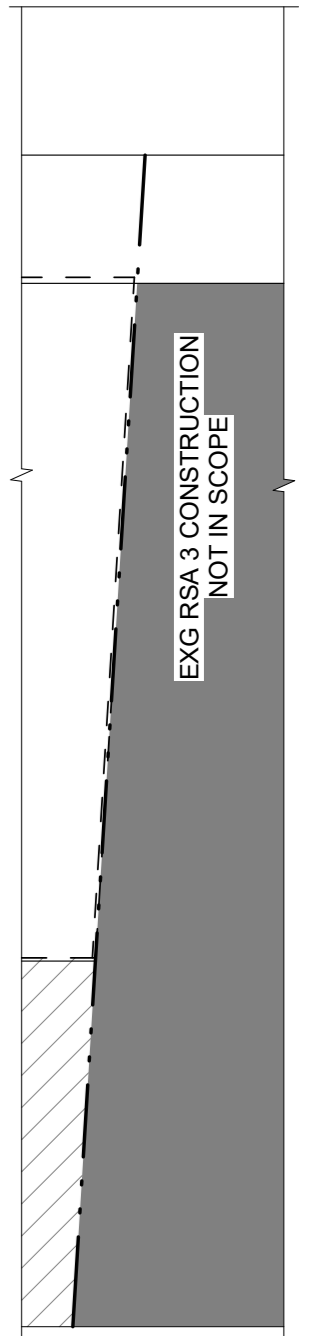
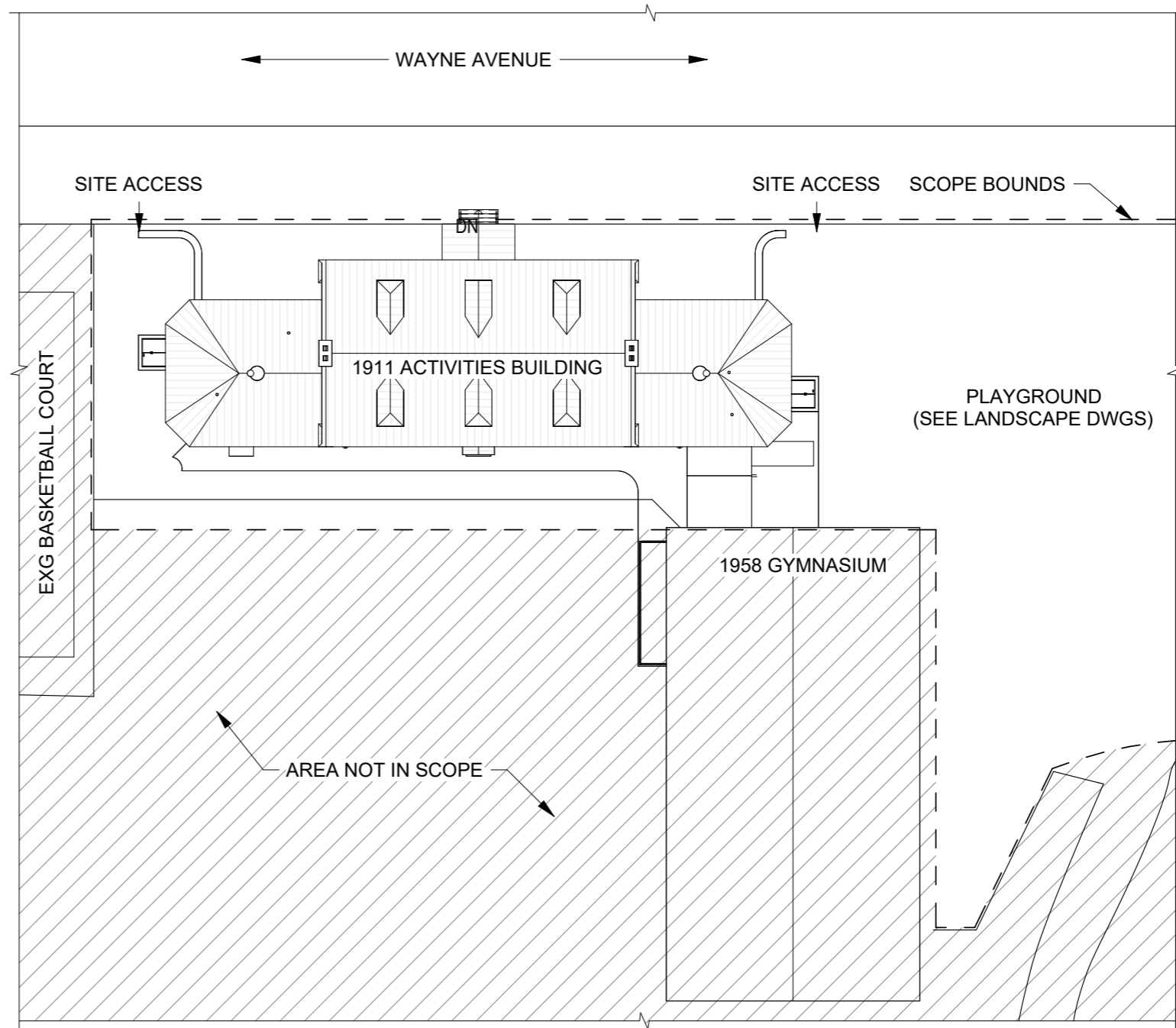
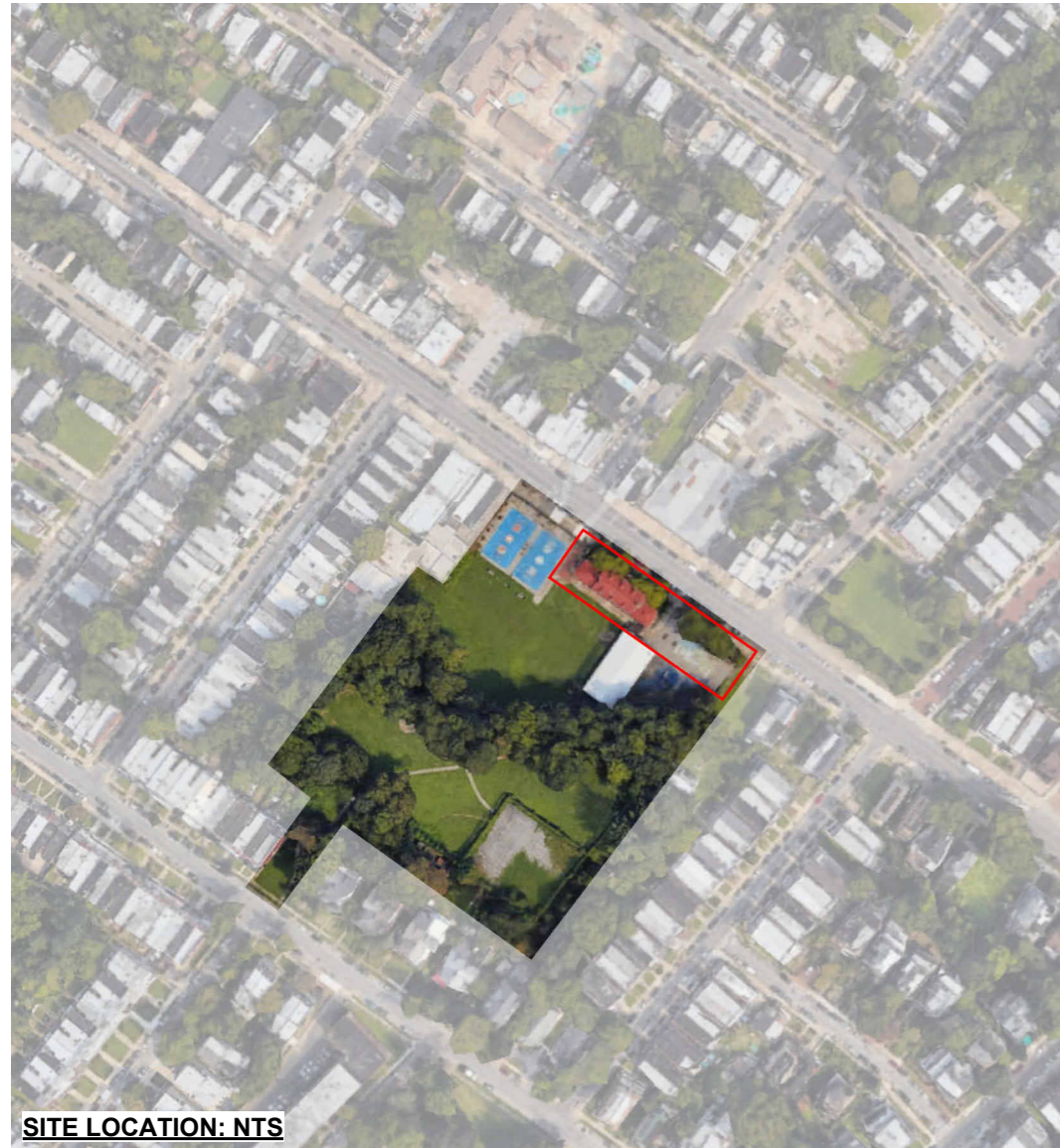
COMMUNITY ENGAGEMENT

RENOVATIONS TO THE HAPPY HOLLOW RECREATION CENTER - CITY OF PHILADELPHIA

11/13/2024

PROJECT NUMBER: 718.07
©2024 SMPARCHITECTS





SITE | 1" = 30'-0"

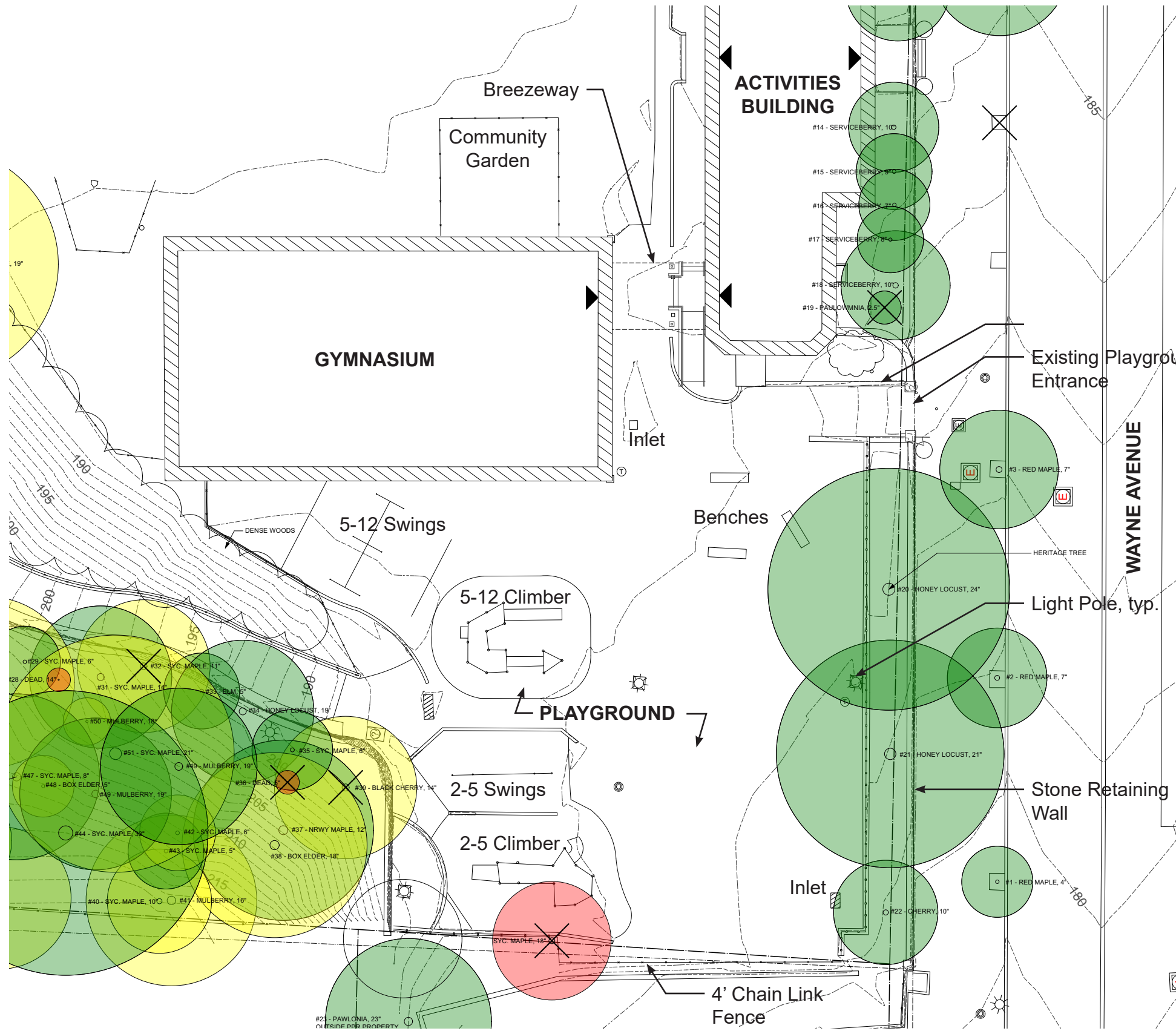
RENOVATIONS TO THE HAPPY HOLLOW RECREATION CENTER - CITY OF PHILADELPHIA

11/13/2024



PROJECT NUMBER: 718.07
©2024 SMPARCHITECTS





TREE ASSESSMENT LEGEND

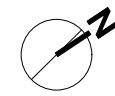
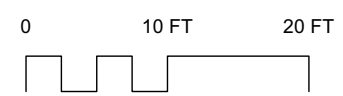
- PROPERTY LINE
- EXISTING TREE - GOOD CONDITION
- EXISTING TREE - FAIR CONDITION
- EXISTING TREE - POOR CONDITION
- EXISTING TREE - TO BE REMOVED

NOTES:

1. REFER TO ARBORIST REPORT FOR DETAILED INFORMATION ABOUT TREE CONDITION AND PRUNING RECOMMENDATIONS
2. ALL TREE REMOVALS RECOMMENDED BY ARBORIST BASED ON TREE CONDITION, RISK OF FAILURE AND/OR INVASIVE SPECIES.

EXISTING CONDITIONS & TREE ASSESSMENT

RENOVATIONS TO THE HAPPY HOLLOW RECREATION CENTER – CITY OF PHILADELPHIA



Ground **Reconsidered**



PROJECT NUMBER: 718.07
©2024 SMP ARCHITECTS



Playground entrance from Wayne Avenue



Existing benches south of activities building



Asphalt yard with play pavement markings



View from SE corner of playground toward gymnasium



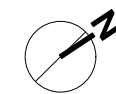
Ages 5-12 swing set near gymnasium, non-functional



Ages 2-5 swings and climbing structure with heavy wear

EXISTING SITE PHOTOS: PLAYGROUND

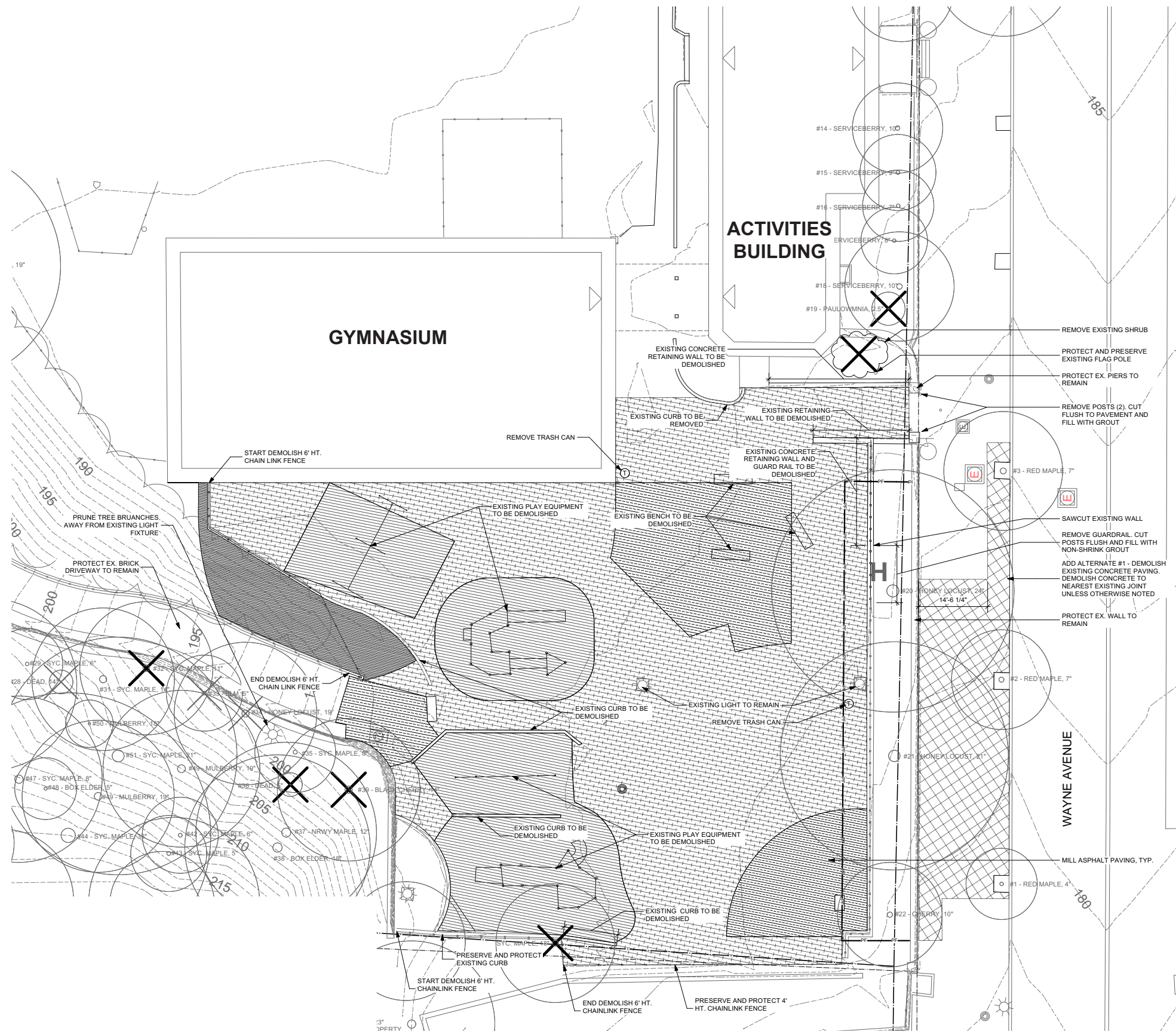
RENOVATIONS TO THE HAPPY HOLLOW RECREATION CENTER – CITY OF PHILADELPHIA



Ground Reconsidered

PROJECT NUMBER: 718.07
©2024 SMP ARCHITECTS





DEMOLITION LEGEND

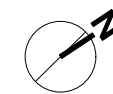
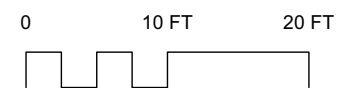
- PROPERTY LINE
- - - LIMIT OF WORK
- PF— TREE PROTECTION FENCE
- ~~~~ SAWCUT EXISTING PAVEMENT
- [Cross-hatched box] CONCRETE PAVEMENT TO BE REMOVED
- [Diagonal lines box] SAFETY SURFACE TO BE REMOVED
- [Horizontal lines box] ASPHALT PAVING TO BE REMOVED
- [Vertical lines box] CLEAR AND GRUB VEGETATION
- [X in circle] TREE TO BE REMOVED

DEMOLITION NOTES

1. REMOVE ALL PAVEMENT AND CONSTRUCTION DEBRIS AS INDICATED ON PLAN. PAVING BASE MATERIALS MAY REMAIN IF CONSISTENT WITH SPECIFIED AGGREGATE BASE MATERIAL.

DEMOLITION PLAN

RENOVATIONS TO THE HAPPY HOLLOW RECREATION CENTER – CITY OF PHILADELPHIA



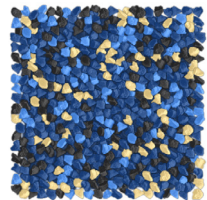
Ground Reconsidered



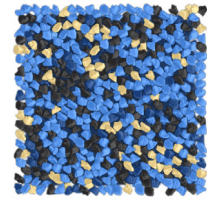
PROJECT NUMBER: 718.07
©2024 SMP ARCHITECTS

PLAYGROUND - AGES 2-5 PLAY STRUCTURES			
KEY	QUANTITY	PRODUCT NAME	MANUFACTURER
A	1	INCLUSIVE ORBIT	BURKE
B	1	ORBIT ROCKER	BURKE
C	1	SWING 5" ARCH W/ (2) BUCKET SEATS	BURKE
D	1	CUSTOM PLAY PANEL THEME AND GRAPHICS TBD	BURKE
E	1	LEVEL X LAUNCH	BURKE

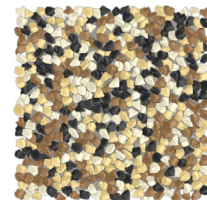
PLAYGROUND - AGES 5-12 PLAY STRUCTURES			
KEY	QUANTITY	PRODUCT NAME	MANUFACTURER
F	1	LEVEL X EXTREME NU-3285	BURKE
G	1	KIDFORCE SPINNER	BURKE
H	1	5" ARCH W/ (2) BELT SEATS, (1) 'FREEDOM' ACCESSIBLE SEAT (AGES 2-12)	BURKE
I	1	CUSTOM PLAY PANEL THEME AND GRAPHIC TBD	BURKE



Mix Composition:
 45% Royal Blue Granules
 15% Sky Blue Granules
 15% Eggshell Granules
 25% Black Granules



Mix Composition:
 10% Royal Blue Granules
 50% Sky Blue Granules
 15% Eggshell Granules
 25% Black Granules



Mix Composition:
 25% Pearl Granules
 25% Brown Granules
 25% Eggshell Granules
 25% Black Granules

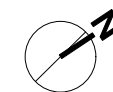
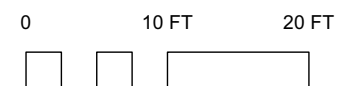


SITE PLAN LEGEND

- PROJECT BOUNDARY
- EXISTING CANOPY TREE TO REMAIN
- PROPOSED CANOPY TREE
- PROPOSED ORNAMENTAL TREE
- PROPOSED SHRUB
- CONCRETE PAVING
- ASPHALT PAVING
- RUBBERIZED SAFETY SURFACE
- GROUND COVER
- LAWN
- NATIVE PERENNIAL SEED MIX
- BACKED BENCH
- BACKLESS BENCH
- PEDESTAL TABLE
- TRASH RECEPTACLE
- BIKE RACK
- BOULDER SEAT
- PEDESTRIAN LIGHT
- PERSPECTIVE VIEW

LANDSCAPE PLAN

RENOVATIONS TO THE HAPPY HOLLOW RECREATION CENTER – CITY OF PHILADELPHIA



Ground Reconsidered



PROJECT NUMBER: 718.07
 ©2024 SMP ARCHITECTS



A. Inclusive Orbit



B. Orbit Rocker



C. Swing 5" Arch - (2) bucket seats



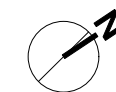
D. Activity Panel (to be customized for playful learning)



E. Level X Launch

AGES 2-5 PLAY EQUIPMENT

RENOVATIONS TO THE HAPPY HOLLOW RECREATION CENTER – CITY OF PHILADELPHIA



Ground Reconsidered

PROJECT NUMBER: 718.07
©2024 SMP ARCHITECTS





F. Level X Extreme NU- 3285



G. Kidforce Spinner



I. Activity Panel (to be customized for playful learning)



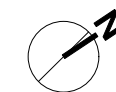
H. 5" Arch - (2) Belt Seats and (1) Accessible Seat



Freedom Accessible Swing Seat
Ages 2-12

AGES 5-12 PLAY EQUIPMENT

RENOVATIONS TO THE HAPPY HOLLOW RECREATION CENTER – CITY OF PHILADELPHIA



Ground Reconsidered

PROJECT NUMBER: 718.07
©2024 SMP ARCHITECTS





Backless Bench



Backed Bench



Picnic Table



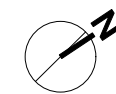
Trash Receptacle



Pedestrian Light

SITE FURNISHINGS

RENOVATIONS TO THE HAPPY HOLLOW RECREATION CENTER – CITY OF PHILADELPHIA



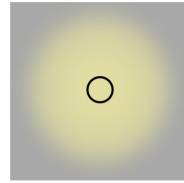
Ground Reconsidered

PROJECT NUMBER: 718.07
©2024 SMP ARCHITECTS

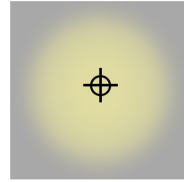




DIAGRAM KEY



NEW LUMINAIRE



PROPOSED PEDESTRIAN LIGHT POLE



Entrance from Wayne Avenue



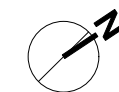
Center of playground area



North of breezeway looking south

SITE LIGHTING DIAGRAM

RENOVATIONS TO THE HAPPY HOLLOW RECREATION CENTER – CITY OF PHILADELPHIA



Ground Reconsidered



PROJECT NUMBER: 718.07
©2024 SMP ARCHITECTS



Platanus x acerfolia 'Exclamation'
Exclamation London Plane Tree



Tilia americana
American Linden



Nyssa sylvatica
Black Gum



Ostrya virginiana
American Hophornbeam



Cercis canadensis
Eastern Redbud



Amelanchier x 'Autumn Brilliance'
Serviceberry



Eragrostis spectabilis
Purple Love Grass



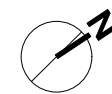
Hypericum calycinum
St John's Wort

Ground Cover

Trees

PLANT PALETTE

RENOVATIONS TO THE HAPPY HOLLOW RECREATION CENTER – CITY OF PHILADELPHIA



Ground Reconsidered

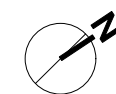
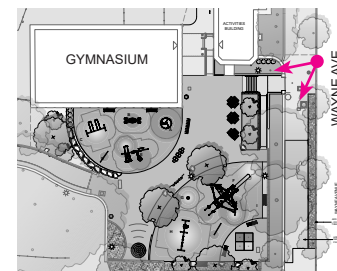
SMP
ARCHITECTS

PROJECT NUMBER: 718.07
©2024 SMP ARCHITECTS



VIEW A: Renovated accessible entrance at Wayne Avenue

RENOVATIONS TO THE HAPPY HOLLOW RECREATION CENTER – CITY OF PHILADELPHIA



Ground Reconsidered

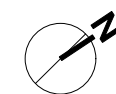
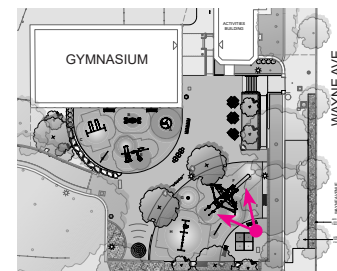
PROJECT NUMBER: 718.07
©2024 SMP ARCHITECTS





VIEW B: Ages 5-12 play area looking NW toward Gymnasium

RENOVATIONS TO THE HAPPY HOLLOW RECREATION CENTER – CITY OF PHILADELPHIA



Ground Reconsidered

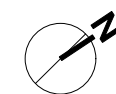
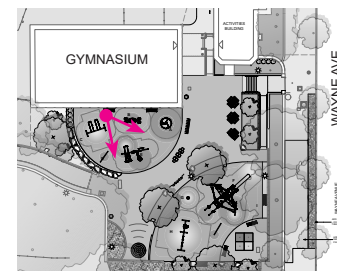
PROJECT NUMBER: 718.07
©2024 SMP ARCHITECTS





VIEW C: Ages 2-5 play area looking SE

RENOVATIONS TO THE HAPPY HOLLOW RECREATION CENTER – CITY OF PHILADELPHIA



Ground Reconsidered

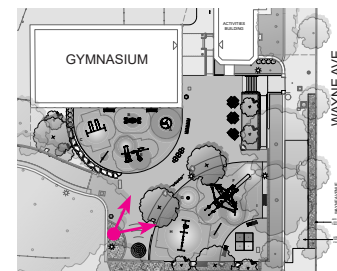
PROJECT NUMBER: 718.07
©2024 SMP ARCHITECTS





VIEW D: Pathway between play areas looking to Wayne Ave

RENOVATIONS TO THE HAPPY HOLLOW RECREATION CENTER – CITY OF PHILADELPHIA



Ground Reconsidered

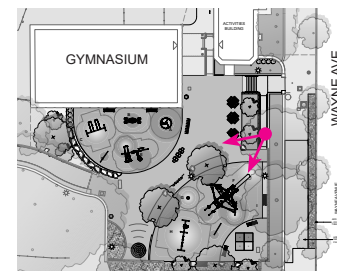
SMP
ARCHITECTS

PROJECT NUMBER: 718.07
©2024 SMP ARCHITECTS



VIEW E: Top of accessible ramp looking south to 5-12 play area

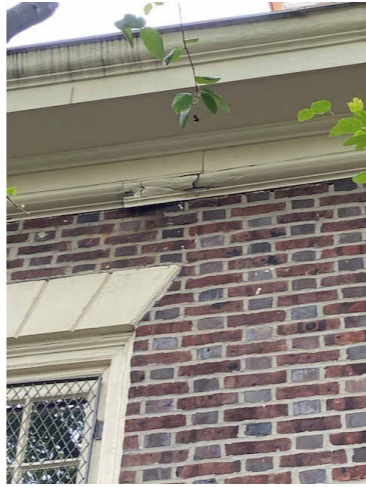
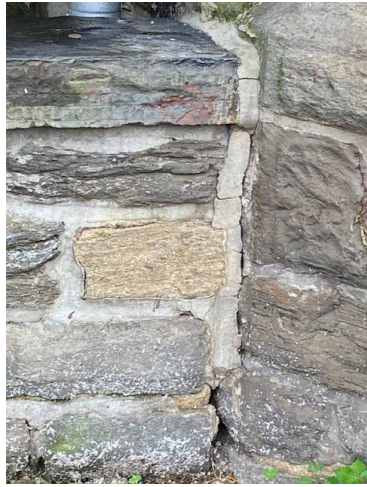
RENOVATIONS TO THE HAPPY HOLLOW RECREATION CENTER – CITY OF PHILADELPHIA



Ground Reconsidered

PROJECT NUMBER: 718.07
©2024 SMP ARCHITECTS





DETAIL CONDITIONS



EAST ELEVATION



WEST ELEVATION



NORTH (FRONT) ELEVATION



SOUTH (REAR) ELEVATION

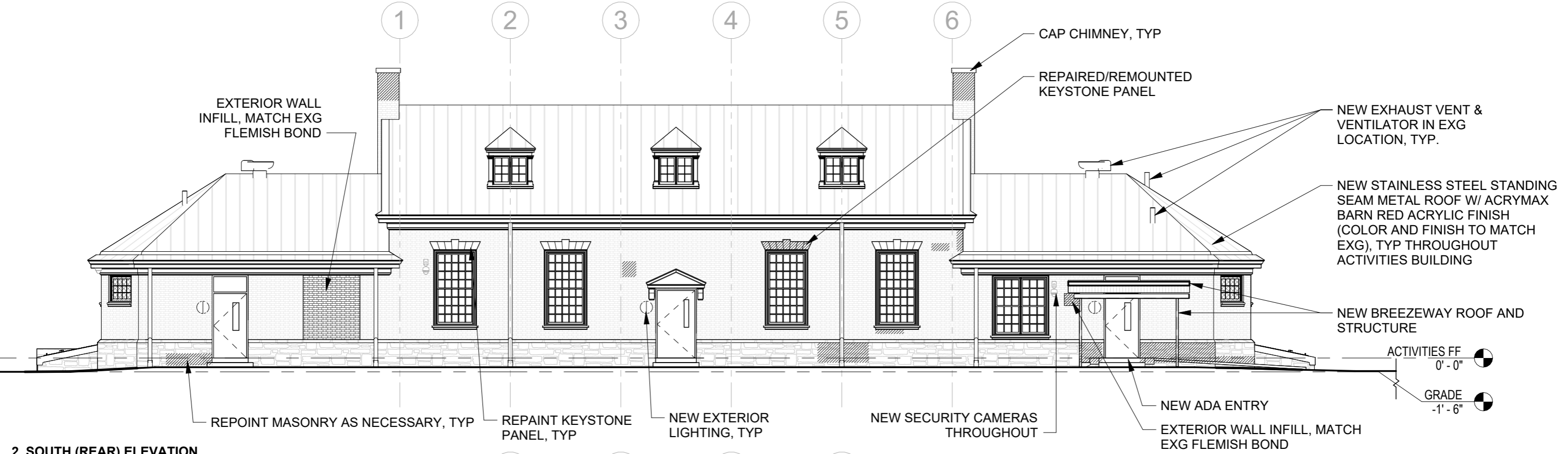
EXISTING CONDITIONS AND SITE DOCUMENTATION

RENOVATIONS TO THE HAPPY HOLLOW RECREATION CENTER - CITY OF PHILADELPHIA

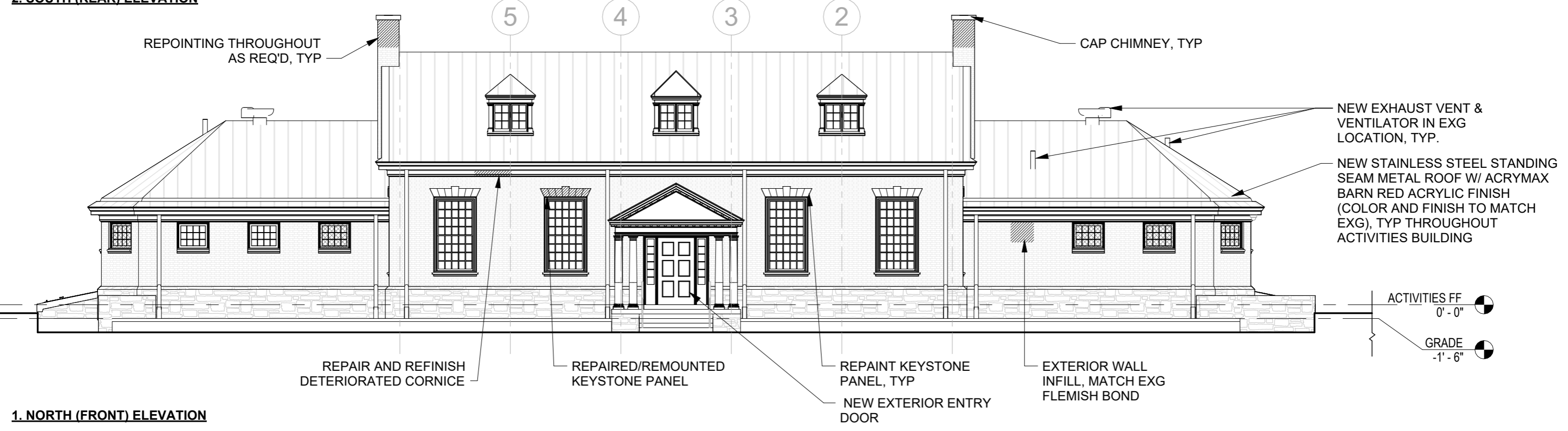
11/13/2024

PROJECT NUMBER: 718.07
©2024 SMPARCHITECTS





2. SOUTH (REAR) ELEVATION



1. NORTH (FRONT) ELEVATION

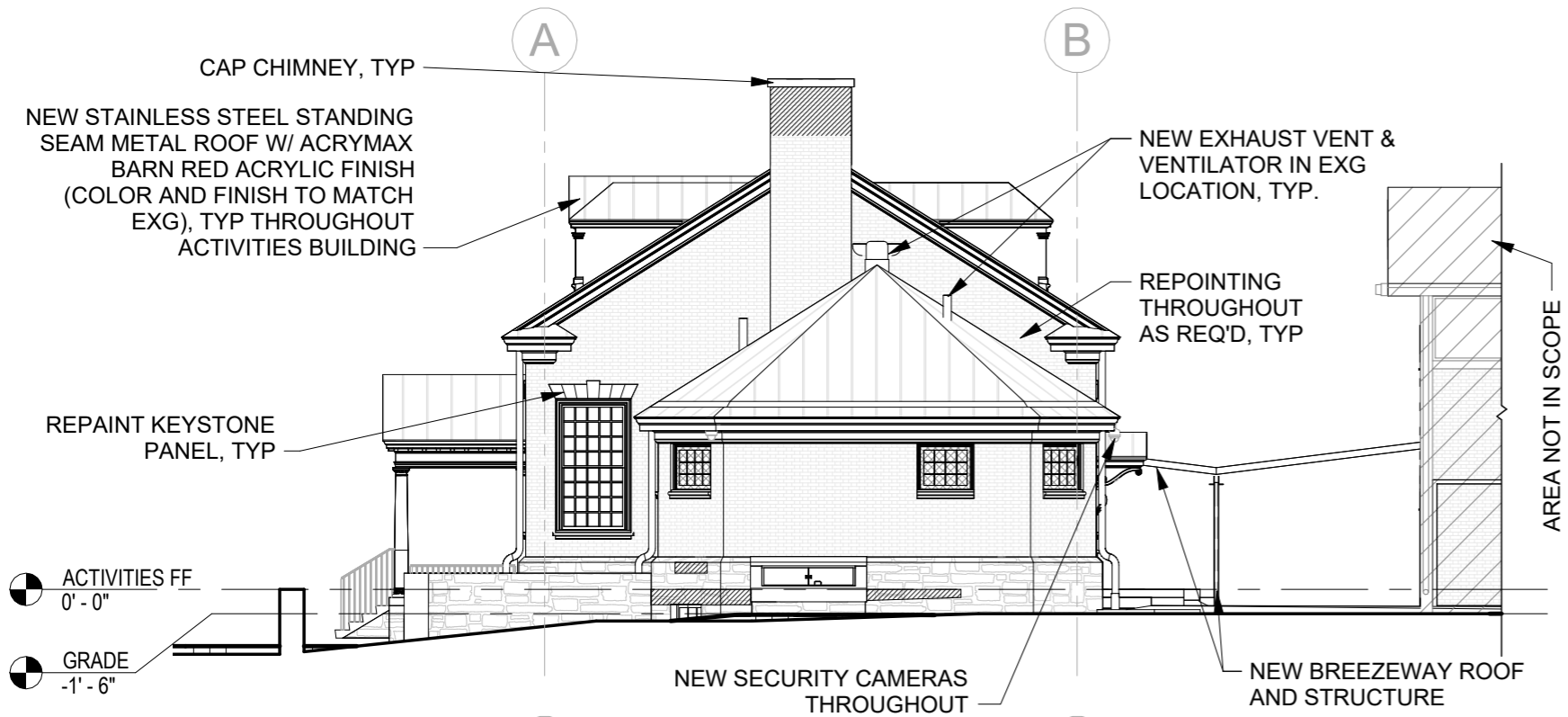
EXTERIOR ELEVATIONS | 3/32" = 1'-0"

RENOVATIONS TO THE HAPPY HOLLOW RECREATION CENTER - CITY OF PHILADELPHIA

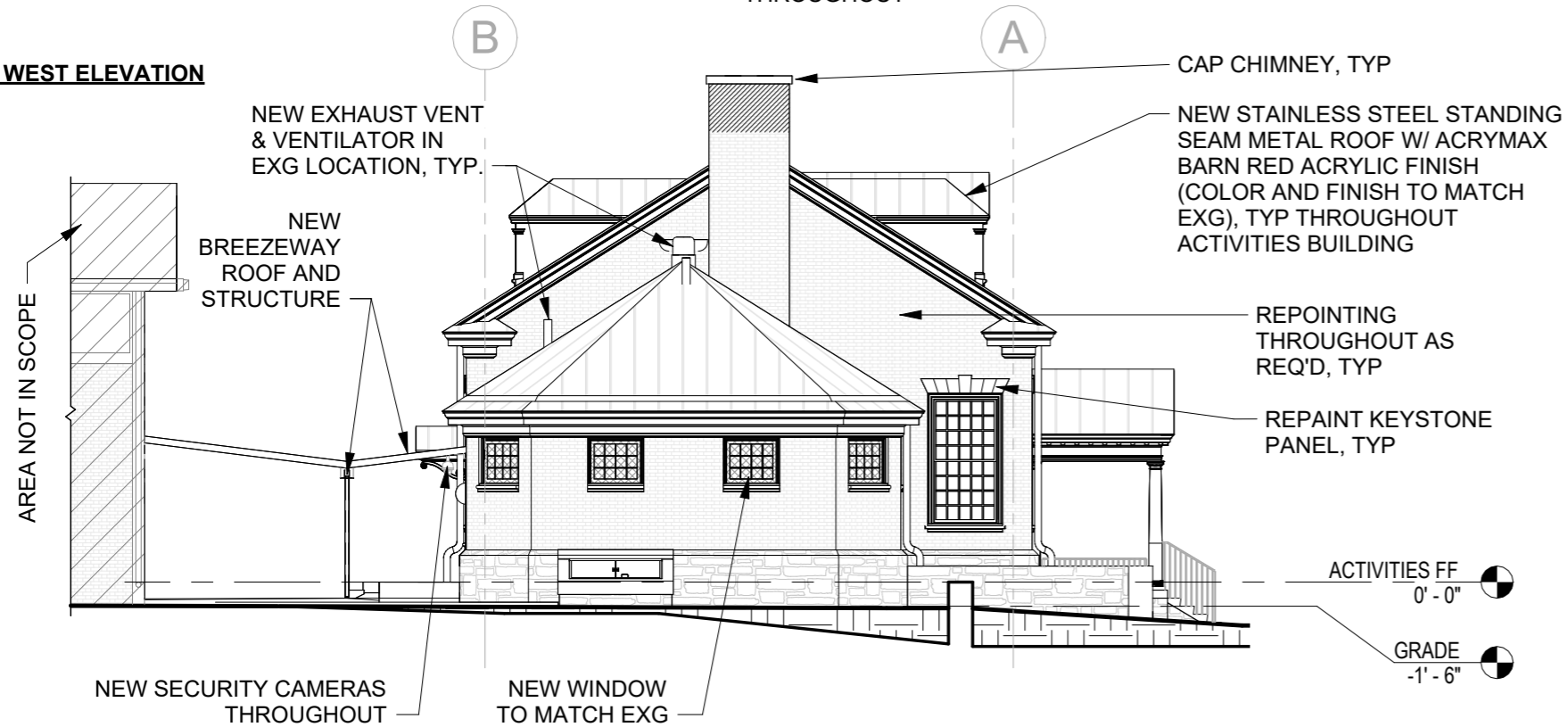
11/13/2024

PROJECT NUMBER: 718.07
©2024 SMPARCHITECTS





2. WEST ELEVATION



1. EAST ELEVATION

EXTERIOR ELEVATIONS | 3/32" = 1'-0"

RENOVATIONS TO THE HAPPY HOLLOW RECREATION CENTER - CITY OF PHILADELPHIA

11/13/2024

PROJECT NUMBER: 718.07
©2024 SMPARCHITECTS



July 31, 2024



Alex Smith
The Philadelphia Art Commission
One Parkway, 1515 Arch Street, 13th Floor
Philadelphia, PA 19102

Re: Letter of Intent for Percent for Art at Happy Hollow Recreation Center

Dear Alex:

The Office of Arts, Culture and the Creative Economy (OACCE) would like to inform the Philadelphia Art Commission of our intent to provide a future Percent for Art opportunity at Happy Hollow Recreation Center in collaboration with our partners at Rebuild. Happy Hollow Recreation Center is a Rebuild site at 4800 Wayne Avenue the Germantown neighborhood in Northwest Philadelphia consisting of interior and exterior building upgrades, new playground equipment and field improvements. Below is an overview of our understanding and anticipated approach for this public art project:

- The Happy Hollow Recreation Center Percent for Art opportunity will create a beautiful and enduring work of public art that is permanent, site-specific, and reflects the culture, values, and diversity of the Germantown community in Northwest Philadelphia. The Art budget will be at least 1% of the total project budget in keeping with the City's Percent for Art guidelines. Due to the City's current Percent for Art projects that are underway, the timeline for the future public art project is still being determined with OACCE and Rebuild and is considered a Category 2- Future PFA project (see attached Percent for Art/Rebuild Memo).
- A Happy Hollow Recreation Center Percent for Art Committee will be formed to advise the selection of the artist and the art proposal and will include representatives from: the Happy Hollow Design team, community members that utilize the Happy Hollow Recreation Center; public art artists; residents of the Germantown community; representatives from City Council District 8 Office, Parks and Recreation, Rebuild and OACCE.
- The Artist will be selected through a two-part competition, consisting of a Call for Artist Phase 1 where artists submit qualifications, and a subsequent Phase 2 where 3 to 4 semi-finalists will be selected by the Committee to move forward with providing proposals. Community involvement will be a critical component, and artist teams will be encouraged to work with the public to align their proposal with the desires and feedback from the community. Community engagement will occur in virtual and/or in-person meetings with community members, and through online public surveys.
- OACCE will provide oversight for the Percent for Art process from concept to installation and will work with the artist and project team to ensure the technical details for the artwork are coordinated with the site. Once a Finalist is selected and the artwork has been developed, OACCE will initiate a separate review process with the Philadelphia Art Commission for approving the artwork.

We look forward to working with the project team and all community stakeholders to realize a beautiful public artwork that will be an enduring contribution to the Germantown community and the City's renowned collection of public art. Should you require any additional information please do not hesitate to call me at 215.686.4596.

Sincerely,

Marguerite Anglin, RA, NOMA
Public Art Director
Office of Arts, Culture and the Creative Economy

Rebuild Percent for Art Strategy

7/31/2024



Memorandum

To: Alex Smith, Philadelphia Art Commission
From: The Office of Arts, Culture and the Creative Economy (OACCE)/ Rebuild
Date: July 31, 2024
Subject: Rebuild Percent for Art Strategy

The Office of Arts, Culture and the Creative Economy (OACCE) administers the City's Percent for Art (PFA) program, which by City Ordinance requires that up to 1% of the budget for an eligible capital construction project is designated to site-specific public art. Percent for Art projects are multi-year efforts which include an open Call to Artist selection process; a robust community engagement process; project management by OACCE working with the artist and project team to ensure the technical details, fabrication and installation of the public art work is fully coordinated with the site constraints; and ultimate approval of the artist and artist's design proposal by the Philadelphia Art Commission.

This memorandum outlines the City's strategy for administering Percent for Art (PFA) projects for Rebuild renovation and construction sites. OACCE and Rebuild leadership have identified the need for this strategy due to the rare volume of capital projects that have triggered the City's Percent for Art ordinance at this time. The intent is to administer Percent for Art funds strategically across Rebuild project sites based on six (6) categories that consider scope, priority, location, timing, and community needs, in keeping with Percent for Art Guidelines. Category 1 refers to eligible PFA projects that are expected to commence planning within the current calendar year (schedules permitting) as determined by Rebuild and OACCE leadership. All other projects are described in the remaining Categories 2-6 below.

Proposed Rebuild Percent for Art (PFA) Categories:

Category 1: Eligible/Active PFA: The Rebuild Project is eligible for PFA per the PFA Guidelines and is either in progress or on OACCE's list to start PFA planning activities within the current calendar year, schedules permitting.

Category 2: Future PFA: The Rebuild Project is eligible for PFA, but due to volume of City public art projects, the PFA planning activities for this project will not start within the current calendar year. Projects in this category will commence as soon as the PFA schedule allows.

Category 3: Pool Funds Due to Inappropriate Timeline: The Rebuild Project is eligible for PFA, but the construction timeline is determined to be inappropriate for a public art project due to construction already being complete or nearing completion at the time of PFA determination. As such, the PFA funds will be pooled and applied to another Rebuild PFA project (per PFA Guidelines Section IV-F), within the same City Council district.

Rebuild Percent for Art Strategy

7/9/2024



Category 4: Conservation of Existing PFA: The Rebuild Project is eligible for PFA, but the site already has an existing PFA artwork in need of conservation. Where appropriate, the Rebuild PFA funds for that project will be applied to the conservation of the existing PFA artwork on site (per PFA Guidelines Section XII-B). If PFA project funds remain, they will be applied to another Rebuild PFA project within the same City Council district.

Category 5: To Be Determined (TBD) PFA Project: Rebuild has not started the capital project and the scope of the Rebuild capital project has not been determined. This may become a Future PFA project (Category 2) upon determination of scope.

Category 6: Ineligible for PFA: The Rebuild Project is ineligible for PFA either due to construction cost being under \$1M, or the nature of construction is mostly repair or building systems upgrades (per PFA Guidelines Section III-L).

OACCE will work with Rebuild to communicate the anticipated PFA determination and category to the Philadelphia Art Commission on a per project basis when the renovation/ construction project is submitted for Art Commission Review. OACCE may provide a letter to communicate the Percent for Art intent to the Art Commission. At the appropriate time, OACCE will initiate a future and separate Art Commission review process for approving the artwork separate from the Rebuild construction project.
